

YORKSHIRE DOWNS  
CONDOMINIUM  
UNIT DIMENSION PLAN



SCALE AS SHOWN

SHEET 3 OF 3

NOTE:  
SECTIONAL VIEWS OF UNITS AND ALL UNIT DIMENSIONS WERE OBTAINED FROM THE ARCHITECTURAL PLANS OF RICHARD LEE GRIMSTEAD, A REGISTERED ARCHITECT WITH THE COMMONWEALTH OF VIRGINIA.

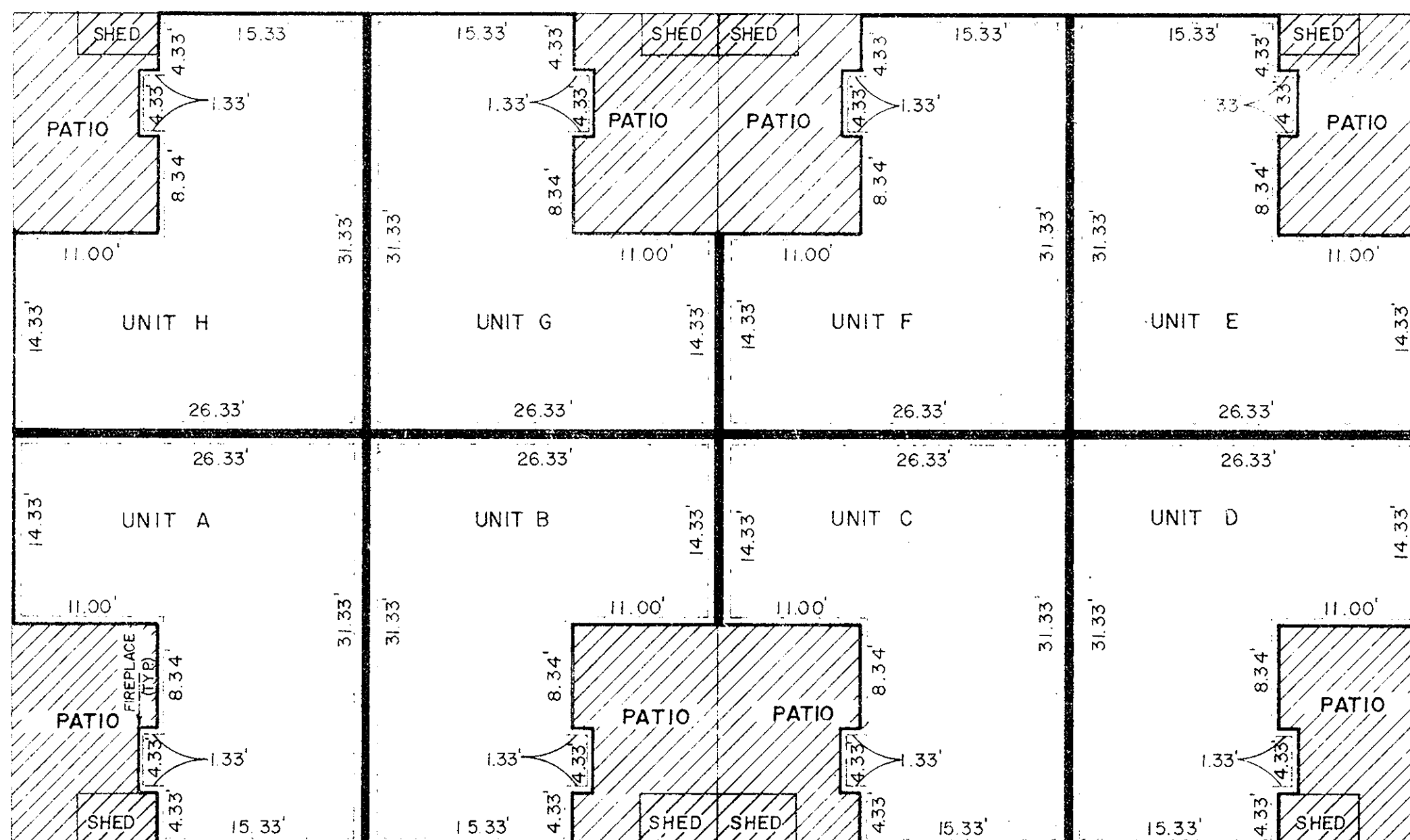

TYPICAL UNIT PLAN  
SCALE: 1" = 10'

NOTE:  
ALL UNITS ARE SAME UNIT TYPE AND DIMENSIONS

LIMITED COMMON ELEMENT

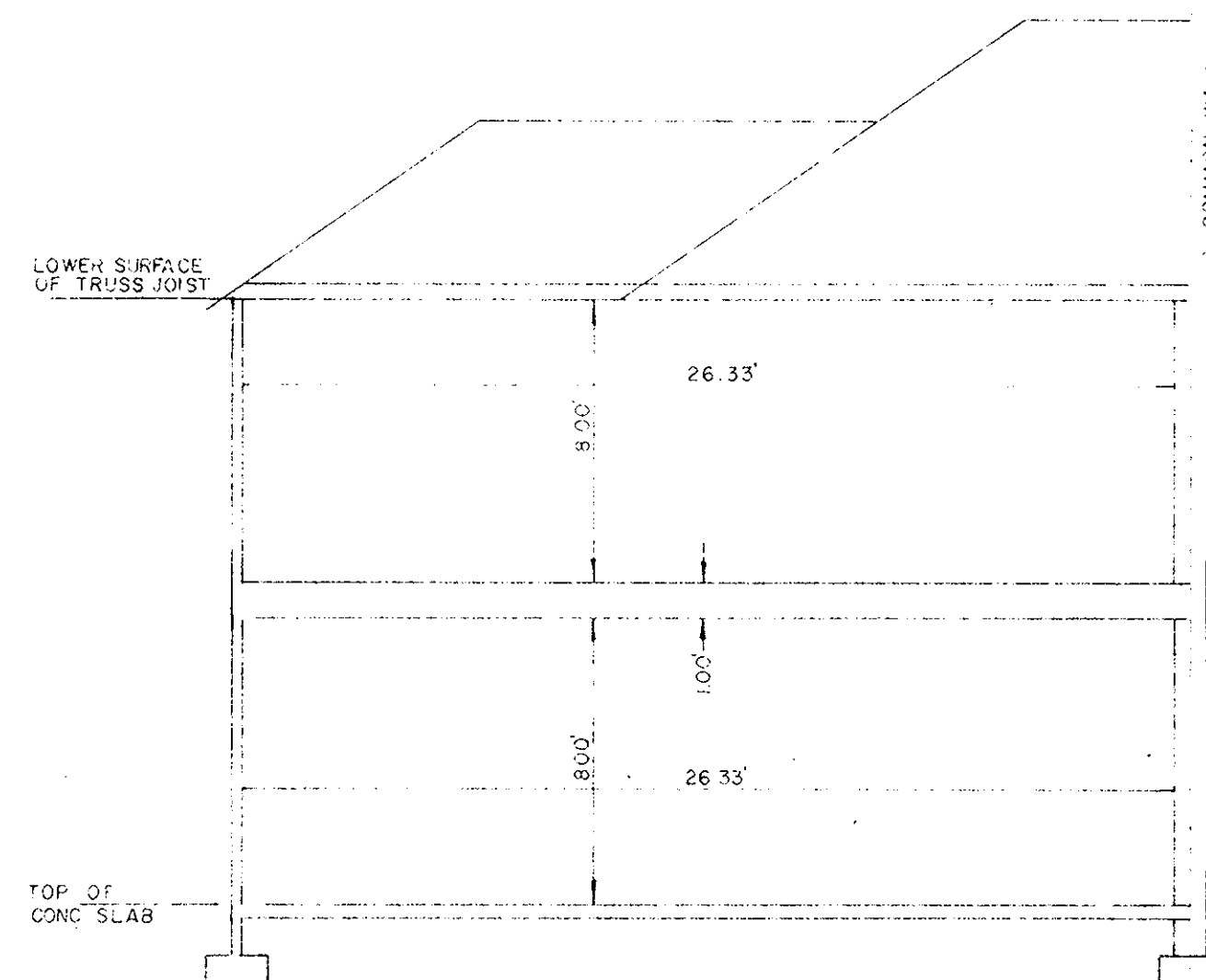

TYPICAL SECTION  
SCALE: 1" = 5'

plat Book No. 11 Page 1-B

Filed in the Clerk's Office, Circuit Court, York Co., VA  
the 5<sup>th</sup> day of January 1989

Edith M. Elliot, Clerk  
Carol Draselnick, D.C.  
12/26 P.M.

I, T. A. MANNING, III, A DULY REGISTERED ENGINEER, DO HEREBY CERTIFY THAT THIS DRAWING IS ACCURATE (WITHIN NORMAL TOLERANCES) AND COMPLIES WITH SECTION 55-79.58(b) OF THE CONDOMINIUM ACT AND THAT THE UNITS SHOWN HEREON ARE FULLY COMPLETED IN ACCORDANCE HEREWITH.

THOMAS A. MANNING, III  
REG. NO. 21094  
Virginia Registration  
PROFESSIONAL ENGINEER  
IN  
CIVIL ENGINEERING

DATE 12/20/88

PROJECT NO 872217  
FILE NO 872217