

Plot Book No. 11 Page 194

YORKSHIRE DOWNS
CONDOMINIUM
UNIT DIMENSION PLAN



SCALE: AS SHOWN

SHEET 3 OF 3

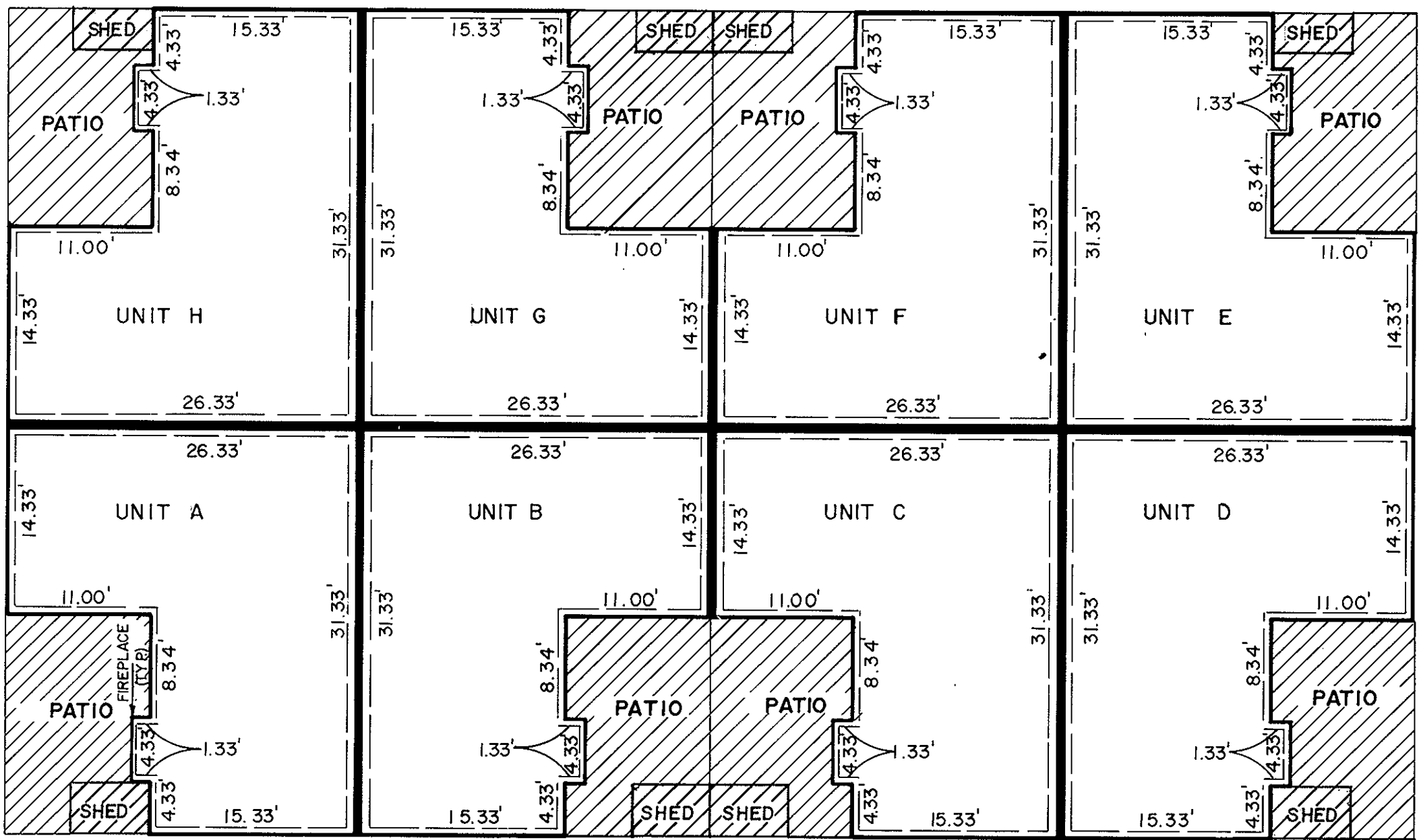

TYPICAL UNIT PLAN
SCALE: 1" = 10'

NOTE:
SECTIONAL VIEWS OF UNITS AND ALL UNIT DIMENSIONS WERE OBTAINED FROM THE ARCHITECTURAL PLANS OF RICHARD LEE GRIMSTEAD, A REGISTERED ARCHITECT WITH THE COMMONWEALTH OF VIRGINIA.

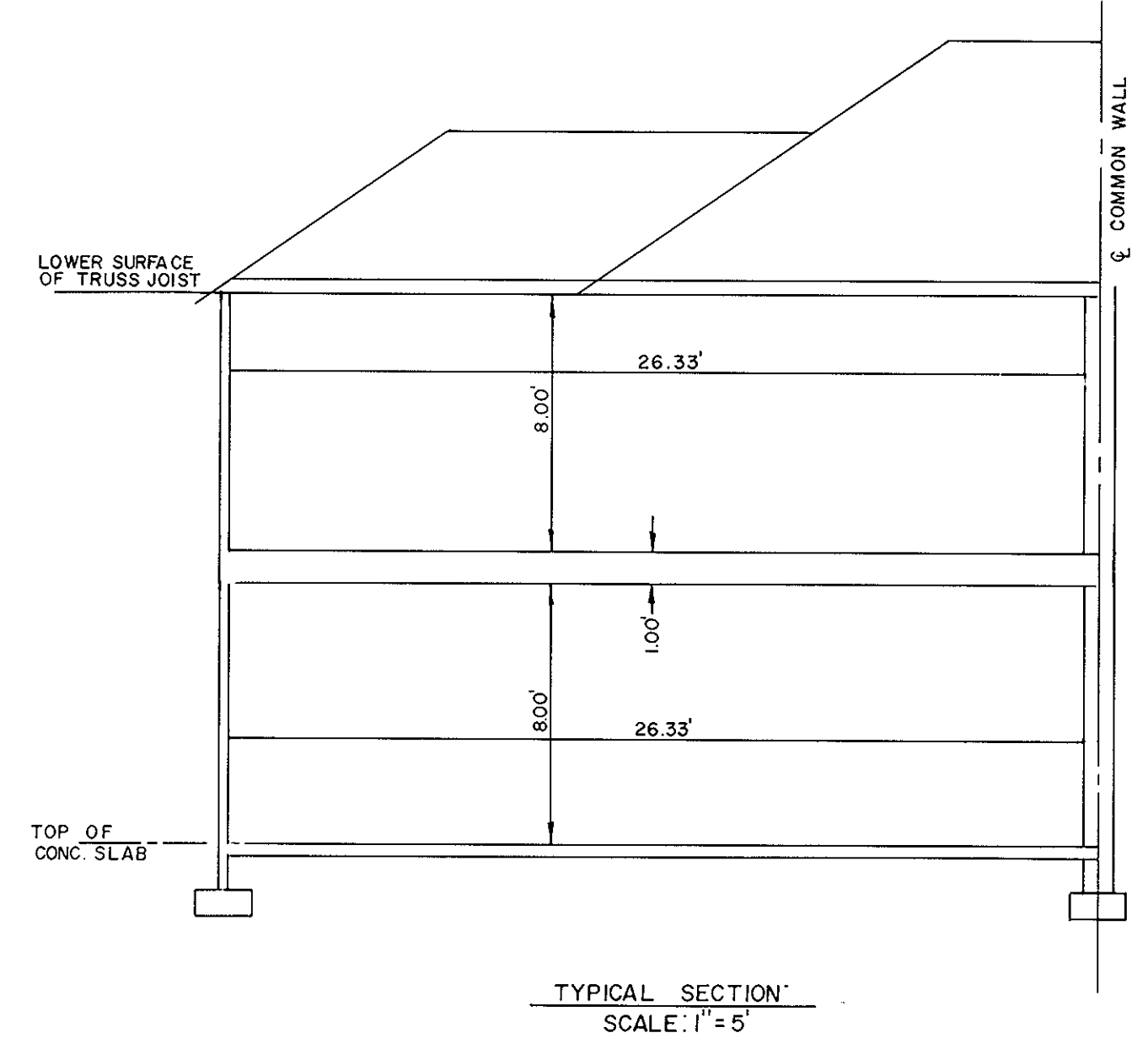

TYPICAL SECTION
SCALE: 1" = 5'

20th July 89
Thomas S. Berryman

NOTE:
ALL UNITS ARE SAME UNIT TYPE AND DEMISIONS.

LIMITED COMMON ELEMENT

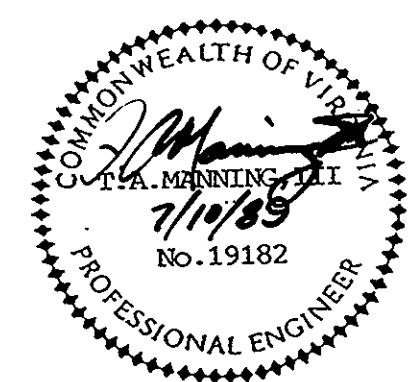

I, T. A. MANNING, III, A DULY REGISTERED ENGINEER, DO HEREBY CERTIFY THAT THIS DRAWING IS ACCURATE (WITHIN NORMAL TOLERANCES) AND COMPLIES WITH SECTION 55-79.58(b) OF THE CONDOMINIUM ACT AND THAT THE UNITS SHOWN HEREON ARE SUBSTANTIALLY COMPLETED IN ACCORDANCE HEREWITH.

, DATE 7/10/89

PROJECT NO: 872217
FILE NO: 872217