

SUBDIVISION PLAT OF SKIMINO LANDING ESTATES PHASE II-A

BRUTON DISTRICT
COUNTY OF YORK, VIRGINIA
DATE: OCTOBER 13, 1998



Committed to Excellence

ENGINEERS • ARCHITECTS • SURVEYORS

1006 RICHMOND ROAD, P.O. BOX 3505 WILLIAMSBURG, VIRGINIA 23187
(757)253-0673 FAX: (757)253-2319 E-MAIL: djginc@vsnl.net
NORFOLK - VIRGINIA BEACH AREA (757)874-5015

SHEET 2 OF 4

JOB NO. 1941120

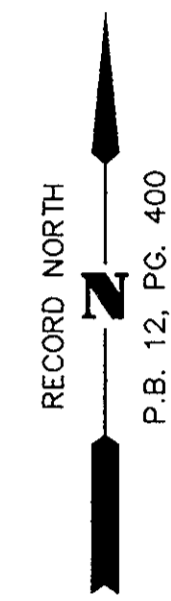
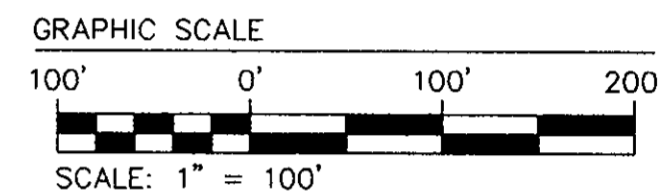
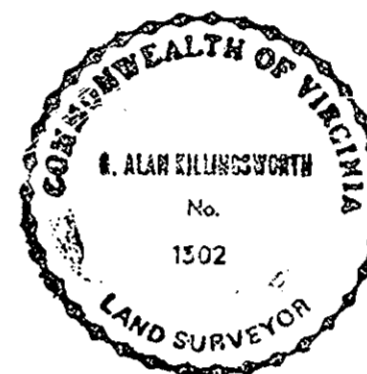

EASEMENT LINE DATA TABLE

NUMBER	DIRECTION	DISTANCE
*T1	N 32°42'39" E	177.22'
*T2	S 23°23'57" E	85.17'
*T3	S 62°43'51" E	70.72'
*T4	N 86°39'27" E	35.77'
*T5	N 27°46'19" W	43.53'
*T6	N 52°30'12" E	22.52'
*T7	S 04°55'35" E	9.85'
*T8	S 04°57'38" E	56.37'
*T9	S 37°26'41" E	115.41'
*T10	S 25°27'50" W	126.89'
*T11	S 04°57'38" E	57.67'
*T12	S 66°16'34" E	71.09'
*T13	S 24°46'18" W	125.76'
*T39	N 48°07'50" E	55.90'
*T45	N 75°42'06" W	125.37'
*T46	N 52°58'21" W	104.70'
*T47	N 86°39'27" E	37.12'

APPROVED
YORK COUNTY BOARD OF SUPERVISORS

BY: John T. Blum, PE
PLAT APPROVING AGENT

DATE: 11-23-98

STATE OF VIRGINIA
COUNTY OF YORK

IN THE CLERK'S OFFICE OF THE CIRCUIT COURT FOR THE COUNTY OF YORK THE 23rd DAY OF Nov. 1998 THIS MAP WAS PRESENTED AND ADMITTED TO RECORD AS THE LAW DIRECTS IN PLAT BOOK 122 PAGE 647.

TESTE: Nancy B. Kane
CLERK

BY: Cool D. Crossman, Deputy Clerk

