

* 50' R/W R/W appurtenant property owners but subject to the right of T.W. DANA & George S. Downey or assigns to dedicate the same as a public Street.

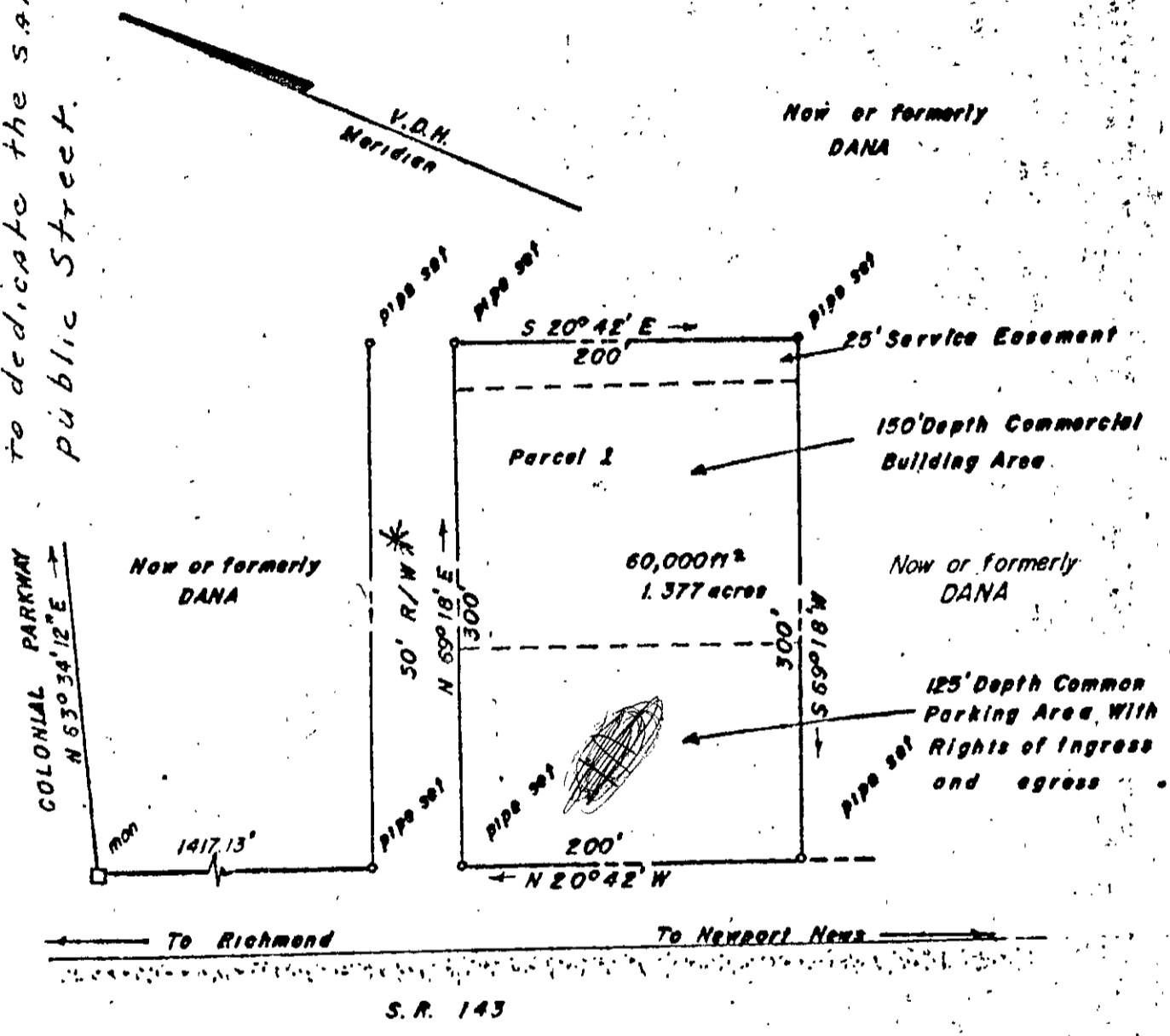

10(5) 1A

April '68 (MARTIN CLIFFORD + ASSOC.)

PLAT
SHOWING PROPERTY
TO BE CONVEYED
from

T. W. DANA, et. ux, et. als

REALTY CO