

CARTER CREEK ROAD 30' R/W

10' RESERVED FOR FUTURE WIDENING

N 84°-51'-30" E 197.49'

I.P. FOUND

I.P. FOUND

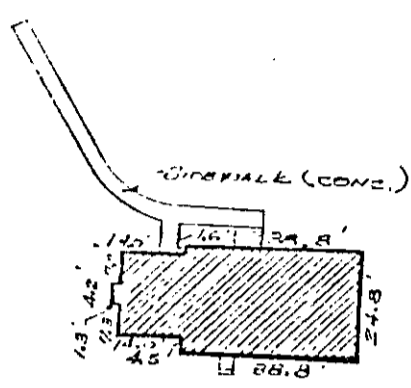

1 STORY BRICK HOUSE W/ CRAWL SPACE



SHED FRAME

GARAGE FRAME

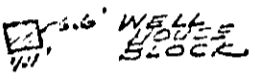

WELL HOUSE BLOCK

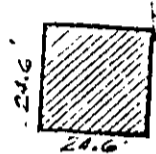

N 00°-19'-00" W 426.81

S 02°-07'-40" W 425.52

40' PRIVATE EASEMENT
John. Bozarth & Arthur Jasper

James Allen Estate

Flay Phillips Estate

D.B 142 Pg 199
CONTAINING 1.857 A9

N 84°-51'-30" W 81.05'

714'±
75'±
ST 604

PLANNED SURVEY
PROPERTY OF
WAY PHILLIPS
YORK COUNTY, VIRGINIA
AUGUST, 1976
H.E.