

DATE OF APPLICATION  
DATE OF ASSIGNMENT  
COUNTY RECORDED IN  
BOOK PAGE  
FOR OFFICE USE  
PLAT NO.  
MAP NO. 235  
FILE NO.

COMMONWEALTH OF VIRGINIA  
COMMISSION OF FISHERIES

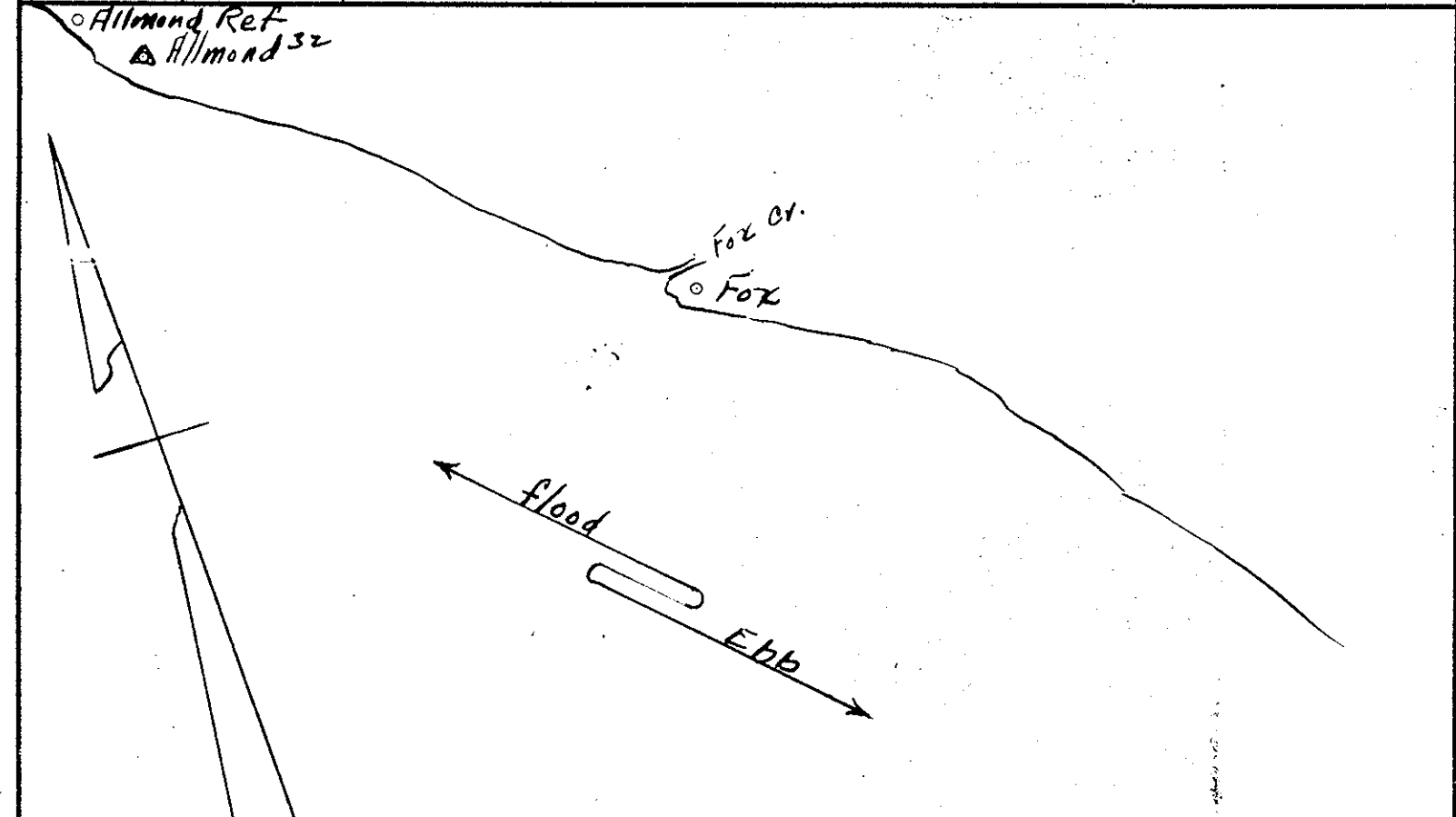

Allmond Ref  
Fox  
360°00' Ferry  
11°00' 1  
10°58' 2  
359°19' 3  
357°40' 4  
104°47'  
314°56'  
265°34'

gable tinnyford O. hse tank  
5 cor far paper hut  
220°33' 5 ga ble Mrs May Allmond  
262°21' large tree 15 strides

OYSTER PLANTING GROUND  
OF  
J.W. Williams  
IN  
York River  
District No. 15 York COUNTY  
May 13 1952  
Scale 10000  
Surveyed by J.K. Sinclair C.S. 495  
11-65

DATE OF APPLICATION  
DATE OF ASSIGNMENT  
COUNTY RECORDED IN  
BOOK PAGE  
FOR OFFICE USE  
PLAT NO.  
MAP NO.  
FILE NO.

COMMONWEALTH OF VIRGINIA  
COMMISSION OF FISHERIES

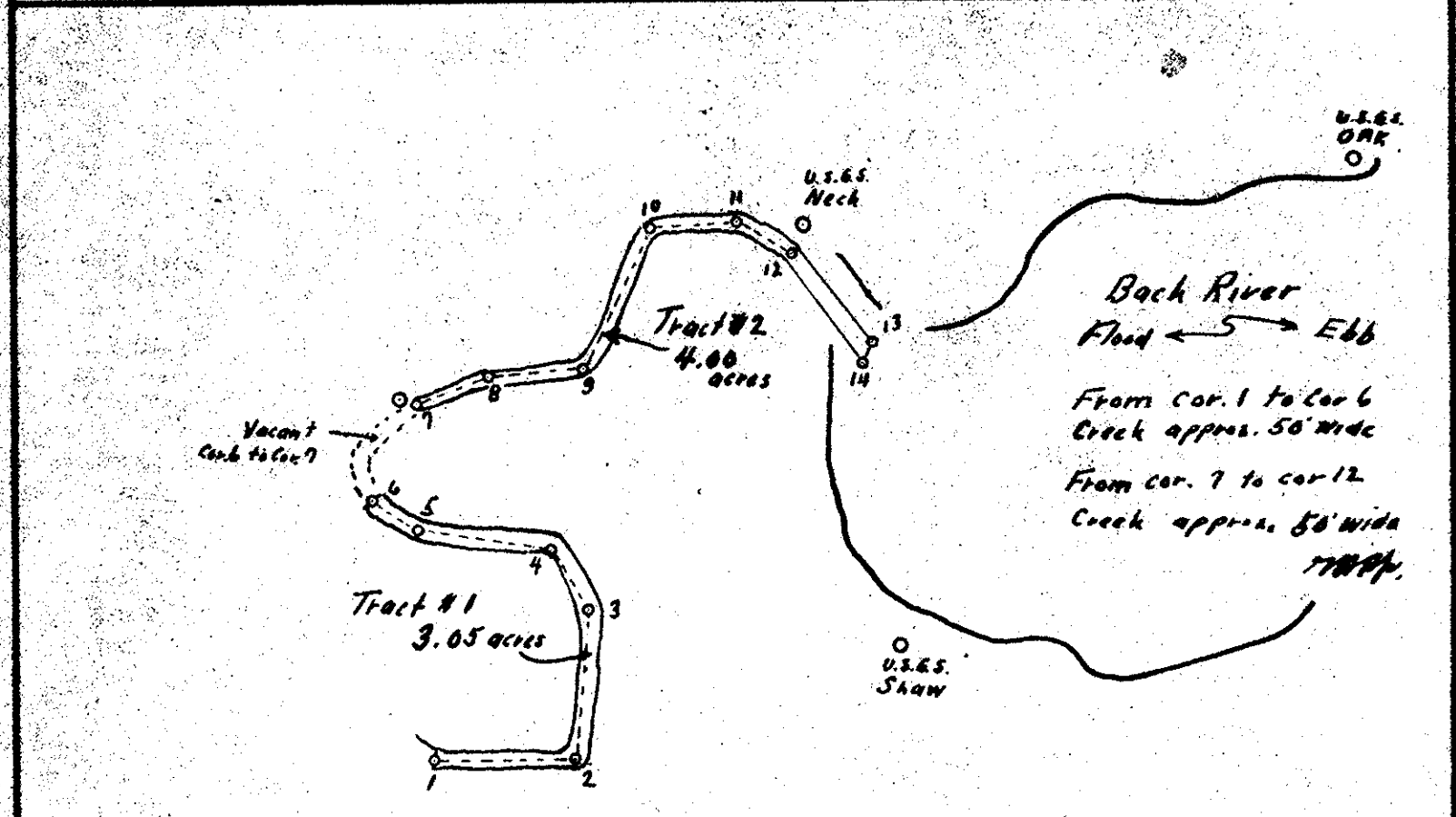

	(U.S. 65. 1932)	(U.S. 65. 1934)	LANDING
0	360° 00'	360° 00'	0° 50'
1	31° 12'	31° 12'	49° 12'
2	164° 11'	309° 32'	---
3	135° 01'	---	108° 11'
4	120° 04'	---	87° 35'
5	135° 17'	289° 01'	73° 00'
6	134° 57'	291° 18'	68° 00'
7	143° 45'	---	106° 29'
8	154° 59'	---	128° 26'
9	162° 10'	309° 25'	45° 11'
10	161° 20'	316° 19'	9° 03'
11	154° 34'	324° 05'	13° 55'
12	186° 08'	342° 00'	---
13	192° 10'	352° 48'	35° 30'
14	197° 51'	357° 26'	2° 26'
15	170° 19'	370° 19'	15° 21'
16	73° 39'	5° 25'	15° 41'
17	75° 34'	---	40° 30'
18	47° 12'	N. cor.	---
19	82° 11'	170° 38'	25° 57'
(High)	103° 55'	---	---
Work	239° 30'	---	---

U.S. 65 Neck  
U.S. 65 ORK  
U.S. 65 SAAN

Back River  
Flood ← Ebb  
From cor. 1 to cor. 6  
Creek approx. 50' wide  
From cor. 7 to cor. 12  
Creek approx. 50' wide

Vacant Cor. 6 to Cor. 7

Fox Hill Tank  
Langley Field Tank  
Big. by Langley field near  
N.W. Cor. Tind Tunnel Langley  
Langley, M. Smith hse. (high)

OYSTER PLANTING GROUND  
OF  
Kathleen B. Baker and Roy Baker  
IN  
Back River - by the creek  
District No. 16 and 17 York and Gloucester COUNTY  
Scale 10000  
Surveyed by Geo. H. Badger Jr.  
CERTIFIED SURVEYOR

DATE OF APPLICATION  
DATE OF ASSIGNMENT  
COUNTY RECORDED IN  
BOOK PAGE  
FOR OFFICE USE  
PLAT NO.  
MAP NO. 241  
FILE NO.

COMMONWEALTH OF VIRGINIA  
COMMISSION OF FISHERIES

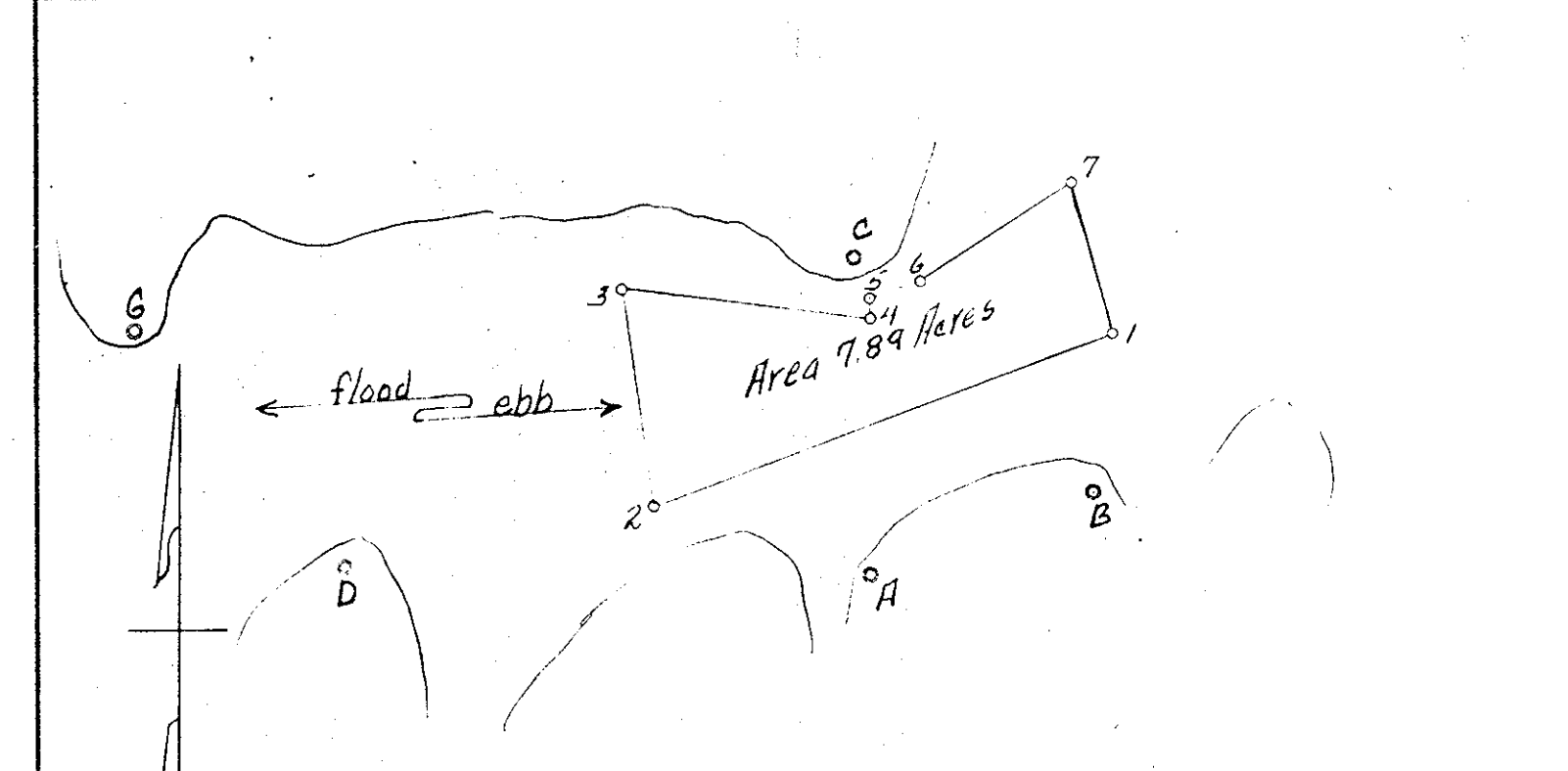

A	B	C
360°00'	B	126°47'
286°57'	A	360°00'
335°18'	C	57°51'
218°22'	1	168°35'
316°53'	2	21°37'

See Plat File 3119

A	B	C	D
360°00'	B	360°00'	360°00'
250°11'	A	88°00'	86°06'
360°00'	C	86°21'	86°06'
57°2'	A	360°00'	353°27'
4	2°41'	344°13'	340°56'
5	2°35'	---	---

52 taken for Newbern  
24 Mrs white  
76 Acres out of  
8.65  
7.6  
7.89 New acreage

OYSTER PLANTING GROUND  
OF  
John Smith, Jr  
IN  
Cheesemans Creek  
District No. 15 York COUNTY  
April 17 1952  
Scale 5000  
Map Surveyed by J.K. Sinclair C.S. 495  
CERTIFIED SURVEYOR