

Plat Book No. 5 Page 216

FOR OFFICE USE
PLAT NO.
MAP NO. 248
FILE NO.

DATE OF APPLICATION
DATE OF ASSIGNMENT
COUNTY RECORDED IN
BOOK PAGE
NO.

COMMONWEALTH OF VIRGINIA
COMMISSION OF FISHERIES

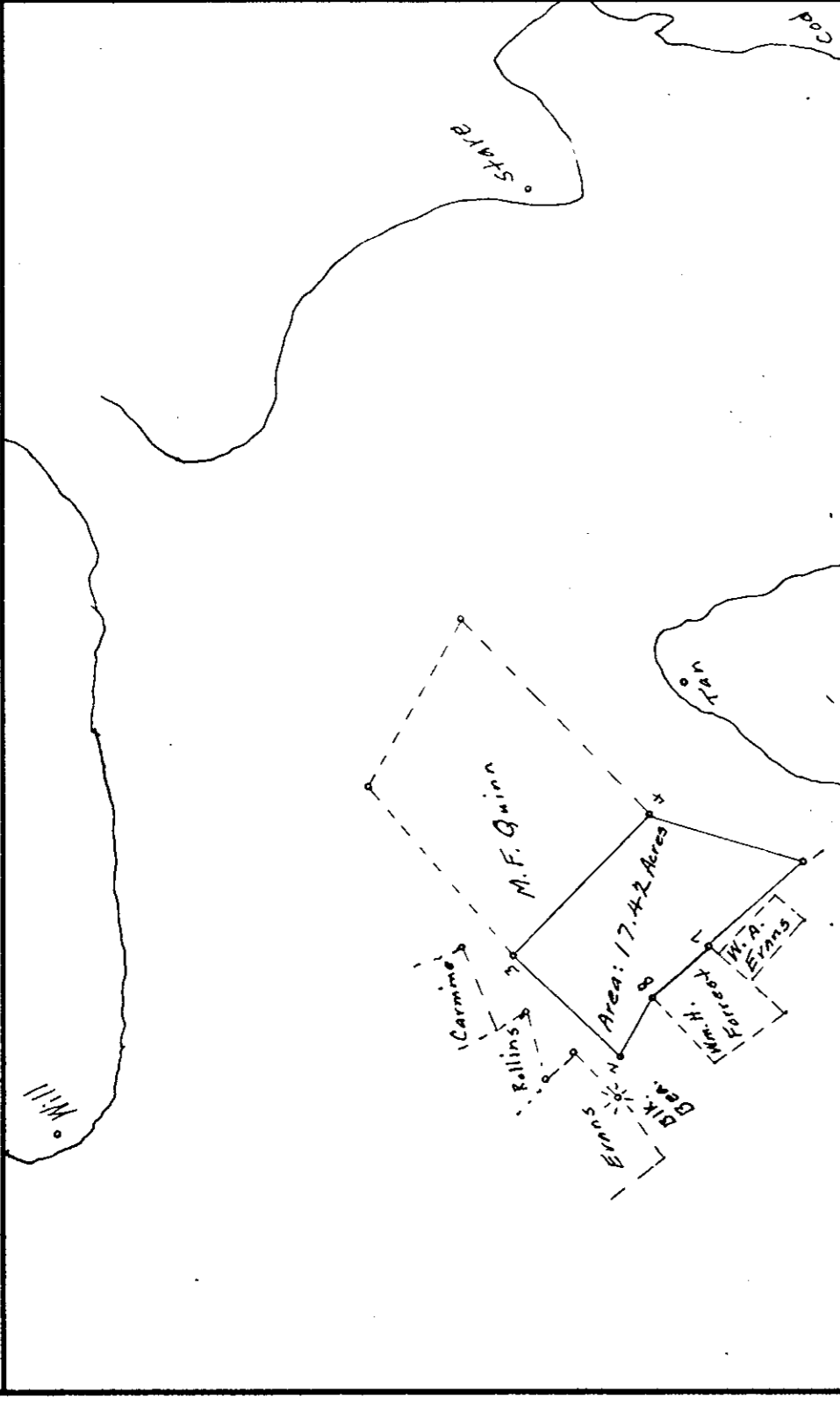

Stake	360°00'	Mill	Tarn
Ced	360°00'	267°36'	360°00'
Tan	360°00'	283°27'	272°27'
1	107°14'	293°36'	315°45'
2	114°13'	280°54'	338°06'
3	102°28'	274°05'	321°57'
4	122°43'	318°53'	318°53'
H.O. Tank	172°48'	135°10'30"	25°12'
"	253°057'	216°12'	263°11'
M.B. Rollins	84°24'	45°40'	Amery Clem. Hsc.
"	"	"	Payton Smith
M.G. Evans	"	"	Foundation Wind Tunnel
Stake	360°00'	Mill	Tarn
Mill	360°00'	360°00'	360°00'
7	44°00'	281°52'	347°38'
8	40°38'	293°24'	359°03'
E.O.	103°24'	307°06'	Diggs Hsc. Massia
M.M. Car.	338°19'	73°01'	Seymour Tunnel
H.O. Tank	310°34'	106°57'	Langley Feaw
"	"	"	8°21'
S. B. 616	"	"	312°48'

Note: This survey includes and takes place of 10.76 Acres in A. F. Quinn's name, and 2.82 Acres in M. F. Quinn's name.

Area: 17.42 Acres

OYSTER PLANTING GROUND OF A. F. QUINN IN Back River潭 Pt. District No. 17 York County Scale 10,000

Surveyed by Charles D. Rollins DISTRICT SURVEYOR Dist. 17-45

Recorded Feb. 10, 1956
M.D. Bryant, Clerk
C.M.S.

Plat Book No. 5 Page 216

FOR OFFICE USE
PLAT NO.
MAP NO. 248
FILE NO.

DATE OF APPLICATION
DATE OF ASSIGNMENT
COUNTY RECORDED IN
BOOK PAGE
NO.

COMMONWEALTH OF VIRGINIA
COMMISSION OF FISHERIES

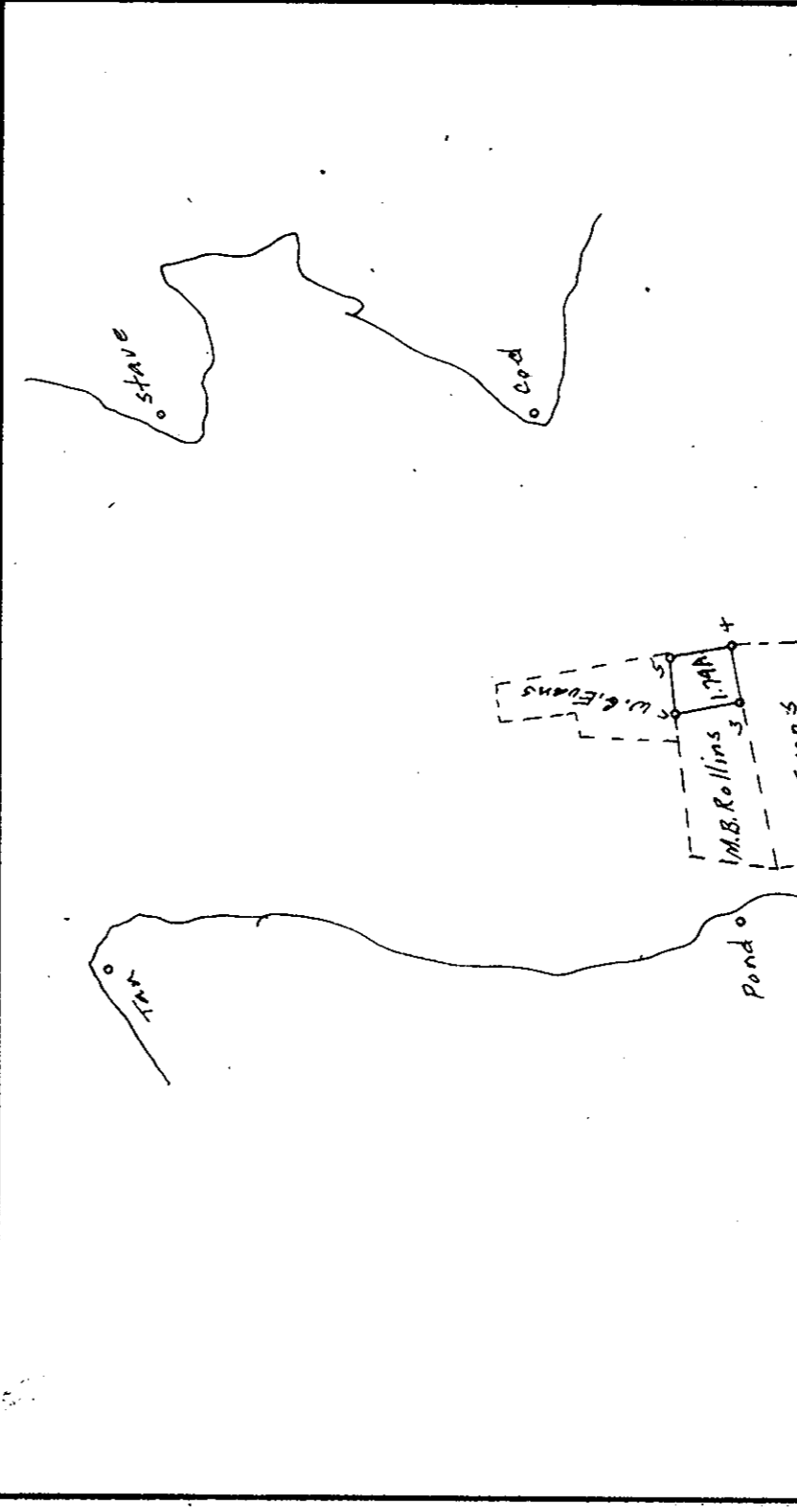

Ced	Stake
Stake	360°00'
Ced	360°00'
Tan	360°00'
3	235°18'
4	227°54'
5	241°38'
6	245°08'
H.O. Tank	354°07'
"	82°02'

Note: This survey includes and takes place of 2.83 Acres (No. 140 in My. No. 248) survey to affect transfer to R. W. Holloway.

Area: 17.9 Acres

OYSTER PLANTING GROUND OF M. B. ROLLINS IN Back River潭 Pt. District No. 17 York County Scale 10,000

Surveyed by Charles D. Rollins DISTRICT SURVEYOR Dist. 17-47

Recorded Feb. 10, 1956
M.D. Bryant, Clerk
C.M.S.

Plat Book No. 5 Page 216

FOR OFFICE USE
PLAT NO.
MAP NO. 248
FILE NO.

DATE OF APPLICATION
DATE OF ASSIGNMENT
COUNTY RECORDED IN
BOOK PAGE
NO.

COMMONWEALTH OF VIRGINIA
COMMISSION OF FISHERIES

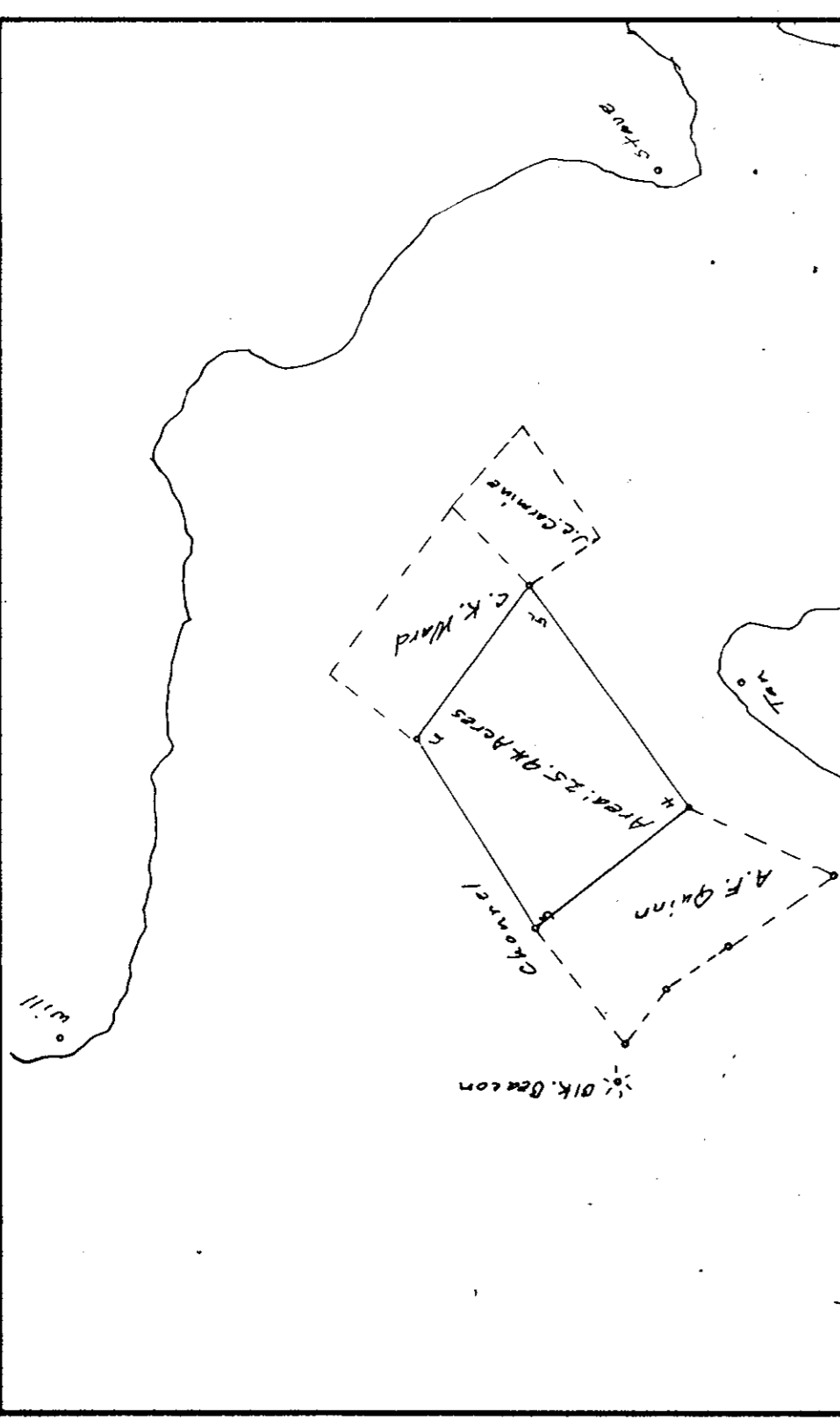

Stake	Mill	Tarn
Ced	360°00'	267°36'
Tan	360°00'	283°27'
3	114°13'	280°54'
4	102°28'	274°05'
5	122°43'	318°53'
6	128°30'	321°57'
H.O. Tank	172°48'	318°53'
"	253°057'	216°12'
M.B. Rollins	84°24'	45°40'
"	"	"
M.G. Evans	"	"

Note: This survey includes and takes place of 9.70 Acres and 3.15 Acres in M. F. Quinn's name.

Area: 25.94 Acres

OYSTER PLANTING GROUND OF M. F. QUINN IN Back River潭 Pt. District No. 17 York County Scale 10,000

Surveyed by Charles D. Rollins DISTRICT SURVEYOR Dist. 17-45

Recorded Feb. 10, 1956
M.D. Bryant, Clerk
C.M.S.

Plat Book No. 5 Page 216

FOR OFFICE USE
PLAT NO.
MAP NO. 248
FILE NO.

DATE OF APPLICATION
DATE OF ASSIGNMENT
COUNTY RECORDED IN
BOOK PAGE
NO.

COMMONWEALTH OF VIRGINIA
COMMISSION OF FISHERIES

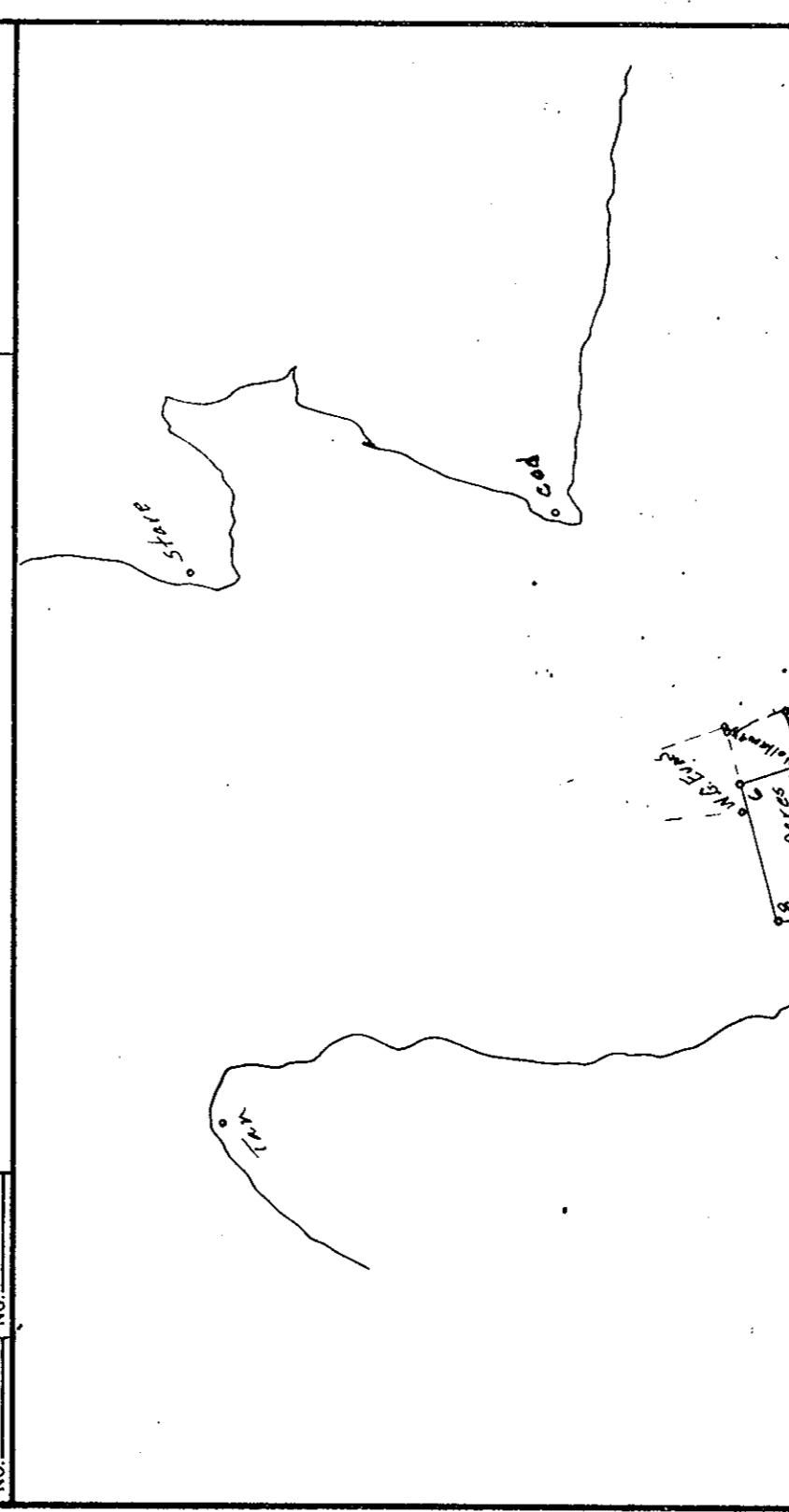

Ced	Stake
Stake	360°00'
Ced	360°00'
3	235°18'
4	241°38'
5	245°08'
6	257°12'
H.O. Tank	354°07'
"	82°02'
Tan	360°00'
Jump	360°00'
Watts	360°00'
H.O. Tank	90°07'
"	285°04'

Note: This survey includes and takes place of 5.60 Acres (No. 140 in My. No. 248) survey to affect transfer to R. W. Holloway.

Area: 5.60 Acres

OYSTER PLANTING GROUND OF M. B. ROLLINS IN Back River潭 Pt. District No. 17 York County Scale 10,000

Surveyed by Charles D. Rollins DISTRICT SURVEYOR Dist. 17-47

Recorded Feb. 10, 1956
M.D. Bryant, Clerk
C.M.S.

Plat Book No. 5 Page 216

FOR OFFICE USE
PLAT NO.
MAP NO. 248
FILE NO.

DATE OF APPLICATION
DATE OF ASSIGNMENT
COUNTY RECORDED IN
BOOK PAGE
NO.

COMMONWEALTH OF VIRGINIA
COMMISSION OF FISHERIES