

DATE OF APPLICATION FOR OFFICE USE
 DATE OF ASSIGNMENT PLAT NO.
 COUNTY RECORDED IN MAP NO. Lloyd Bay
 BOOK PAGE FILE NO.

COMMONWEALTH OF VIRGINIA
 COMMISSION OF FISHERIES

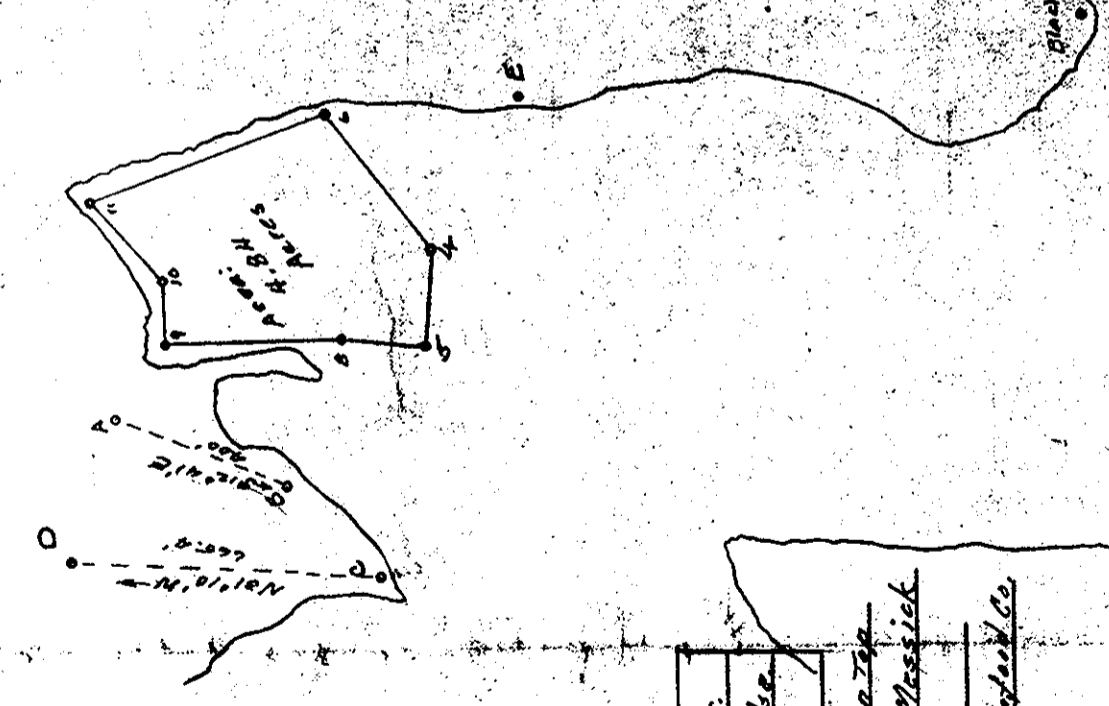

Area	Dimensions	Notes
A	360' x 20'	
B	300' x 10'	
C	300' x 10'	
D	300' x 10'	
E	300' x 10'	
F	300' x 10'	
G	300' x 10'	
H	300' x 10'	
I	300' x 10'	
J	300' x 10'	
K	300' x 10'	
L	300' x 10'	
M	300' x 10'	
N	300' x 10'	
O	300' x 10'	
P	300' x 10'	
Q	300' x 10'	
R	300' x 10'	
S	300' x 10'	
T	300' x 10'	
U	300' x 10'	
V	300' x 10'	
W	300' x 10'	
X	300' x 10'	
Y	300' x 10'	
Z	300' x 10'	

Plat Book No. 5 Page 218

OYSTER PLANTING GROUND

Area: 4.84 Acres
 Robert A. ...
 District No. 5 York
 Surveyed by Charles J. ...

Jul. 14, 1956
 McBay's Club
 End

DATE OF APPLICATION FOR OFFICE USE
 DATE OF ASSIGNMENT PLAT NO.
 COUNTY RECORDED IN MAP NO. 241
 BOOK PAGE FILE NO.

COMMONWEALTH OF VIRGINIA
 COMMISSION OF FISHERIES

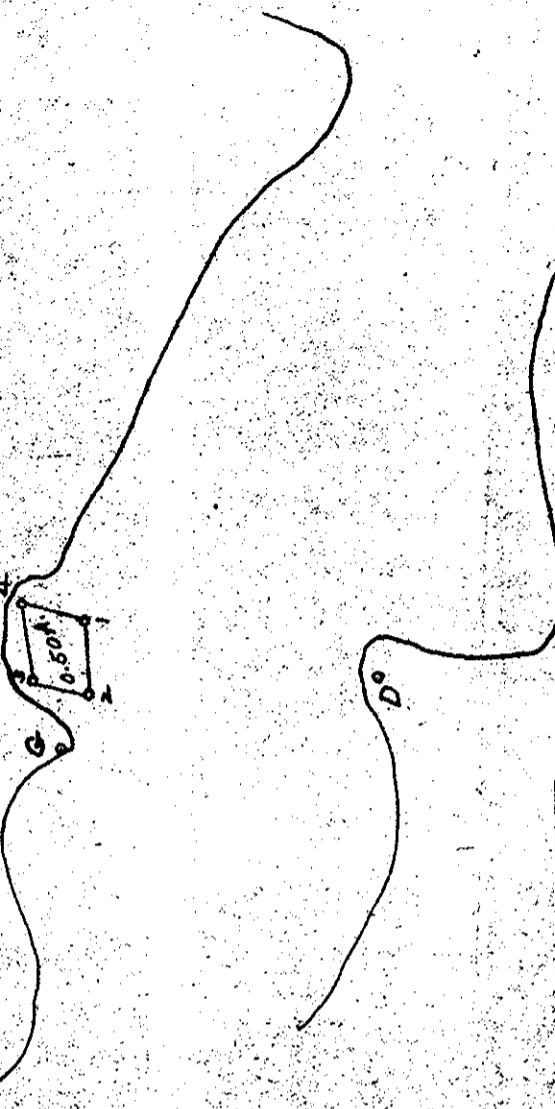

Area	Dimensions	Notes
A	300' x 10'	
B	300' x 10'	
C	300' x 10'	
D	300' x 10'	
E	300' x 10'	
F	300' x 10'	
G	300' x 10'	
H	300' x 10'	
I	300' x 10'	
J	300' x 10'	
K	300' x 10'	
L	300' x 10'	
M	300' x 10'	
N	300' x 10'	
O	300' x 10'	
P	300' x 10'	
Q	300' x 10'	
R	300' x 10'	
S	300' x 10'	
T	300' x 10'	
U	300' x 10'	
V	300' x 10'	
W	300' x 10'	
X	300' x 10'	
Y	300' x 10'	
Z	300' x 10'	

Plat Book No. 5 Page 218

OYSTER PLANTING GROUND

Area: 5.50 Acres
 Debra ...
 District No. 5 York
 Surveyed by Charles J. ...

Jul. 14, 1956
 McBay's Club
 End

DATE OF APPLICATION FOR OFFICE USE
 DATE OF ASSIGNMENT PLAT NO.
 COUNTY RECORDED IN MAP NO. 247
 BOOK PAGE FILE NO.

COMMONWEALTH OF VIRGINIA
 COMMISSION OF FISHERIES



Area	Dimensions	Notes
A	300' x 10'	
B	300' x 10'	
C	300' x 10'	
D	300' x 10'	
E	300' x 10'	
F	300' x 10'	
G	300' x 10'	
H	300' x 10'	
I	300' x 10'	
J	300' x 10'	
K	300' x 10'	
L	300' x 10'	
M	300' x 10'	
N	300' x 10'	
O	300' x 10'	
P	300' x 10'	
Q	300' x 10'	
R	300' x 10'	
S	300' x 10'	
T	300' x 10'	
U	300' x 10'	
V	300' x 10'	
W	300' x 10'	
X	300' x 10'	
Y	300' x 10'	
Z	300' x 10'	

Plat Book No. 5 Page 218

OYSTER PLANTING GROUND

Area: 4.62 Acres
 F. T. Hall
 District No. 5 York
 Surveyed by Charles J. ...

Jul. 14, 1956
 McBay's Club
 End