

Filed in the Clerk's Office the 31st day of Aug. 1961

Teste: MELVILLE I. BRYANT, Clerk
Edw. J. ... D. C.

Area: 9.348 Acres.
 LOT 21 = 1.280 "
 TOTAL 10.628 ACRES

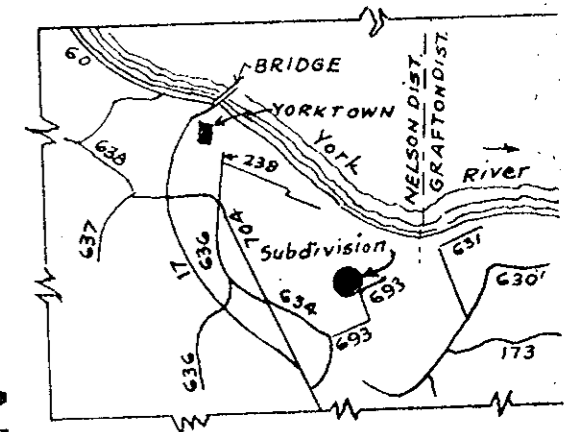

SUBDIVISION CERTIFICATE:
 The subdivision of land shown on this plat designated as a Portion of Section 1 Marlbank Farm, is with the free consent and in accordance with the desire of the undersigned owner. There is no mortgage on this property. The dedication of the streets within the limits of this subdivision are of the width and extent shown on this plan.
 Given under our hand and seal this 2nd day of March 1955.

Leslie R. O'Hara Owner.

ENGINEERS CERTIFICATE:
 To the best of my knowledge and belief all the requirements as set forth in the ordinance for approving plats of subdivisions for recordation in York County, Virginia have been complied with.

Melville Waddill
 Certified Surveyor.

STATE OF VIRGINIA:
 COUNTY OF YORK to-wit:
 I, *Melville Waddill*, a Notary Public in and for the County of York in the State of Virginia, do hereby certify that *Leslie R. O'Hara* whose name is signed to the above certificate has acknowledged the same before me in my office aforesaid.
 Given under my hand and seal this 2nd day of March 1955
 NOTARY PUBLIC
 My commission expires August 31, 1957

SOURCE OF TITLE:
 The property embraced within this subdivision was conveyed by Irene E. Mulcahy and Florence G. Mulcahy to Leslie R. O'Hara by deed dated April 12, 1945 and recorded in York County Deed Book 61 page 353.

Note: Lot corners, RCs and PTs marked by iron rods.

Plat Book No. 6 Page 138

MAP SHOWING A PORTION OF SECTION 1 SUBDIVISION OF MARLBANK FARM YORK COUNTY, VIRGINIA.

Scale 1"=100'
 Feb. 10th, 1955
 REVISED Aug. 7, 1958

J Temple Waddill
 Certified Civil Engineer
 Richmond, Va. NB 205 p2

