

NO.	DALTA	RAD.	TAN.	ARC	CHORD	CH. BEARING
1	13°54'40"	598.91'	73.06'	145.41'	145.05'	N 85°40'50"E
2	13°54'40"	648.91'	79.16'	157.55'	157.16'	N 85°40'50"E
3	30°40'30"	419.75'	115.12'	224.72'	222.05'	N 04°03'45"E
4	30°40'30"	369.75'	101.41'	197.96'	195.60'	N 04°03'45"E
5	90°00'00"	25.00'	25.00'	39.27'	35.36'	N 33°43'30"E
6	90°00'00"	25.00'	25.00'	39.27'	35.36'	N 56°16'30"W
7	48°00'00"	325.00'	144.70'	272.27'	264.34'	N 12°43'30"E
8	48°00'00"	275.00'	122.44'	230.38'	223.70'	N 12°43'30"E
9	120°00'00"	25.00'	43.30'	52.36'	43.30'	S 83°16'30"E
10	28°04'21"	25.00'	6.25'	12.25'	12.13'	S 22°41'20"W
11	28°04'21"	25.00'	6.25'	12.25'	12.13'	N 09°14'20"W
12	176°08'42"	60.00'		184.46'		
13	28°00'00"	180.00'	46.12'	90.41'	89.51'	N 09°16'30"W

# LAMB'S CREEK ESTATES

## YORK COUNTY VIRGINIA

COENEN & ASSOCIATES, ENGINEERS  
NEWPORT NEWS, VIRGINIA

SCALE: 1" = 100' JAN. 15, 1963

SHEET 2 OF 2

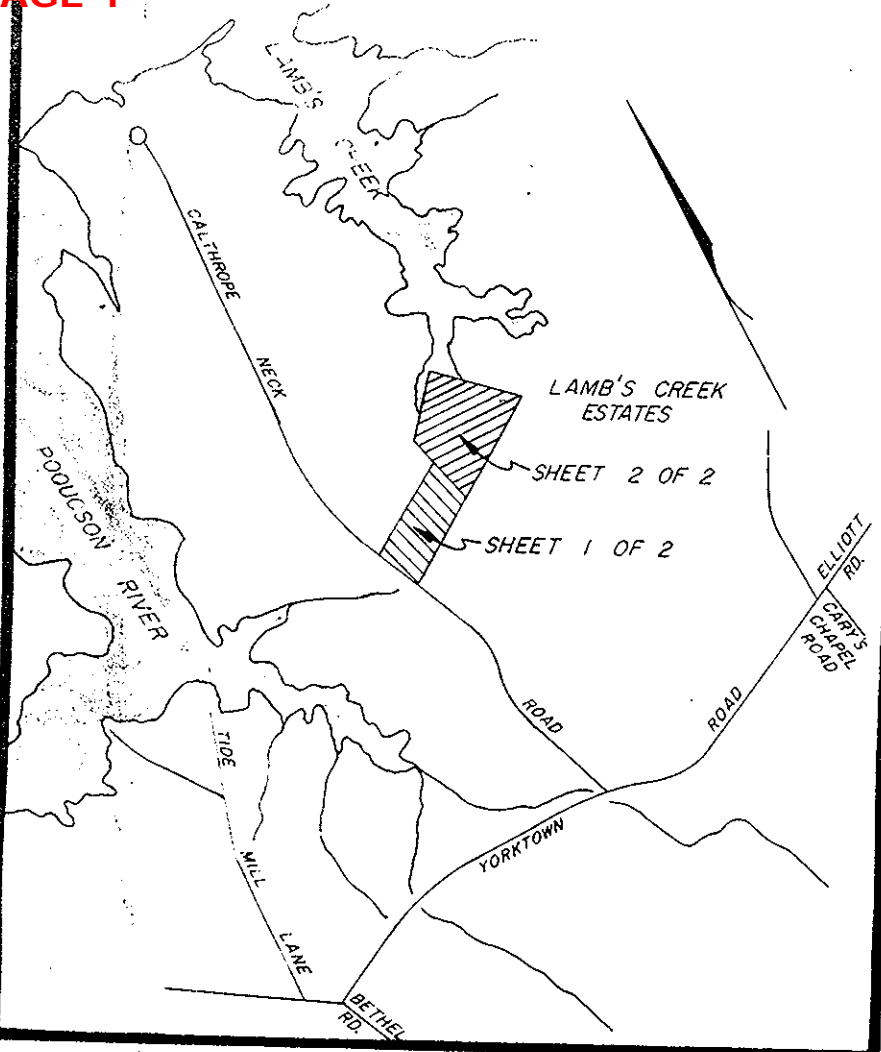

VICINITY MAP  
SCALE 1" = 2000'

NOW OR FORMERLY  
J.W. BUNTING

NO.	DALTA	RAD.	TAN.	ARC.	CHORD	CH. BEARING
14	28°00'00"	235.00'	58.59'	114.84'	113.70'	N 09°16'30"E
15	70°31'00"	25.00'	17.68'	30.77'	28.87'	S 66°00'38"E
16	250°31'44"	50.00'		218.62'		
17	70°31'44"	25.00'	17.68'	30.77'	28.87'	N 54°39'52"E
18	74°00'00"	25.00'	18.84'	32.29'	30.09'	N 41°43'30"E
19	106°00'00"	25.00'	33.18'	46.25'	39.93'	N 48°16'30"W

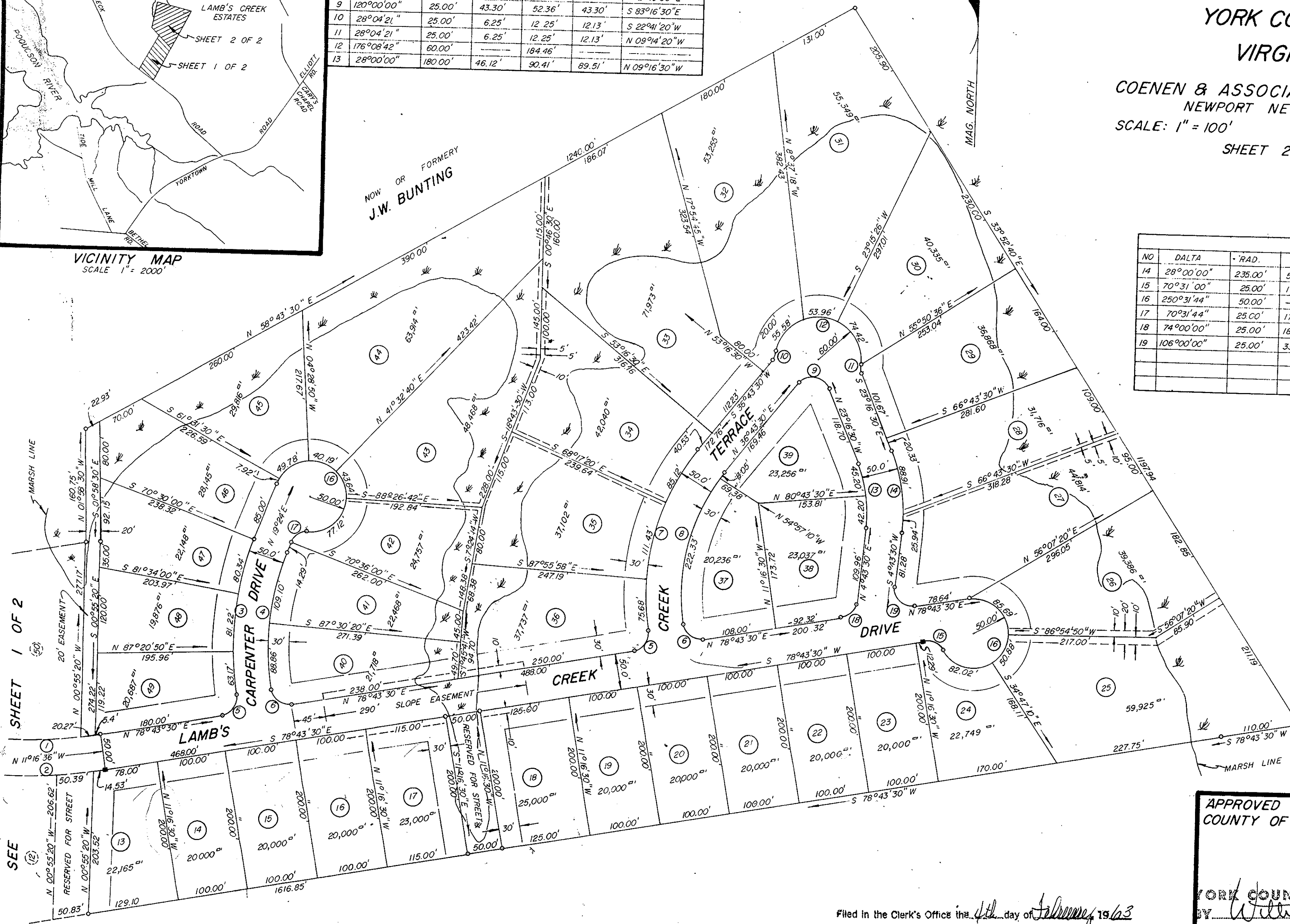

SHEET 1 OF 2

SEE

Filed in the Clerk's Office the 4th day of February 1963

Tests: MELVILLE I. BRYANT, Clerk  
Edith M. Wade D.C.

APPROVED  
COUNTY OF YORK, VA.

APPROVED  
YORK COUNTY BOARD OF SUPERVISORS  
BY William H. Schaffer  
PLAT APPROVING AGENT.  
DATE February 7, 1963  
VARIATIONS APPROVED  
DATE \_\_\_\_\_