

PLAT OF THE PROPERTY OF:
PENINSULA MOTOR COURTS, INC.
 TOWN OF POQUOSON - YORK COUNTY, VA.
John W. Lawson
 John W. Lawson: Certified Land Surveyor, N.H. Va.
 Scale: 1" = 100' Nov. 30, 1962

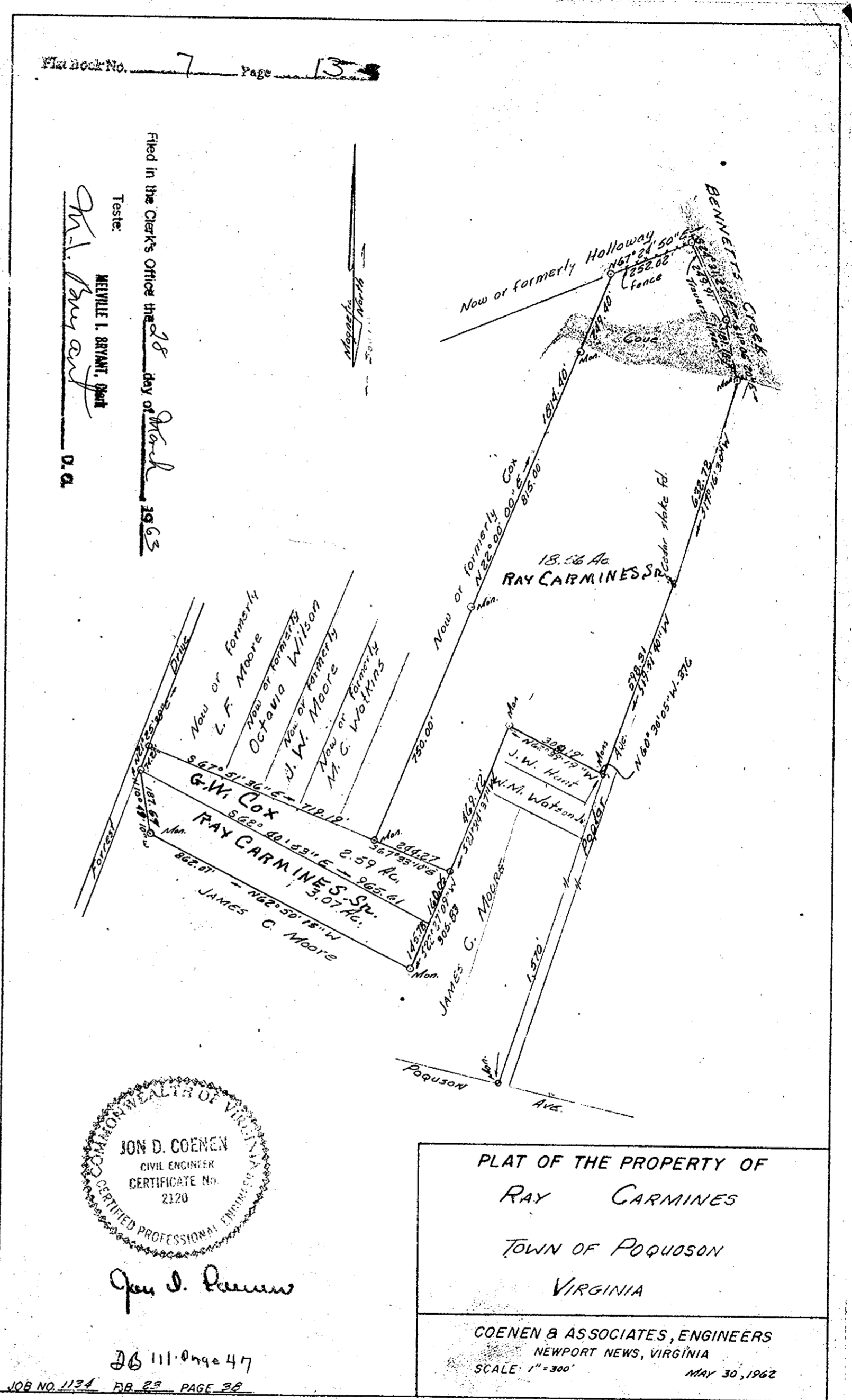

Filed in the Clerk's Office this 1st day of March, 1963
 Teste:
M. L. Bryant
 M. L. BRYANT, CLERK
 D. C.

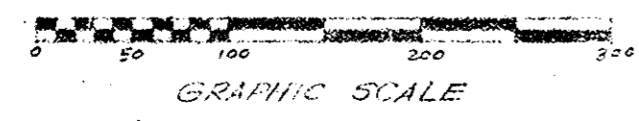
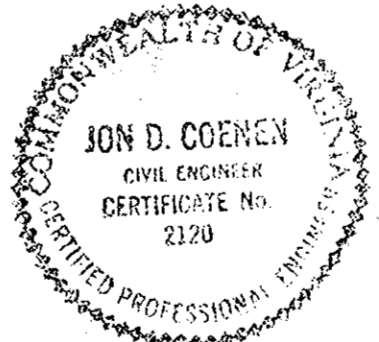

Jon D. Coenen

DB 111-0494 47

JOB NO. 1134 PB. 22 PAGE 22

PLAT OF THE PROPERTY OF
RAY CARMINES
 TOWN OF POQUOSON
 VIRGINIA

COENEN & ASSOCIATES, ENGINEERS
 NEWPORT NEWS, VIRGINIA
 SCALE: 1" = 300' MAY 30, 1962