

NOW OR FORMERLY
W. E. PHILLIPS
D.B. 200, PG. 768

POQUOSON AVENUE
50' R/W

5° 21' 00" E
84.71'

S 45° 00' 00" W
318.10'

574.65'

S 45° 00' 00" W
445.29'

463.71'

200.35'
N 45° 00' 00" W

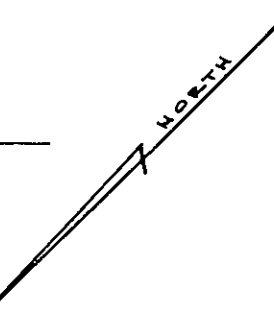

PARCEL - "A"

ADJUSTED
PARCEL - "B"

ADJUSTED
PARCEL - "C"

PARCEL - "D"

PARCEL - "E"

PARCEL - "F"
ROBERT L. & CAROLYN A. WILLIAMS

EXISTING 5' SANITARY
SEWER EASEMENT
EXISTING 2" P.V.C.
SANITARY SEWER
FORCE LINE

E. OF PROPOSED 2" P.V.C.
SANITARY SEWER LINE
IS E. OF 5' SANITARY SEWER
EASEMENT.

PROPOSED 675' 2" P.V.C. SCH. 40
LOCATED 1' OFF THE EDGE OF EXISTING
CRUSHED STONE DRIVEWAY

PROPOSED DWL
5' DIA. A PROP. LITE

PROP. 4" P.V.C.
SAN. SEWER
@ 1.0%

PROPOSED 2" P.V.C.
CHECK VALVES

EXIST. 18" R.A.P.

EXISTING 1" P.V.C. FORCE
GRINDER PUMP & WILLIAMS
RESIDENCE

HYDRA-MATIC P.D.G. SYMPLER SYSTEM
8" P.V.C. 200' 2" HP HYDRA-MATIC
GRINDER PUMP WITH 4 1/2" I.D.F.
HYDRA-MATIC STD. CONTROL PANEL
MOUNTED ON PROP. DWL OR ABOVE
PUMP TANK - CONTROL PANEL HIGH
WATER ALARM TO BE INSTALLED TO
HAVE BOTH AUDIBLE & VISUAL SIGNAL
(LIGHT & HORN OR LIGHT & BELL)
ONE EQUAL

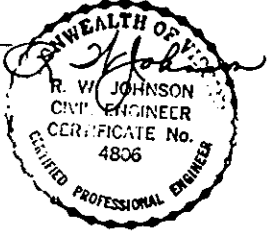

NOW OR FORMERLY
JAMES C. MOORE

REVISED: 9/4/87 TO SHOW 5' SANITARY
SEWER EASEMENT
DATE 9/4/87

SANITARY SEWER GRINDER PUMP
AND FORCE LINE FOR
CHARLES TAYLOR
POQUOSON, VIRGINIA
JOHNSON - BAIRD AND ASSOCIATES
CIVIL ENGINEER AND LAND SURVEYORS
HAMPTON, VIRGINIA

PLAN SCALE 1" = 40'
PROFILE SCALE
HORIZ. 1" = 30'
VERT. 1" = 2'

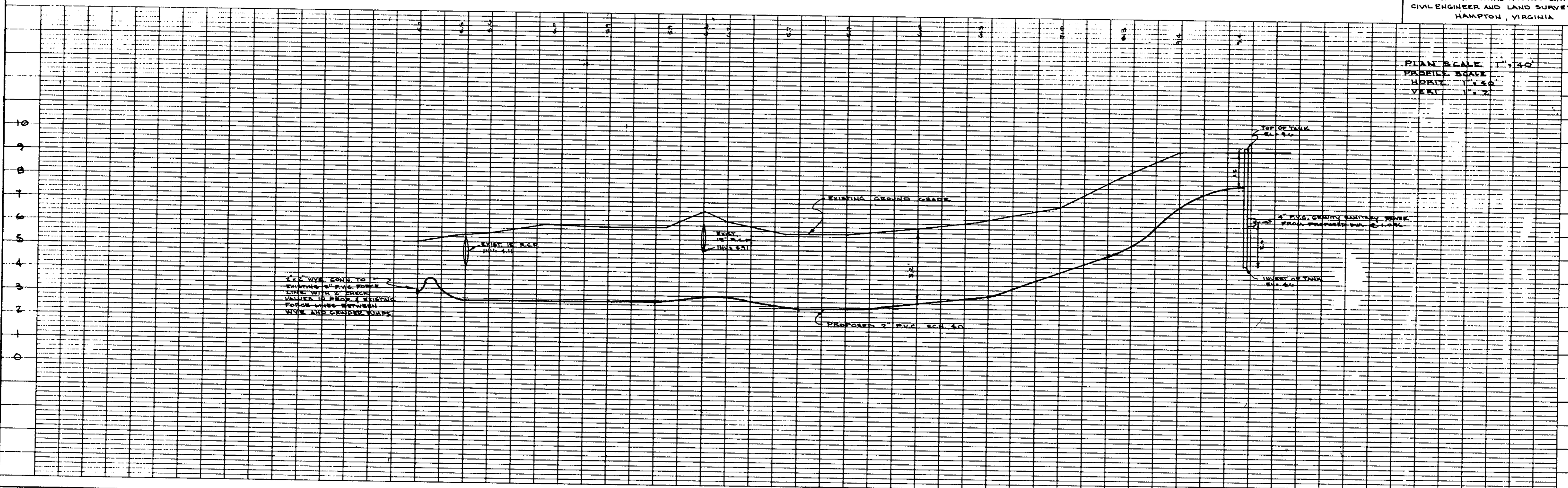

2" P.V.C. W/IN CONN. TO
EXISTING 18" P.V.C. FORCE
LINE WITH 2" CHECK
VALVE IN PROP. & EXISTING
FORCE LINE BETWEEN
NEW AND EXISTING VALVES

PROPOSED 2" P.V.C. SCH. 40

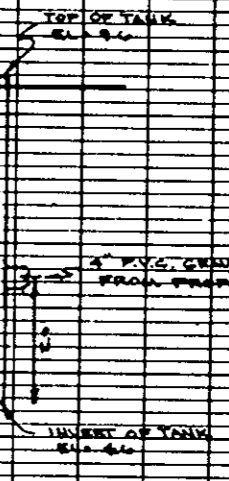

Filed in the Clerk's Office, Circuit Court, York Co., Va.
the 16th day of November 19 87
Teste: Edith M. Elliott, Clerk
4.09
D.C.
Plot Book No. 10 Page 422