

FED. ROAD DIV. NO.	STATE	FEDERAL AID		STATE		SHEET NO.	TOTAL SHEETS
		ROUTE	PROJECT	ROUTE	PROJECT		
2	VA.	24-06-5(B)	168	4899-01	16	23	

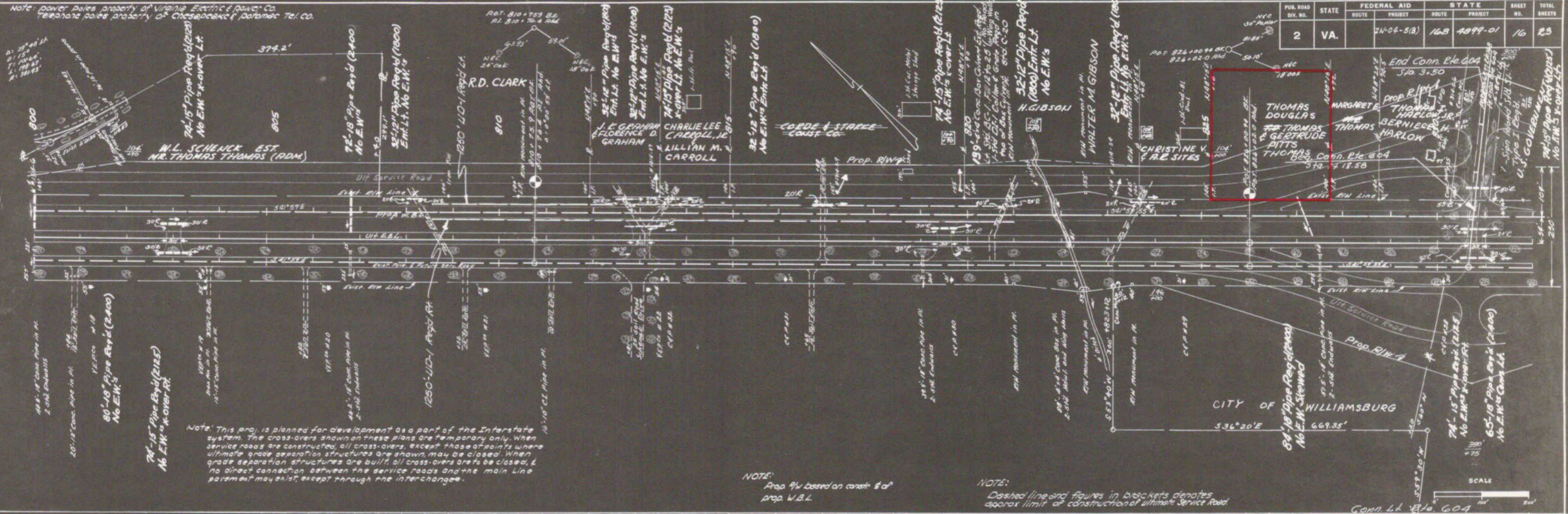

Note: power poles property of Virginia Electric & Power Co.
Telephone poles property of Chesapeake & Potomac Tel. Co.

Note: This proj. is planned for development as a part of the Interstate system. The cross-overs shown on these plans are temporary only. When service roads are constructed, all cross-overs, except those at points where ultimate grade separation structures are shown, may be closed. When grade separation structures are built, all cross-overs are to be closed, & no direct connection between the service roads and the main line pavement may exist, except through the interchanges.

NOTE:
Prop. R/W based on const. of prop. W.B.L.

NOTE:
Dashed line and figures in brackets denotes approx. limit of construction of ultimate Service Road.

DATE	BY	REVISION
12-1-55	J.E. GIBSON	AS SHOWN
11-1-55	M.S. GIBSON	AS SHOWN
10-1-55	P.S. GIBSON	AS SHOWN

PLAN
NOTE: WORK IN CONFORMANCE WITH DIV. OF HIGHWAY CONSTRUCTION, VA. DEPT. OF TRANSPORTATION.

Sheet 197

Conn. Lt. Rto. 604