

129 and 326

END OF VA STATE HIGHWAY ROUTE 600

5.15 W 26.0
MON. 111
189.15 1/2
PINE TREE
NECK 1/2 1/2
MOUNTAIN

TO HUNDLEY

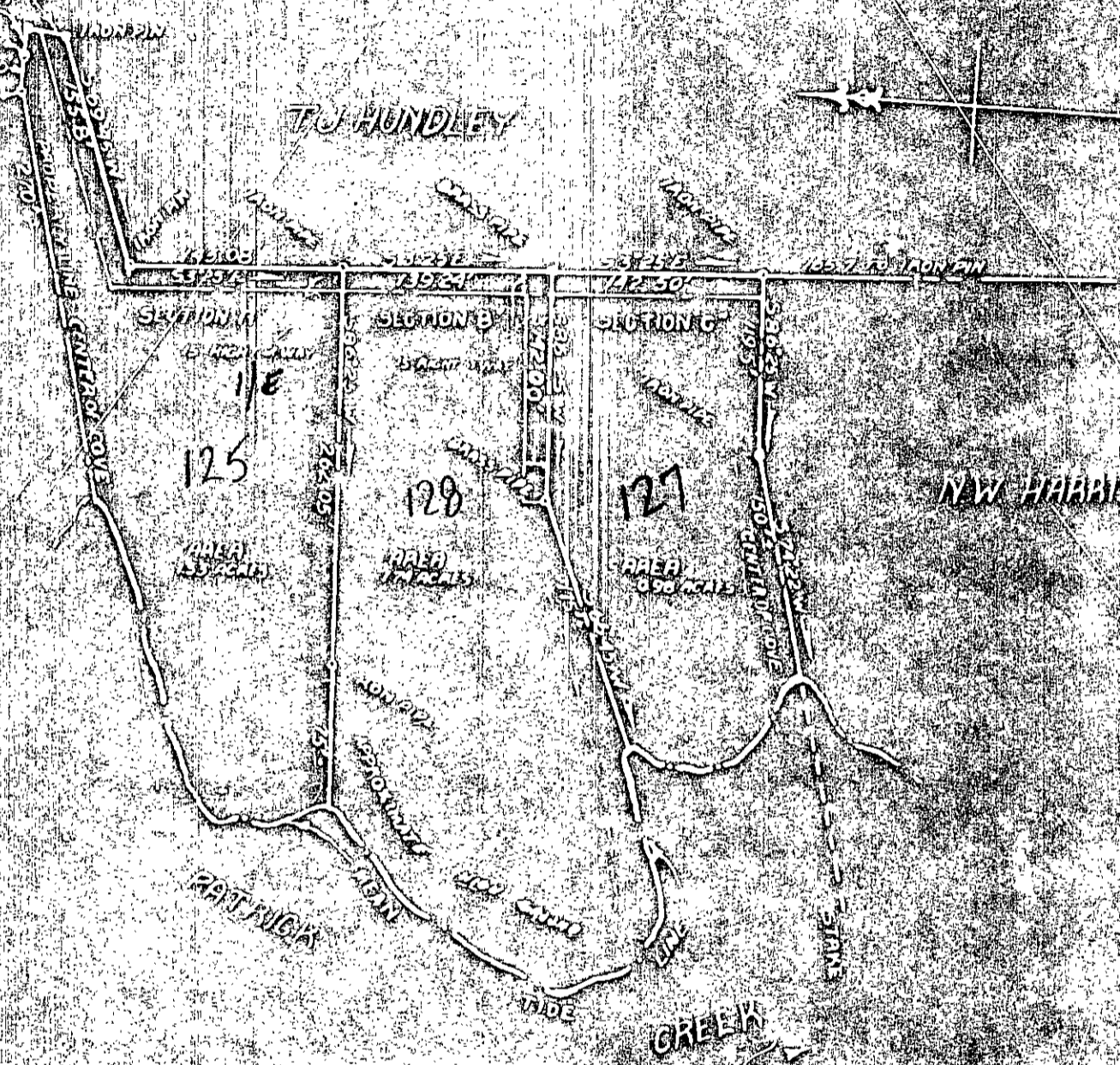
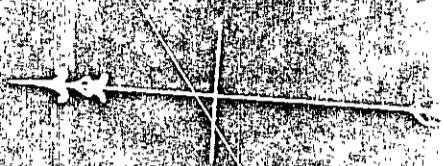

NEW HARRISON

PLAT SHOWING THE DIVISION
OF A PARCEL OF LAND
STANDING IN THE NAME OF
JOHN'S LEWELLYN & MARY LEWELLYN
GRAFTON DISTRICT
YOAK COUNTY VIRGINIA
SCALE 1"=100' 8/25/58

MANUS MANUS MANUS
MANUS MANUS MANUS
MANUS MANUS MANUS