

LIMITED ACCESS HIGHWAY

PUB. ROAD DIV. NO.	STATE	FEDERAL AID		STATE		SHEET NO.	TOTAL SHEETS
		ROUTE	PROJECT	ROUTE	PROJECT		
2	VA.		74-04-5(3)	16B	4899-01	16	23

Note: Power Poles property of Virginia Electric Power Co.
Telephone poles property of Chesapeake Potomac Tel. Co.

PLAN	DATE	BY
SUBMITTED	1/1/57	J.E. Leath
PLOTTED	1/1/57	M. S. Gorman
NOTE BOOK		M.S. Gorman
		1/1/57

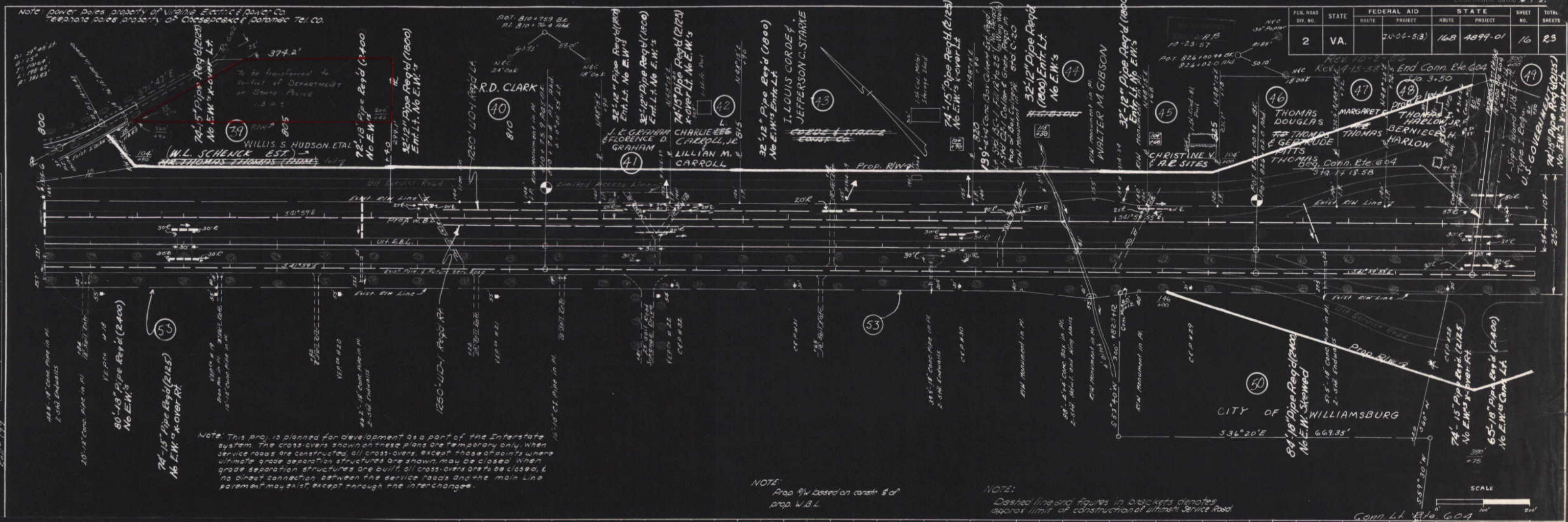

Note: This proj. is planned for development as a part of the Interstate system. The cross-overs shown on these plans are temporary only. When service roads are constructed, all cross-overs, except those at points where ultimate grade separation structures are shown, may be closed. When grade separation structures are built, all cross-overs are to be closed, & no direct connection between the service roads and the main line pavement may exist, except through the interchanges.

NOTE:
Prop. R/W based on center of prop. W.B.L.

NOTE:
Dashed lines and figures in brackets denotes approx. limit of construction of ultimate Service Road.

SCALE
0 100 200 300