

APR 10 2005

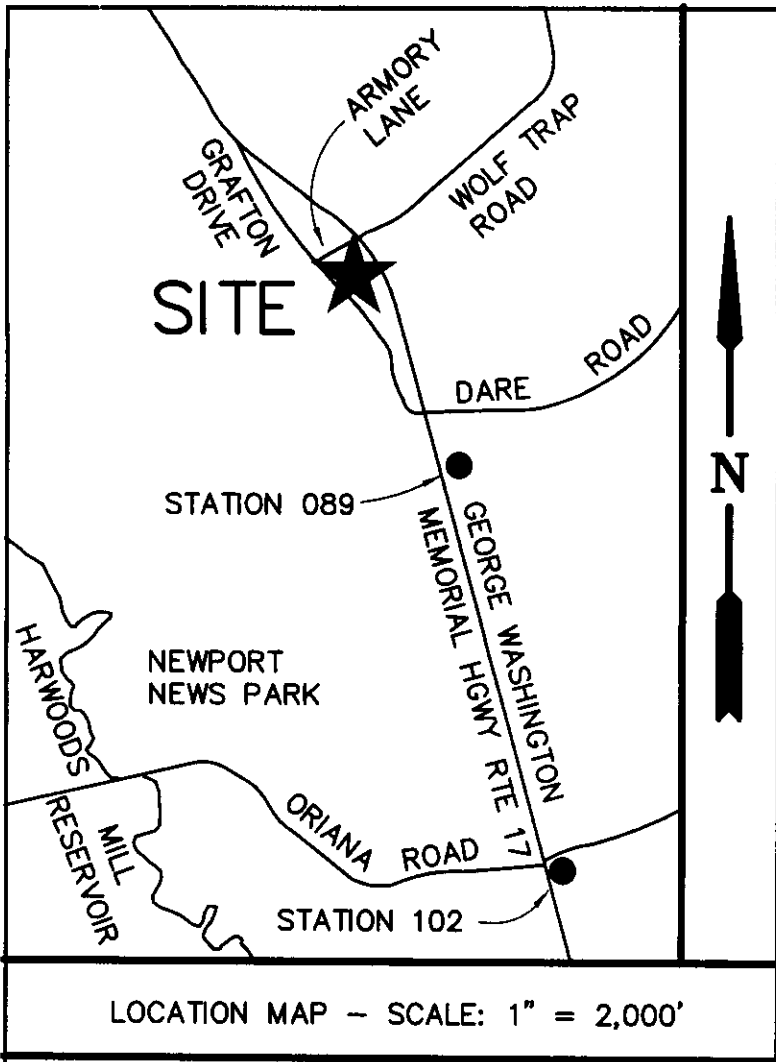

Williamsburg Residency
 DATE: 4/20/05
 TITLE: RESIDENT ENGINEER

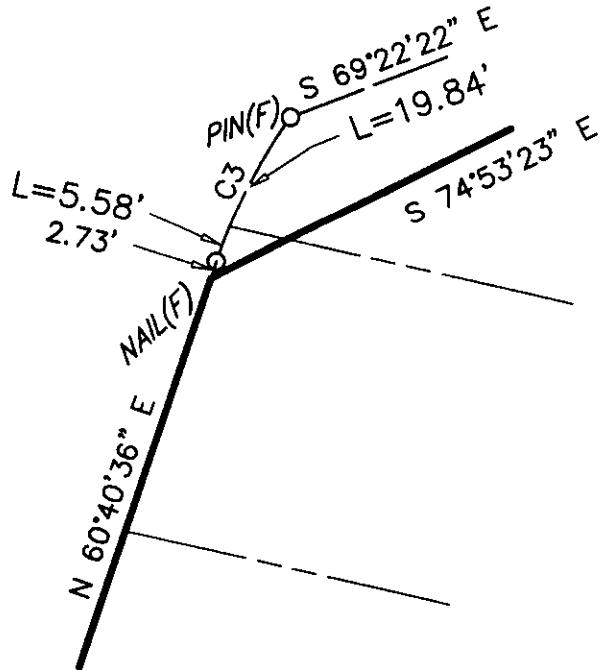

LEGEND

- IRON PIN/PIPE FOUND - PIN(F), PIPE(F)
- IRON PIN SET - PIN(S)
- MONUMENT FOUND - MON(F)
- MONUMENT SET - MON(S)

CURVE TABLE						
CURVE	RADIUS	LENGTH	TANGENT	CHORD	BEARING	DELTA
C1	35.00	63.38	44.60	55.07	N04°00'30"E	103°45'16"
C2	260.00	21.77	10.89	21.76	N58°17'03"E	4°47'51"
C3	89.00	25.69	12.93	25.60	N68°56'45"E	16°32'19"
C4	1874.86	89.88	44.95	89.87	S41°46'38"E	2°44'49"
C5	1864.86	89.57	44.29	88.56	N41°47'25"W	2°43'16"

YORK COUNTY
 APPROVED AS TO CONFORMANCE WITH
 EXISTING GIS DATA

BY: Carl A. Bryant *CA*
 TITLE: Computer Support Services
 DATE: 5-9-05

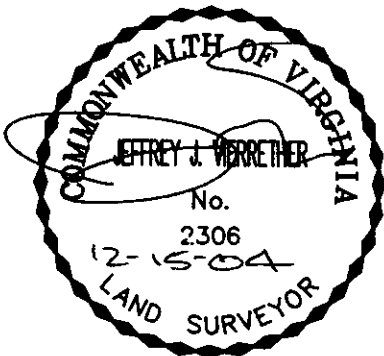
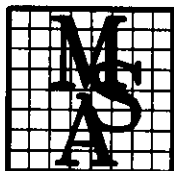

EXHIBIT 'A'
 RIGHT-OF-WAY CONVEYANCE PLAT
 OF A PORTION OF PROPERTY OF
WACHOVIA BANK, N.A.

GPIN #S07C-0441-0089 &
 GPIN #S07C-0385-0066,
 TAX MAP #029, PARCEL 35
 (INSTRUMENT NO. 040002467)
 TO BE CONVEYED TO

THE COMMONWEALTH OF VIRGINIA
 GRAFTON DISTRICT YORK COUNTY, VIRGINIA



MSA, P.C.

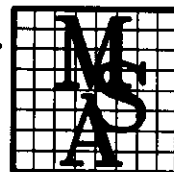

Landscape Architecture · Planning
 Surveying · Engineering
 Environmental Sciences

5033 ROUSE DRIVE, VIRGINIA BEACH, VA 23462-3708
 PHONE (757) 490-9264 · FAX (757) 490-0634

SHEET 2 OF 2
 PLAT RECORDED IN

JOB# 02046P

ZONED: GB

DATE: 11/19/2004

SCALE: 1"=60'

DWN BY: KCR

M.B. 722, PG. 933