

EXHIBIT "C"

PLAT OF VILLAS ON SHADY BANKS A CONDOMINIUM PHASE III

(PROP. REF.: D.B. 54, P.107; D.B. 968, PGS.532-550) (INSTR. #050004943; INSTR. #030021817) SHEET 2 OF 4

BETHEL DISTRICT - COUNTY OF YORK, VIRGINIA

SCALE: 1" = 100' MAY 27, 2005

0 50 100 200 300 400 FEET

GRAPHIC SCALE

THE SIRINE GROUP, LTD.

SURVEYORS • ENGINEERS • PLANNERS 4794 GEORGE WASHINGTON MEMORIAL HIGHWAY P.O. BOX 450, U.S. ROUTE 17 WHITE MARSH, VIRGINIA 23183 (804) 693-9548

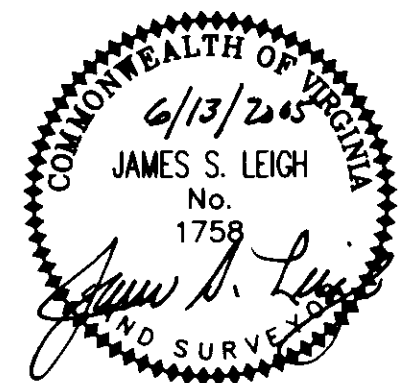
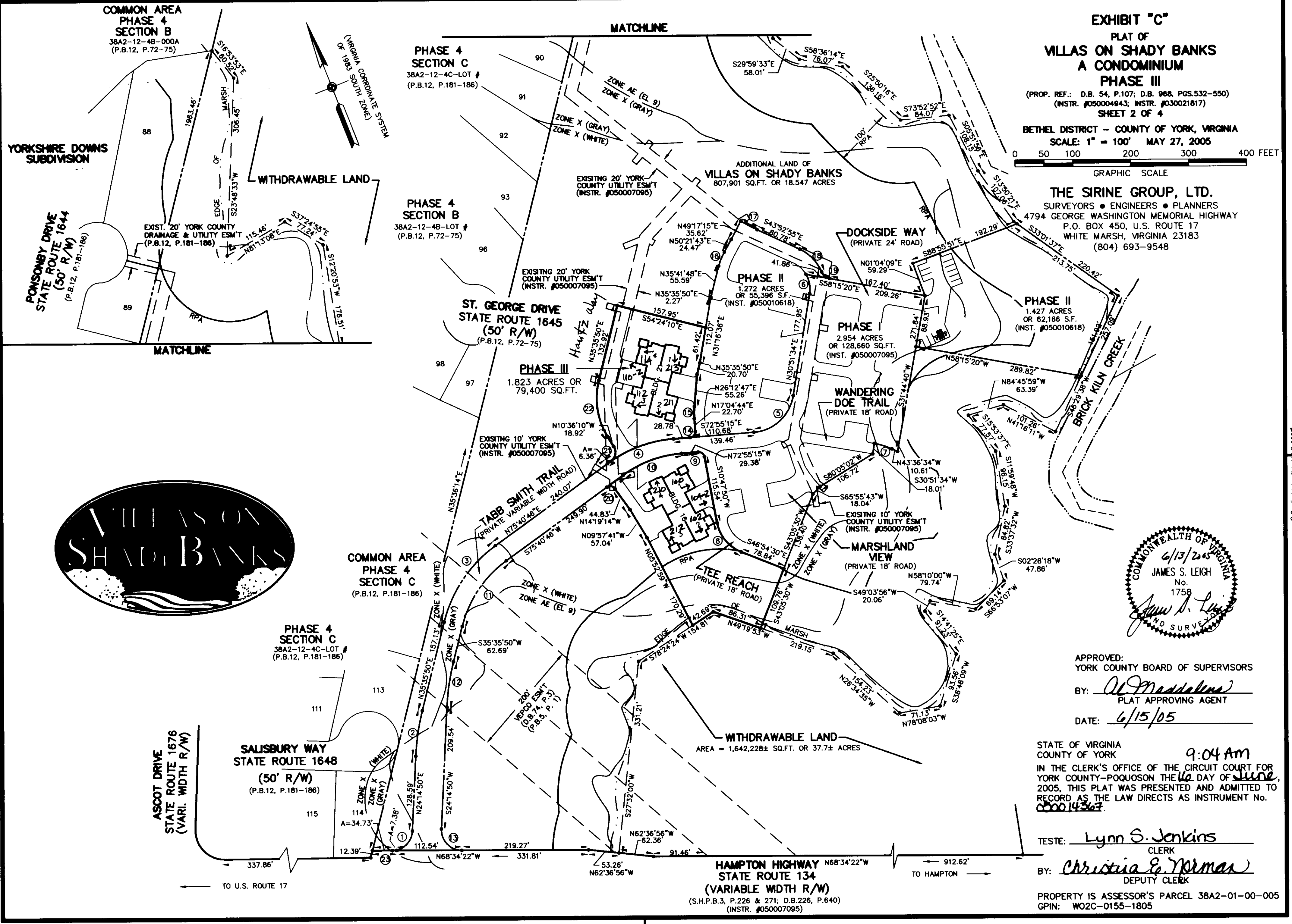

APPROVED: YORK COUNTY BOARD OF SUPERVISORS BY: Al Maddalena PLAT APPROVING AGENT DATE: 6/15/05

STATE OF VIRGINIA COUNTY OF YORK 9:04 AM IN THE CLERK'S OFFICE OF THE CIRCUIT COURT FOR YORK COUNTY-POQUOSON THE 16th DAY OF June, 2005, THIS PLAT WAS PRESENTED AND ADMITTED TO RECORD AS THE LAW DIRECTS AS INSTRUMENT NO. 050014367.

TESTE: Lynn S. Jenkins CLERK BY: Christina E. Norman DEPUTY CLERK

PROPERTY IS ASSESSOR'S PARCEL 38A2-01-00-005 GPIN: W02C-0155-1805