

SURVEYED BY: BOB HARMON 0751253-537  
 SUPERVISED BY: P.J. BYRUM 0751925-2557  
 DESIGNED BY: J.D. WINESTEAD 0751925-2556  
 HAMPTON ROADS DISTRICT DESIGN UNIT

THESE PLANS ARE UNFINISHED  
 AND ARE NOT TO BE USED FOR  
 ANY TYPE OF CONSTRUCTION.

DESIGN FEATURES RELATING TO CONSTRUCTION  
 OR TO REGULATION AND CONTROL OF TRAFFIC  
 MAY BE SUBJECT TO CHANGE AS DEEMED  
 NECESSARY BY THE DEPARTMENT

REVISED	STATE	FEDERAL AID PROJECT	ROUTE	STATE PROJECT	SHEET NO.
	VA.		17	6017-099-129, RW-201, C-501	5

REFERENCES (PROFILES, DETAIL & DRAINAGE DESCRIPTION SHEETS, ETC.)	
MAINLINE PROFILES	5A
CONNECTION PROFILES	5B
ENTRANCE PROFILES	24B
DRAINAGE DESC.	2(H) - 2(H7)
CROSS-OVER DETAIL	2E

004  
 CITY OF NEWPORT NEWS  
 DB41 PG137  
 PB11 PG42B-489  
 1032.88 AC.  
 Tax\* R05D-4244-0827  
 \*3629

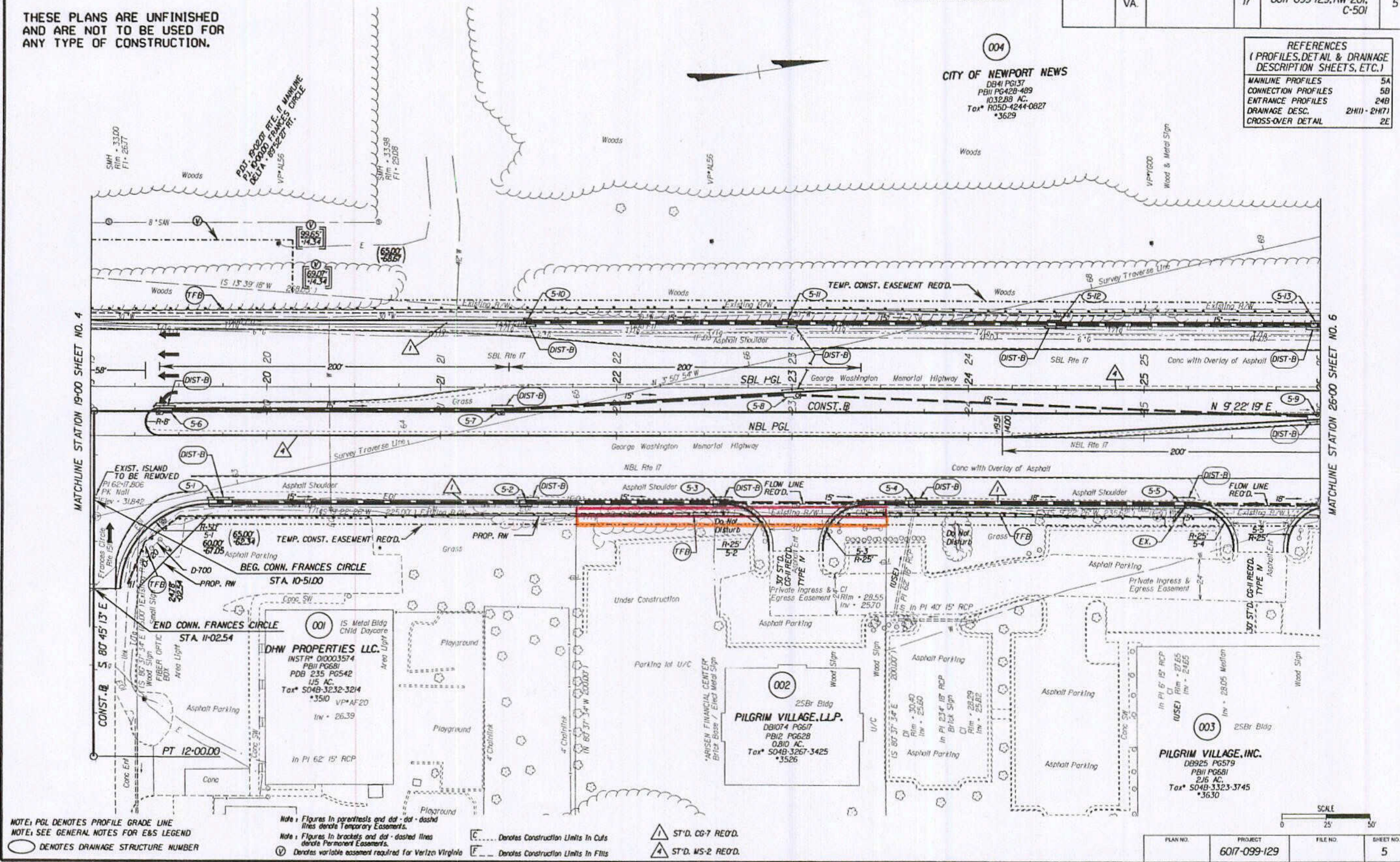

NOTE: PGL DENOTES PROFILE GRADE LINE  
 NOTE: SEE GENERAL NOTES FOR E&S LEGEND  
 ○ DENOTES DRAINAGE STRUCTURE NUMBER

Note: Figures in parenthesis and dot-dash lines denote Temporary Easements.  
 Note: Figures in brackets and dot-dashed lines denote Permanent Easements.  
 V Denotes variable easement required for Verizon Virginia

--- Denotes Construction Limits in Cuts  
 --- Denotes Construction Limits in Fills

▲ ST'D. CG-7 REQ'D.  
 ▲ ST'D. MS-2 REQ'D.



PLAN NO.	PROJECT	FILE NO.	SHEET NO.
	6017-099-129		5

9/20/2006 08:05:58

DOC INSTR 06 0025 712

State Highway

Plat Book No. 9 Page 265