

BURGESS & NIPLE

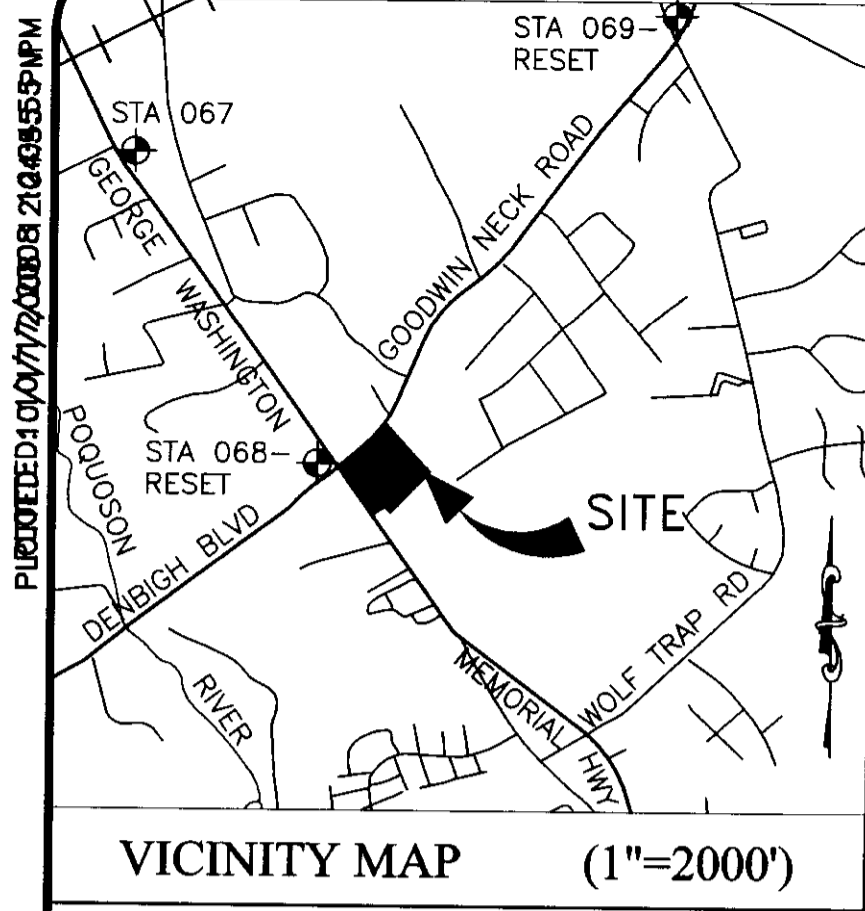

CURVE TABLE						
CURVE	RADIUS	DELTA	LENGTH	TANGENT	CH. DIR.	CHORD
C1	5754.58'	01°19'39"	133.33'	66.67'	N34°50'50"W	133.33'

- DENOTES PRIVATE INGRESS/EGRESS EASEMENT (P.B. 11 PG. 183) HEREBY VACATED
- DENOTES 16' NON-EXCLUSIVE INGRESS/EGRESS EASEMENT (INST.# 020018626) HEREBY VACATED
- DENOTES PORTION OF 10' RESTRICTED ACCESS EASEMENT (P.B. 11 PG. 183) HEREBY VACATED

PLAT OF EASEMENTS
BETWEEN
PARCEL 1 & PARCEL 2
SUBDIVISION OF THE PROPERTY OF
J. MICHAEL BURKE & BETTY L. BURKE
AND
CHARLES E. TURNELLE, JR. & JANE TURNELLE
AND
PARCEL 1
SUBDIVISION PLAT OF THE PROPERTY OF
TABB DEVELOPMENT COMPANY, L.L.C.,
A VIRGINIA LIMITED LIABILITY COMPANY
GRAFTON DISTRICT COUNTY OF YORK, VIRGINIA
SCALE: 1"=50' **DATE: SEPTEMBER 29, 2008**



SHEET 1 OF 2



BURGESS & NIPLE

CONVERGENCE CENTER 1
 295 BENDIX ROAD, SUITE 300, VIRGINIA BEACH, VA 23452
 PH (757) 490-3566 FAX (757) 490-9224

2009 FEB -5 PM 3:32

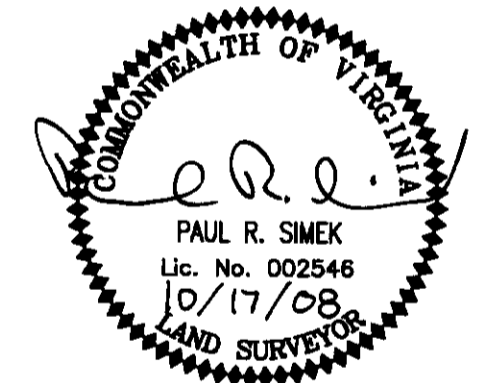

THE PROPERTY AS SHOWN ON THIS PLAT DOES NOT VIOLATE THE PROVISIONS OF THE YORK COUNTY SUBDIVISION ORDINANCE

SIGNED: *Al Maddalena*
 TITLE: Chief of Administration & Compliance
 DATE: 2/5/09

COMMONWEALTH OF VIRGINIA
 COUNTY OF YORK

IN THE CLERK'S OFFICE OF THE CIRCUIT COURT FOR THE COUNTY OF YORK, VIRGINIA, THE 5th DAY OF FEBRUARY, 2009, THIS PLAT WAS PRESENTED AND ADMITTED TO RECORD AS THE LAW DIRECTS IN PLAT BOOK _____ AT PAGE _____ INSTR# 090002156

TESTE: LYNN S. MENDEBUR 3:32 p.m.
 CLERK

BY: *Valeria Lynn Mendebur D.C.*

S:\JOBS\41364\cadd\EASEMENT-dedication-9-23-08.dwg 10/9/2008 1:29:35 PM Hartfiel, Brandon

