

SUBDIVISION PLAT OF TEQUESTA VILLAGE BETHEL MAGISTERIAL DISTRICT COUNTY OF YORK, VIRGINIA SCALE: 1" = 150' DATE: OCTOBER 2, 2019 SHEET 4 OF 4 DAVIS & ASSOCIATES, P.C. LAND SURVEYORS AND PLANNERS 3630 GEORGE WASHINGTON MEMORIAL HIGHWAY YORKTOWN, VIRGINIA 23693 (757)867-8583

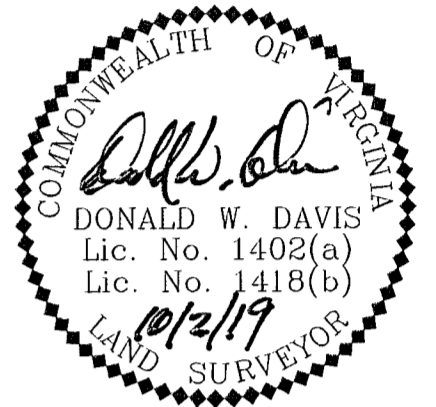
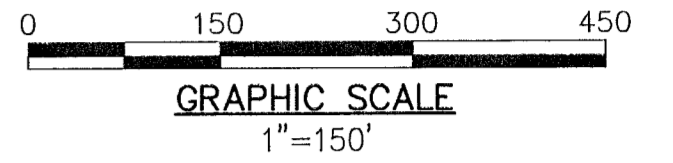

NOW OR FORMERLY SMITH INVESTMENT PROP. LLC GPIN # U03b-4069-3582 TAX MAP # 37-00-00-138 ZONE: R20

NOTE: THIS RIGHT-OF-WAY IS PLATTED WITH THE INTENT OF BEING EXTENDED AND CONTINUED IN ORDER TO PROVIDE INGRESS / EGRESS TO AND FROM FUTURE SUBDIVISIONS OR ADJACENT PROPERTIES.

LOT 11 NOW OR FORMERLY MARR (INST. # 150009767) GPIN # U03d-3819-2135 TAX MAP # 37-18-04-011 ZONE: R20

LOT 8 NOW OR FORMERLY KOWALEWSKI (INST. # 140015819) GPIN # U03d-3524-2126 TAX MAP # 37-18-5A-008 ZONE: R20

LOT 23 NOW OR FORMERLY HOLLIS (INST. # 100021486) GPIN # U03d-2975-2072 TAX MAP # 37-18-5B-023 ZONE: R20

APPROVED YORK COUNTY BOARD OF SUPERVISORS BY: [Signature] PLAT APPROVING AGENT DATE: May 21, 2020

STATE OF VIRGINIA COUNTY OF YORK IN THE CLERK'S OFFICE OF THE YORK - POQUOSON CIRCUIT COURT THIS 1st DAY OF June 20 20 THIS MAP WAS PRESENTED AND ADMITTED TO RECORD AS THE LAW DIRECTS AS INSTRUMENT # 200008704

TESTE: KRISTEN N. NELSON, CLERK BY: [Signature] CLERK

