

**EASEMENT LEGEND**

- 1 - EXISTING 40' YORK COUNTY DRAINAGE EASEMENT [D.B. 359, PG. 469]
- 2 - EXISTING 20' YORK COUNTY UTILITY EASEMENT (CENTERED OVER SANITARY SEWER LINE) [INST. # 170019369]
- 3 - EXISTING PRIVATE 25' DRAINAGE AND UTILITY EASEMENT FOR THE BENEFIT OF TAX PARCELS #36-00-00-022 & #36-01-00-000A [INST. # 100021723]
- 4 - EXISTING VARIABLE WIDTH DRAINAGE EASEMENT (OVER AND THROUGH STORMWATER BASIN, BMP #'s 3 & 4) [INST. # 170020100]
- 5 - EXISTING 10' DRAINAGE EASEMENT (CENTERED ON STORM DRAIN) [INST. # 170020100]
- 6 - EXISTING PRIVATE VARIABLE WIDTH PEDESTRIAN ACCESS ESMT. (ENCOMPASSING SIDEWALKS AND CROSSWALKS ADJACENT TO PUBLIC RIGHT-OF-WAYS) [INST. # 170020100]
- 7 - EXISTING PRIVATE 10' DRAINAGE EASEMENT (CENTERED ON STORM DRAIN) [INST. # 170019369]
- 8 - EXISTING VARIABLE WIDTH PRIVATE DRAINAGE AND UTILITY EASEMENT FOR THE BENEFIT OF TAX PARCELS #36-00-00-022 & #36-01-00-000A [INST. # 140021262]
- 9 - EXISTING VARIABLE WIDTH YORK COUNTY WETLANDS CONSERVATION EASEMENT (OVER AND ACROSS JURISDICTIONAL WETLANDS) [INST # 170019369]
- 10 - 35' PRIVATE INGRESS/EGRESS, DRAINAGE AND UTILITIES EASEMENT [INST. # 200004253]
- 11 - TEMPORARY TURNAROUND EASEMENT TO BE VACATED UPON THE EXTENSION OF KEENER WAY (50' PUBLIC R/W) AND FUTURE JEANETTE DRIVE (50' PUBLIC R/W)
- 12 - VARIABLE WIDTH SIGHT EASEMENT [INST. # 200004253]
- 13 - 35' PRIVATE INGRESS/EGRESS, DRAINAGE AND UTILITIES EASEMENT HEREBY CONVEYED TO MAINSTAY CONDOMINIUM OWNERS ASSOCIATION

**CURVE DATA TABLE**

NUMBER	DELTA ANGLE	RADIUS	ARC LENGTH	TANGENT	CHORD LENGTH	CHORD DIRECTION
C1	90°00'00"	25.00'	39.27'	25.00'	35.36'	S 62°22'50" W
C2	38°17'13"	250.00'	167.06'	86.78'	163.97'	S 88°14'13" W
C3	38°17'16"	250.00'	167.06'	86.78'	163.97'	S 49°56'59" W
C4	03°14'48"	322.54'	18.28'	9.14'	18.27'	N 36°30'37" W
C5	13°14'23"	155.13'	35.85'	18.00'	35.77'	N 44°45'13" W
C6	03°14'48"	357.54'	20.26'	10.13'	20.26'	N 36°30'37" W

**LINE DATA TABLE**

LINE	BEARING	DISTANCE
L1	N 59°11'39" W	36.94'
L2	S 52°53'42" E	34.51'
L3	N 34°53'13" W	15.98'
L4	S 32°08'58" W	36.34'
L5	N 34°53'13" W	15.98'
L6	N 38°08'01" W	67.14'

**CONDOMINIUM PLAT**  
 OF  
**PHASE THIRTY TWO**  
 AND  
**PHASE THIRTY THREE**  
**MAINSTAY AT**  
**COMMONWEALTH GREEN**  
**SECTION ONE - PARCEL 'D'**  
 BETHEL MAGISTERIAL DISTRICT  
 COUNTY OF YORK, VIRGINIA  
 SCALE: 1"=10' DATE: FEBRUARY 28, 2022  
 SHEET 6 OF 7  
 DAVIS & ASSOCIATES, P.C.  
 LAND SURVEYORS AND PLANNERS  
 3630 GEORGE WASHINGTON MEMORIAL HIGHWAY  
 YORKTOWN, VIRGINIA 23693  
 (757)867-8583

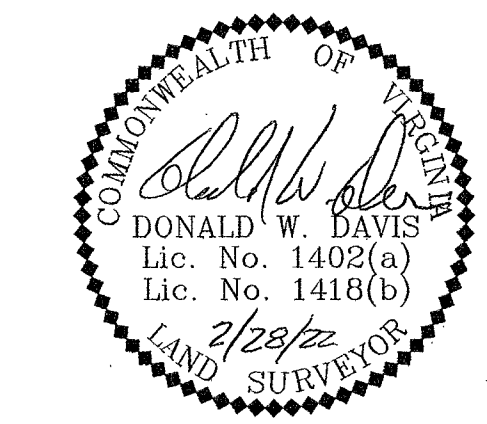

**PHASE THIRTY TWO - BUILDING FORTY SEVEN DETAIL (UNITS 63 & 64)**  
**PHASE THIRTY THREE - BUILDING FORTY SIX DETAIL (UNITS 65 & 66)**

DIMENSIONS REFLECT INTERIOR FRAME LINE

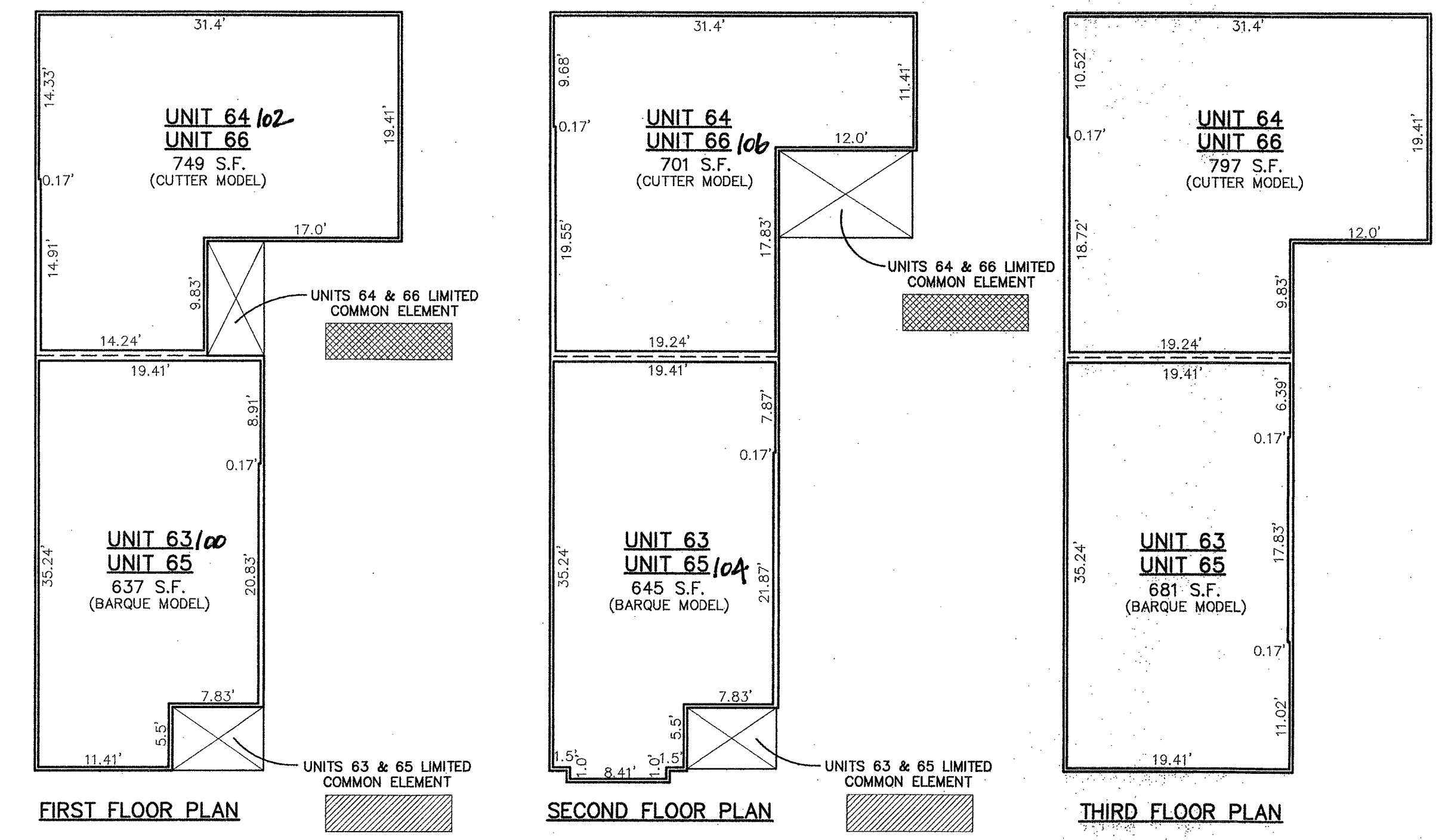

- S Y M B O L S -
- DENOTES LIMITED COMMON ELEMENT - UNITS 63 & 65
  - DENOTES LIMITED COMMON ELEMENT - UNITS 64 & 66

**APPROVED**  
 YORK COUNTY BOARD OF SUPERVISORS  
 BY: *Eisen Kassel*  
 PLAT APPROVING AGENT  
 DATE: MAY 19, 2022

STATE OF VIRGINIA  
 COUNTY OF YORK  
 IN THE CLERK'S OFFICE OF THE YORK -  
 POQUOSON CIRCUIT COURT THIS 20th  
 DAY OF May 2022 THIS MAP WAS  
 PRESENTED AND ADMITTED TO RECORD AS  
 THE LAW DIRECTS AS INSTRUMENT # 220008585  
 TESTE: KRISTEN N. NELSON, CLERK  
 CLERK  
 BY: Naalene UHalt, Jr