

CONDOMINIUM PLAT
OF
PHASE THIRTY SEVEN
AND
PHASE THIRTY EIGHT
MAINSTAY AT
COMMONWEALTH GREEN
SECTION ONE - PARCEL 'D'

BETHEL MAGISTERIAL DISTRICT
COUNTY OF YORK, VIRGINIA
SCALE: 1"=40' DATE: OCTOBER 14, 2022
SHEET 3 OF 7

DAVIS & ASSOCIATES, P.C.
LAND SURVEYORS AND PLANNERS
3630 GEORGE WASHINGTON MEMORIAL HIGHWAY
YORKTOWN, VIRGINIA 23693
(757)867-8583



- SYMBOLS -
- DENOTES IRON PIPE FOUND
 - DENOTES IRON ROD FOUND
 - DENOTES IRON ROD TO BE SET AT ALL PROPERTY LINE JUNCTURES
 - DENOTES CONCRETE MONUMENT FOUND
 - DENOTES CONCRETE MONUMENT TO BE SET
 - DENOTES JURISDICTIONAL WETLANDS MARKED BY WOLFE ENVIRONMENTAL & ENGINEERING CONSULTANTS AND FIELD LOCATED BY DAVIS AND ASSOCIATES, P.C. ON DECEMBER 30, 2005 USCOE PROJECT # 05-R2629 USCOE PROJECT # 95-5485
 - DENOTES ADDITIONAL AND WITHDRAWABLE LAND "A"

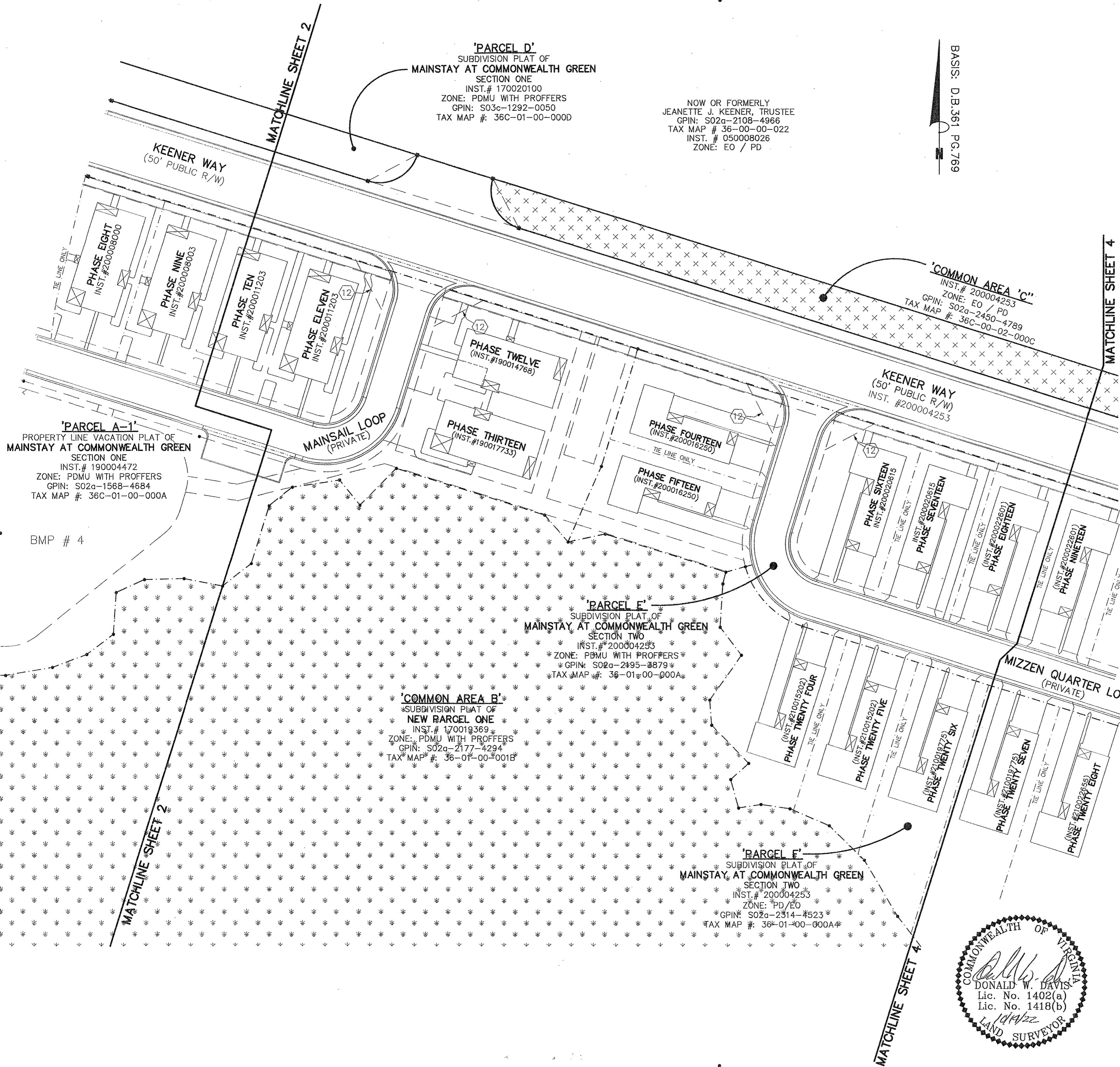

'PARCEL D'
SUBDIVISION PLAT OF
MAINSTAY AT COMMONWEALTH GREEN
SECTION ONE
INST.# 170020100
ZONE: PDMU WITH PROFFERS
GPIN: S03c-1292-0050
TAX MAP #: 36C-01-00-000D

NOW OR FORMERLY
JEANETTE J. KEENER, TRUSTEE
GPIN: S02a-2108-4966
TAX MAP # 36-00-00-022
INST. # 050008026
ZONE: EO / PD

BASIS: D.B.361 PG.769

'COMMON AREA C'
INST.# 200004253
ZONE: EO / PD
GPIN: S02a-2450-4789
TAX MAP #: 36C-00-02-000C

'PARCEL A-1'
PROPERTY LINE VACATION PLAT OF
MAINSTAY AT COMMONWEALTH GREEN
SECTION ONE
INST.# 190004472
ZONE: PDMU WITH PROFFERS
GPIN: S02a-1568-4684
TAX MAP #: 36C-01-00-000A

'PARCEL E'
SUBDIVISION PLAT OF
MAINSTAY AT COMMONWEALTH GREEN
SECTION TWO
INST.# 200004253
ZONE: PDMU WITH PROFFERS
GPIN: S02a-2495-3879
TAX MAP #: 36-01-00-000A

'COMMON AREA B'
SUBDIVISION PLAT OF
NEW PARCEL ONE
INST.# 170019369
ZONE: PDMU WITH PROFFERS
GPIN: S02a-2177-4294
TAX MAP #: 36-01-00-001B

'PARCEL E'
SUBDIVISION PLAT OF
MAINSTAY AT COMMONWEALTH GREEN
SECTION TWO
INST.# 200004253
ZONE: PD/EO
GPIN: S02a-2314-#523
TAX MAP #: 36-01-00-000A

APPROVED
YORK COUNTY BOARD OF SUPERVISORS

BY: Susan Kassel FOR Susan Kassel
PLAT APPROVING AGENT

DATE: 11/18/22

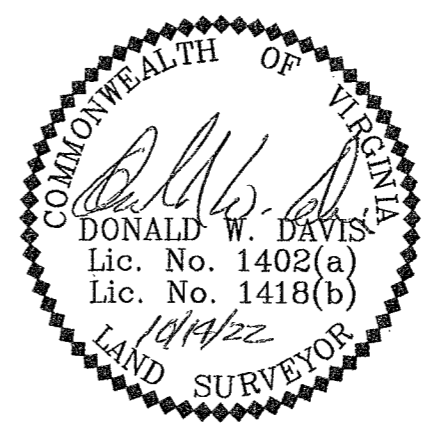

STATE OF VIRGINIA
COUNTY OF YORK
IN THE CLERK'S OFFICE OF THE YORK -
POQUOSON CIRCUIT COURT THIS 22nd
DAY OF NOVEMBER 2022, THIS MAP WAS
PRESENTED AND ADMITTED TO RECORD AS
THE LAW DIRECTS AS INSTRUMENT # 220019812

TESTE: Kristina Nelson
CLERK

BY: Kristina Nelson