

85

90

95

SUFFOLK DISTRICT DESIGN UNIT

SUPERVISED BY: E. N. HOLLOWELL  
 DESIGNED BY: D. B. WINSLOW  
 CAD OPERATOR: J. J. GIBSON  
 REVISED BY:

| NO. | DATE     | DESCRIPTION |
|-----|----------|-------------|
| 1   | 06/12/97 | 06-234      |
| 2   |          |             |
| 3   |          |             |
| 4   |          |             |
| 5   |          |             |
| 6   |          |             |
| 7   |          |             |
| 8   |          |             |
| 9   |          |             |
| 10  |          |             |

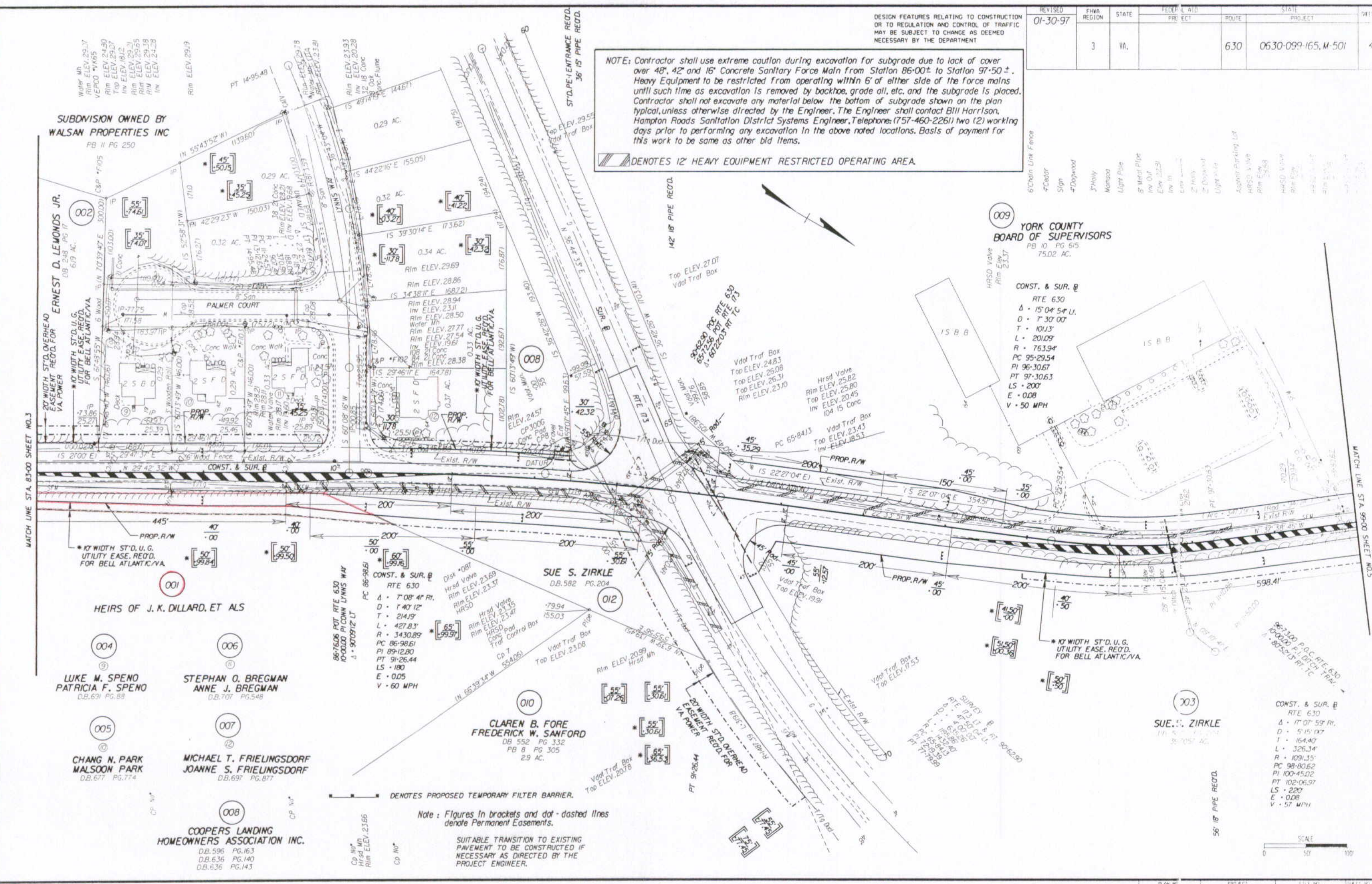

DESIGN FEATURES RELATING TO CONSTRUCTION OR TO REGULATION AND CONTROL OF TRAFFIC MAY BE SUBJECT TO CHANGE AS DEEMED NECESSARY BY THE DEPARTMENT

| REVISED  | FHWA REGION | STATE | FEDERAL AID PROJECT | ROUTE | STATE PROJECT       | SHEET NO. |
|----------|-------------|-------|---------------------|-------|---------------------|-----------|
| 01-30-97 | 3           | VA.   |                     | 630   | 0630-099-165, M-501 | 4         |

NOTE: Contractor shall use extreme caution during excavation for subgrade due to lack of cover over 48", 42" and 16" Concrete Sanitary Force Main from Station 86+00± to Station 97+50±. Heavy Equipment to be restricted from operating within 6' of either side of the force mains until such time as excavation is removed by backhoe, grade all, etc. and the subgrade is placed. Contractor shall not excavate any material below the bottom of subgrade shown on the plan typical, unless otherwise directed by the Engineer. The Engineer shall contact Bill Harrison, Hampton Roads Sanitation District Systems Engineer, Telephone: (757-460-2261) two (2) working days prior to performing any excavation in the above noted locations. Basis of payment for this work to be same as other bid items.

■ DENOTES 12" HEAVY EQUIPMENT RESTRICTED OPERATING AREA.

009 YORK COUNTY BOARD OF SUPERVISORS  
 PB 10 PG 615  
 75.02 AC.

CONST. & SUR. B  
 RTE 630  
 Δ - 15' 04" 54" U.  
 D - 7' 30" 00"  
 T - 101.13'  
 L - 201.09'  
 R - 763.94'  
 PC 95+29.54  
 PI 96+30.67  
 PT 97+30.63  
 LS - 200'  
 E - 0.08  
 V - 50 MPH

003 SUE S. ZIRKLE  
 DB 522 PG 254  
 35.05 AC.

CONST. & SUR. B  
 RTE 630  
 Δ - 17' 07" 59" R.  
 D - 5' 15" 00"  
 T - 164.40'  
 L - 326.34'  
 R - 1091.35'  
 PC 98+80.62  
 PI 100+45.02  
 PT 102+06.37  
 LS - 220'  
 E - 0.08  
 V - 57 MPH

Note: Figures in brackets and dot-dashed lines denote Permanent Easements.

SUITABLE TRANSITION TO EXISTING PAVEMENT TO BE CONSTRUCTED IF NECESSARY AS DIRECTED BY THE PROJECT ENGINEER.

