

SUFFOLK DISTRICT DESIGN UNIT

Power Poles Property of:
 Virginia Power
 1500 Hamilton Ave.
 Portsmouth, VA 23707-3528

Telephone Poles Property of:
 Bell Atlantic - VA
 5701 Cleveland Street, 5th Floor
 Virginia Beach, VA 23462

Water Lines Property of:
 Newport News Waterworks
 2500 Washington Avenue 5th Floor
 Newport News, VA 23607

Gas Lines Property of:
 Virginia Natural Gas
 3719 E. Virginia Beach Blvd.
 Norfolk, VA 23502

Sewer Lines Property of:
 HRSD
 P.O. Box 5000
 Virginia Beach, VA 23455

TV Cable Lines Property of:
 Cox Communications
 179 Louise Dr.
 Newport News, VA 23602

DESIGN FEATURES RELATING TO CONSTRUCTION OR TO REGULATION AND CONTROL OF TRAFFIC MAY BE SUBJECT TO CHANGE AS DEEMED NECESSARY BY THE DEPARTMENT

REVISED	FHWA REGION	STATE	FEDERAL RD PROJECT	ROUTE	STATE PROJECT	SHEET NO.
12-02-96						
12-20-96						
01-18-97						
03-26-97	3	VA		603	0603-099-127, M-501	3
04-28-97						
08-27-97						

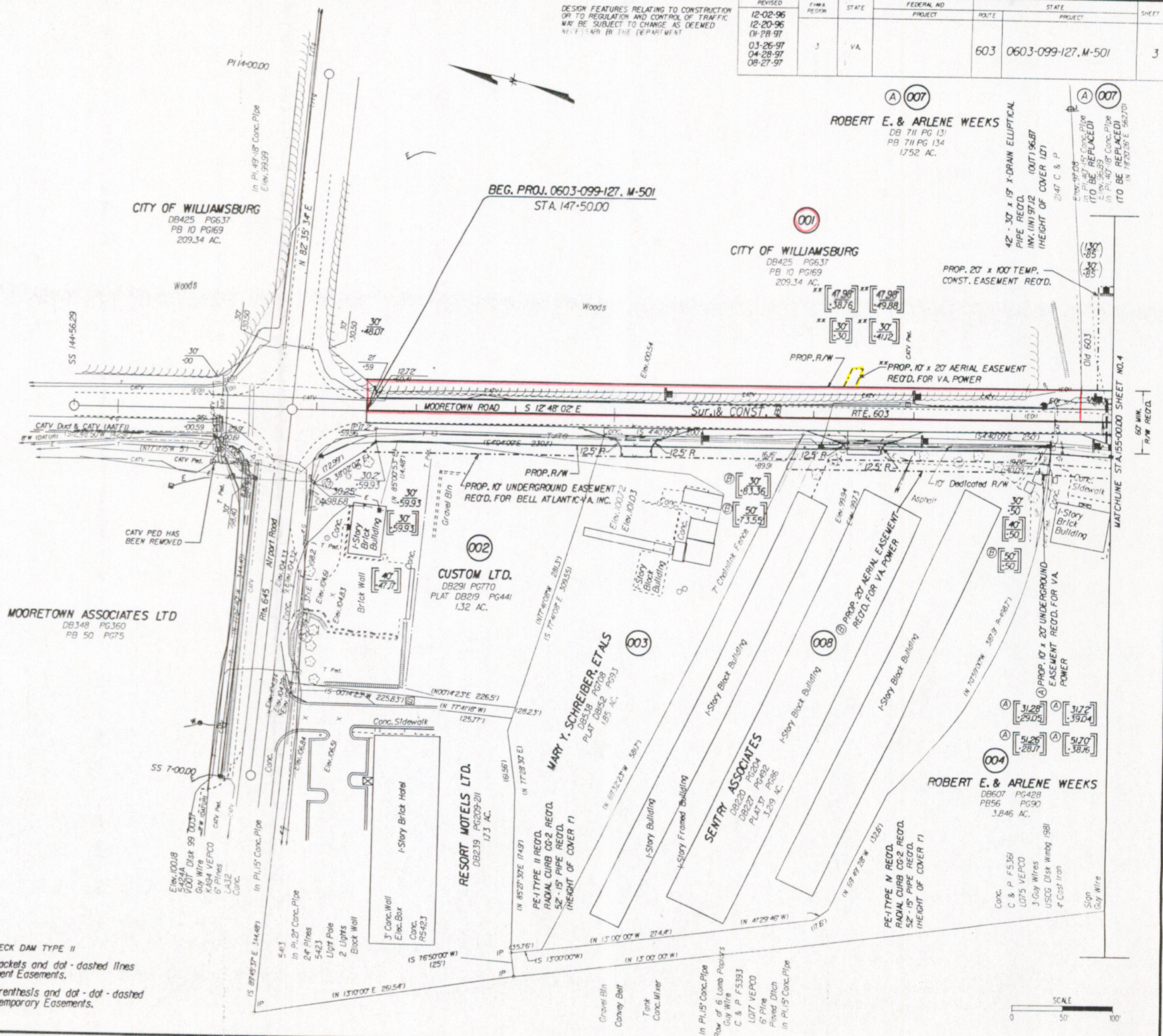

SUPERVISED BY: E. N. HOLLOWELL
 DESIGNED BY: D. B. WINSLOW
 CADD OPERATOR: J. J. ...
 REVISED BY: ...

PLAN	DATE	BY	CHK

NOTE: CENTERLINE OF EXISTING ROUTE 603 IS YORK COUNTY AND JAMES CITY COUNTY LINE.

■ DENOTES ROCK CHECK DAM TYPE II
 Note: Figures in brackets and dot-dashed lines denote Permanent Easements.
 Note: Figures in parenthesis and dot-dot-dashed lines denote Temporary Easements.

Bearings Based On: Va. State Plane Coordinate System South Zone

