

Design File: \\name\pl\proj\129620\3.dwg Ref. File: #29620.dwg Levels On: +143
 Design File: \\name\pl\proj\129620\3.dwg Ref. File: #29620.dwg Levels On: +143
 Design File: \\name\pl\proj\129620\3.dwg Ref. File: #29620.dwg Levels On: +143
 Design File: \\name\pl\proj\129620\3.dwg Ref. File: #29620.dwg Levels On: +143
 Design File: \\name\pl\proj\129620\3.dwg Ref. File: #29620.dwg Levels On: +143
 Design File: \\name\pl\proj\129620\3.dwg Ref. File: #29620.dwg Levels On: +143

REVISED	FHWA REGION	STATE	FEDERAL AID PROJECT	ROUTE	STATE PROJECT	SHEET NO.
06/03/97 07/28/97 08/25/97	3	VA		17	0017-099-V20, M-501	3B
						RWZC1

SUFFOLK DISTRICT DESIGN UNIT

SURVEYED BY: E. N. HOLLOWELL
 DESIGNED BY: R. T. SCOTT, JR.
 CAD OPERATOR: P. B. MARSHALL
 REVISED BY: \\name\pl\proj\129620\3.dwg

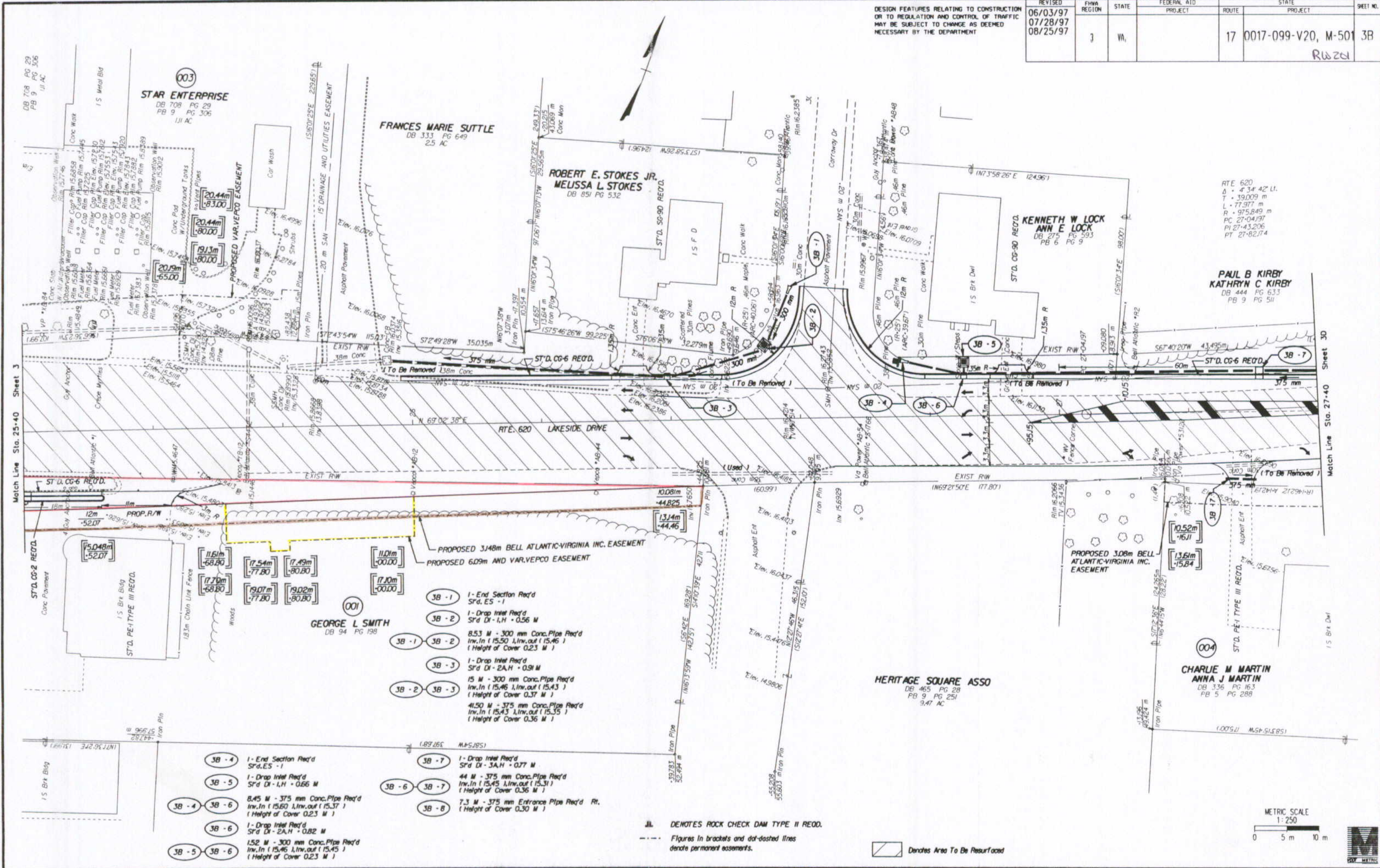

RTE 620
 Δ = 4' 34" 42" U.
 T = 39,009 m
 L = 77,977 m
 R = 975,849 m
 PC = 27+04.97
 PI = 27+43.206
 PT = 27+82.174

- 3B - 1 1- End Section Rec'd
Srd. ES - 1
- 3B - 2 1- Drop Inlet Rec'd
Srd DI - 1, H = 0.56 M
- 3B - 1 3B - 2 8.53 M - 300 mm Conc. Pipe Rec'd
Inv. In (15.50), Inv. Out (15.46)
(Height of Cover 0.23 M)
- 3B - 3 1- Drop Inlet Rec'd
Srd DI - 2A, H = 0.91 M
- 3B - 2 3B - 3 15 M - 300 mm Conc. Pipe Rec'd
Inv. In (15.46), Inv. Out (15.43)
(Height of Cover 0.37 M)
- 3B - 2 3B - 3 41.50 M - 375 mm Conc. Pipe Rec'd
Inv. In (15.43), Inv. Out (15.35)
(Height of Cover 0.36 M)
- 3B - 4 1- End Section Rec'd
Srd. ES - 1
- 3B - 5 1- Drop Inlet Rec'd
Srd DI - 1, H = 0.66 M
- 3B - 4 3B - 6 8.45 M - 375 mm Conc. Pipe Rec'd
Inv. In (15.60), Inv. Out (15.37)
(Height of Cover 0.23 M)
- 3B - 6 1- Drop Inlet Rec'd
Srd DI - 2A, H = 0.82 M
- 3B - 5 3B - 6 15.2 M - 300 mm Conc. Pipe Rec'd
Inv. In (15.46), Inv. Out (15.45)
(Height of Cover 0.23 M)
- 3B - 7 1- Drop Inlet Rec'd
Srd DI - 3A, H = 0.77 M
- 3B - 6 3B - 7 44 M - 375 mm Conc. Pipe Rec'd
Inv. In (15.45), Inv. Out (15.31)
(Height of Cover 0.36 M)
- 3B - 8 7.3 M - 375 mm Entrance Pipe Rec'd Rt.
(Height of Cover 0.30 M)

▲ DENOTES ROCK CHECK DAM TYPE II REOD.
 --- Figures In brackets and dot-dashed lines denote permanent easements.

▨ Denotes Area To Be Resurfaced

