

VIRGINIA ELECTRIC & POWER CO.
 Williamsburg - Yorktown
 TRANSMISSION LINE
 PLAT TO ACCOMPANY RIGHT-OF-WAY AGREEMENT
 BETTY DIGGS
 YORK COUNTY VA
 12-13-1926
 W-V-1214

118

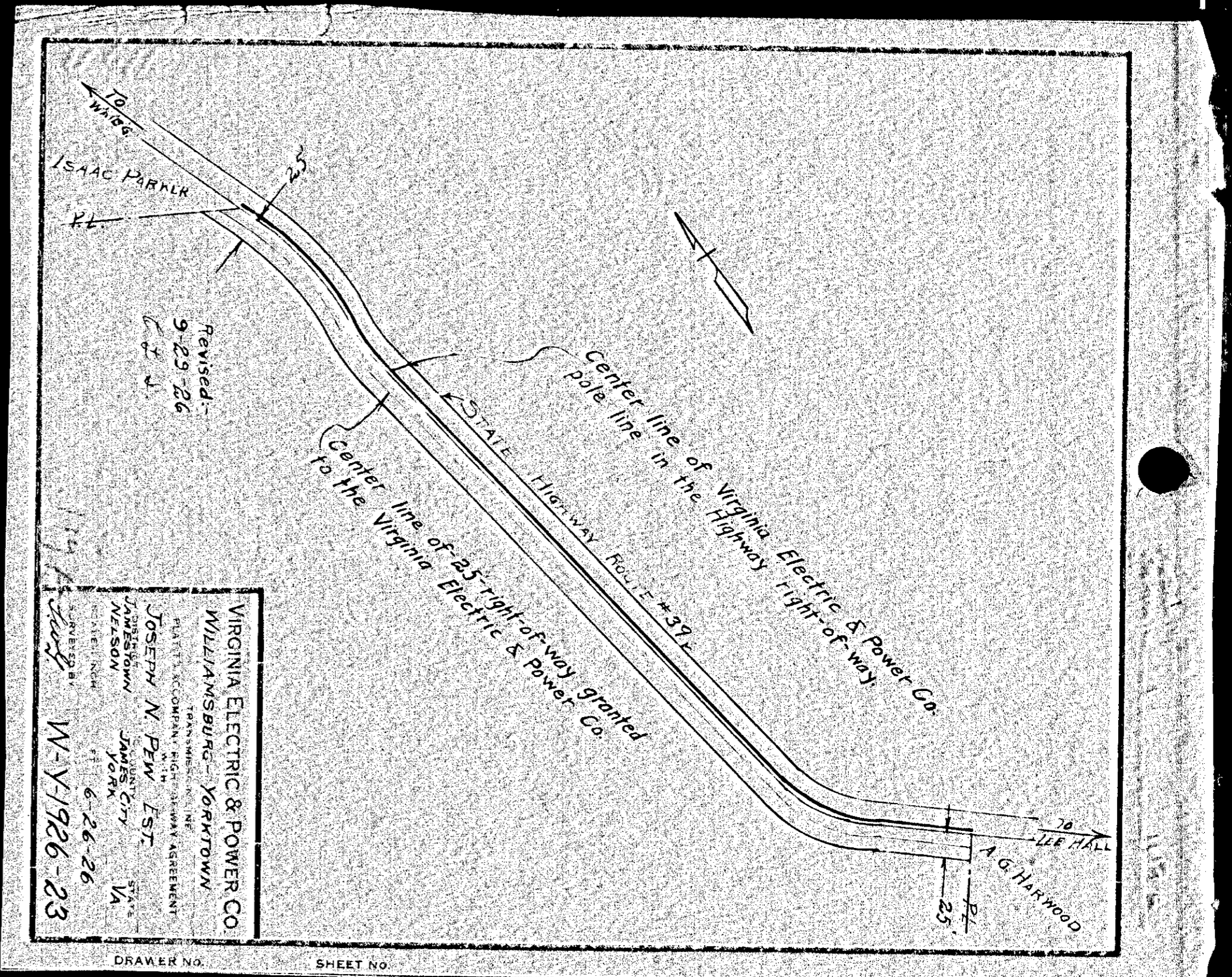

VIRGINIA ELECTRIC & POWER CO.
 Williamsburg - Yorktown
 TRANSMISSION LINE
 PLAT TO ACCOMPANY RIGHT-OF-WAY AGREEMENT
 JOSEPH N. PEW EST.
 JAMES CITY VA
 6-26-26
 W-V-1926-23

117A

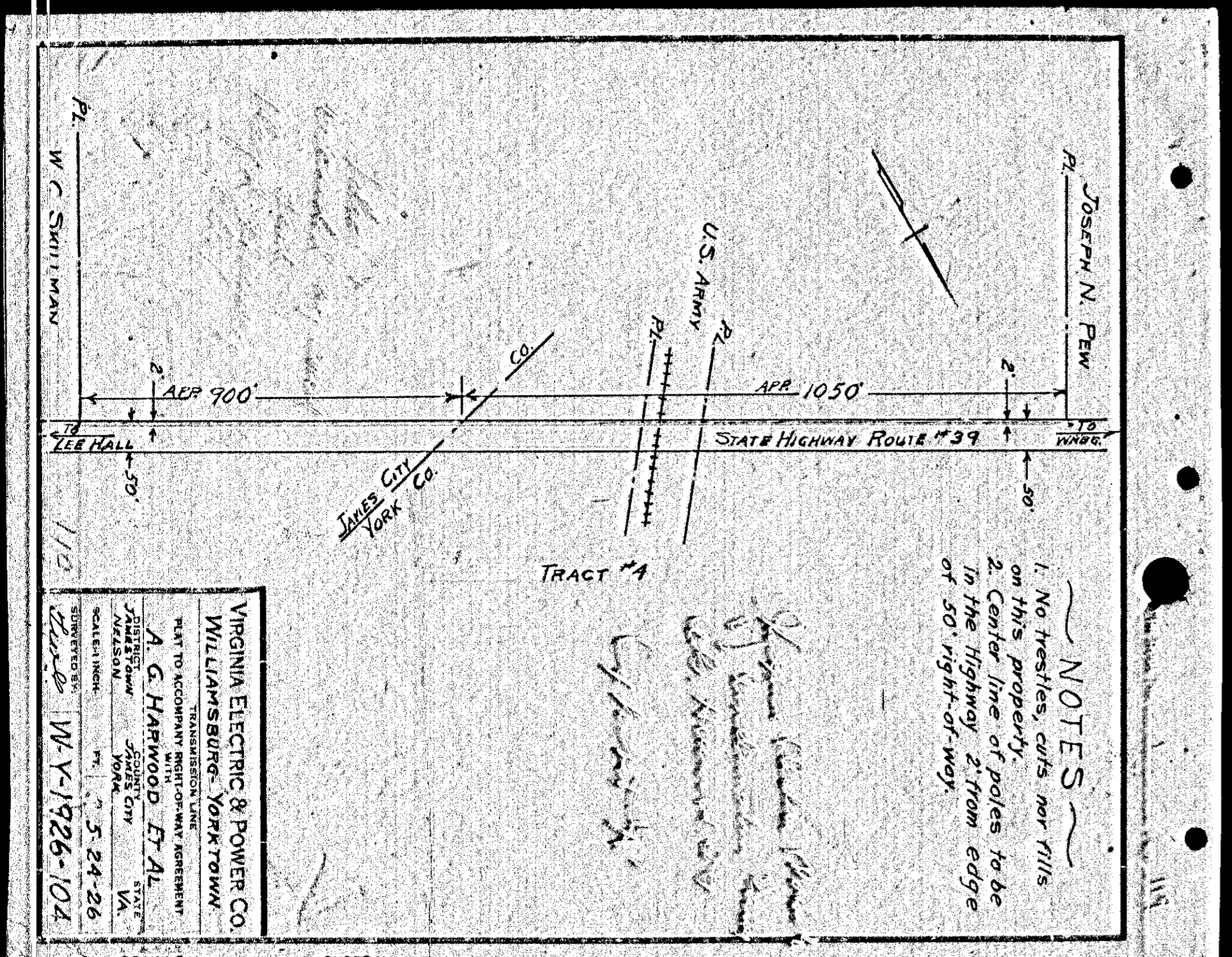

VIRGINIA ELECTRIC & POWER CO.
 Williamsburg - Yorktown
 TRANSMISSION LINE
 PLAT TO ACCOMPANY RIGHT-OF-WAY AGREEMENT
 A. G. HARWOOD ET AL
 JAMES CITY VA
 5-24-26
 W-V-1926-104

NOTES
 1. No hedges, cuts nor fills on this property.
 2. Center line of poles to be in the Highway 2' from edge of 50' right-of-way.

119

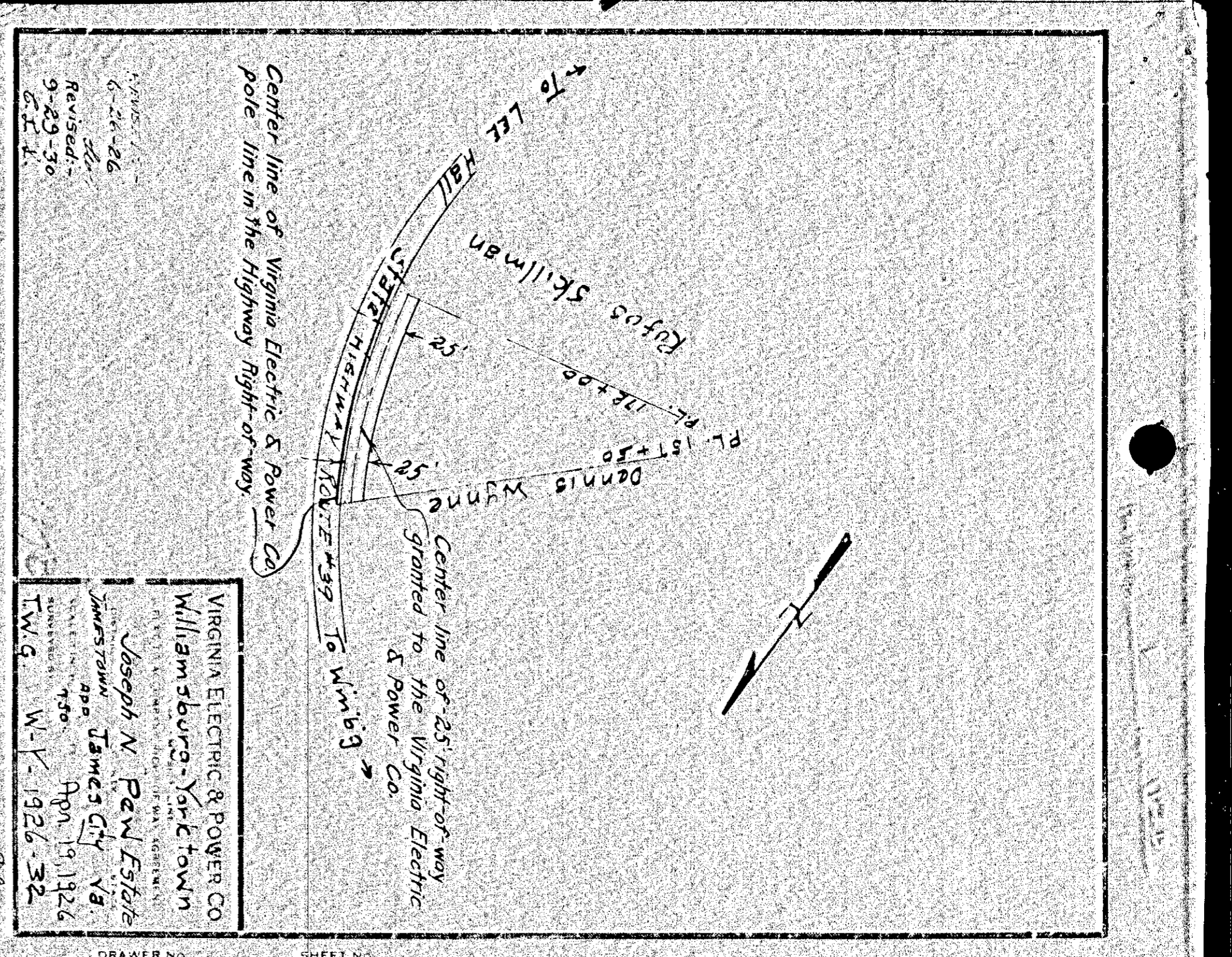

VIRGINIA ELECTRIC & POWER CO.
 Williamsburg - Yorktown
 TRANSMISSION LINE
 PLAT TO ACCOMPANY RIGHT-OF-WAY AGREEMENT
 JOSEPH N. PEW EST.
 JAMES CITY VA
 6-26-26
 W-V-1926-23

VIRGINIA ELECTRIC & POWER CO.
 Williamsburg - Yorktown
 TRANSMISSION LINE
 PLAT TO ACCOMPANY RIGHT-OF-WAY AGREEMENT
 JOSEPH N. PEW EST.
 JAMES CITY VA
 6-26-26
 W-V-1926-23

117B