

VIRGINIA ELECTRIC & POWER CO.  
 WILLIAMSBURG DISTRIBUTION  
 TRANSMISSION LINE  
 PLAT TO ACCOMPANY RIGHT-OF-WAY AGREEMENT  
 WITH  
 JOHN D. ROCKEFELLER JR.  
 DISTRICT  
 COUNTY  
 CITY OF WILLIAMSBURG  
 STATE  
 VA  
 SCALE: 1" = 200'  
 SURVEYED BY  
 D.A.H.  
 FEB. 30, 1934  
 WMBG # 1117

Filed & Recorded  
 Oct 25th 1934  
 Court Holbourn Clerk

Page 250

251  
 252

Page 251

Page 252

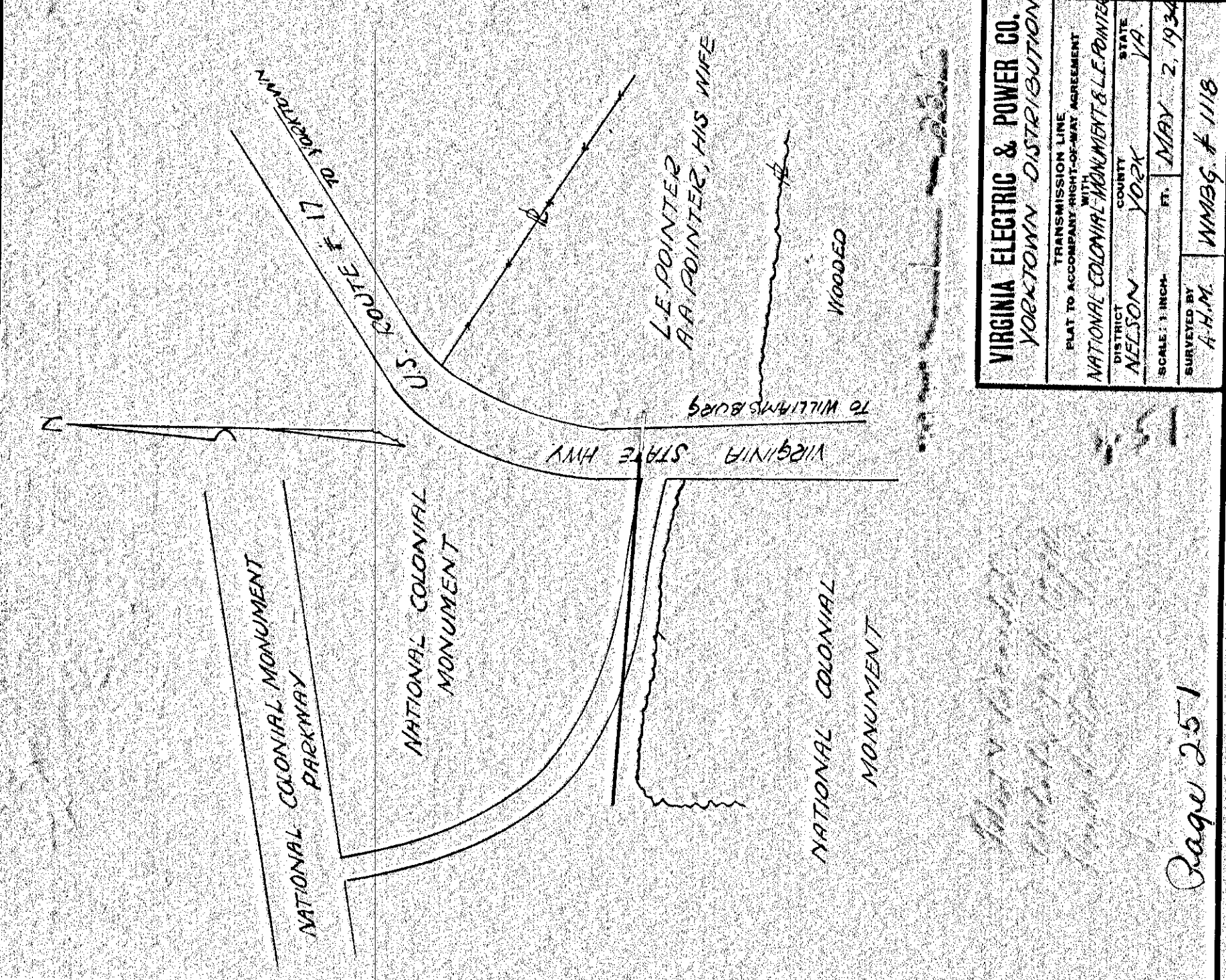

VIRGINIA ELECTRIC & POWER CO.  
 YORKTOWN DISTRIBUTION  
 TRANSMISSION LINE  
 PLAT TO ACCOMPANY RIGHT-OF-WAY AGREEMENT  
 WITH  
 NATIONAL COLONIAL MONUMENT & L.E. POINTER  
 DISTRICT  
 COUNTY  
 YORK  
 STATE  
 VA  
 SCALE: 1" = 100'  
 SURVEYED BY  
 A.H.M.  
 MAY 2, 1934  
 WMBG # 1118

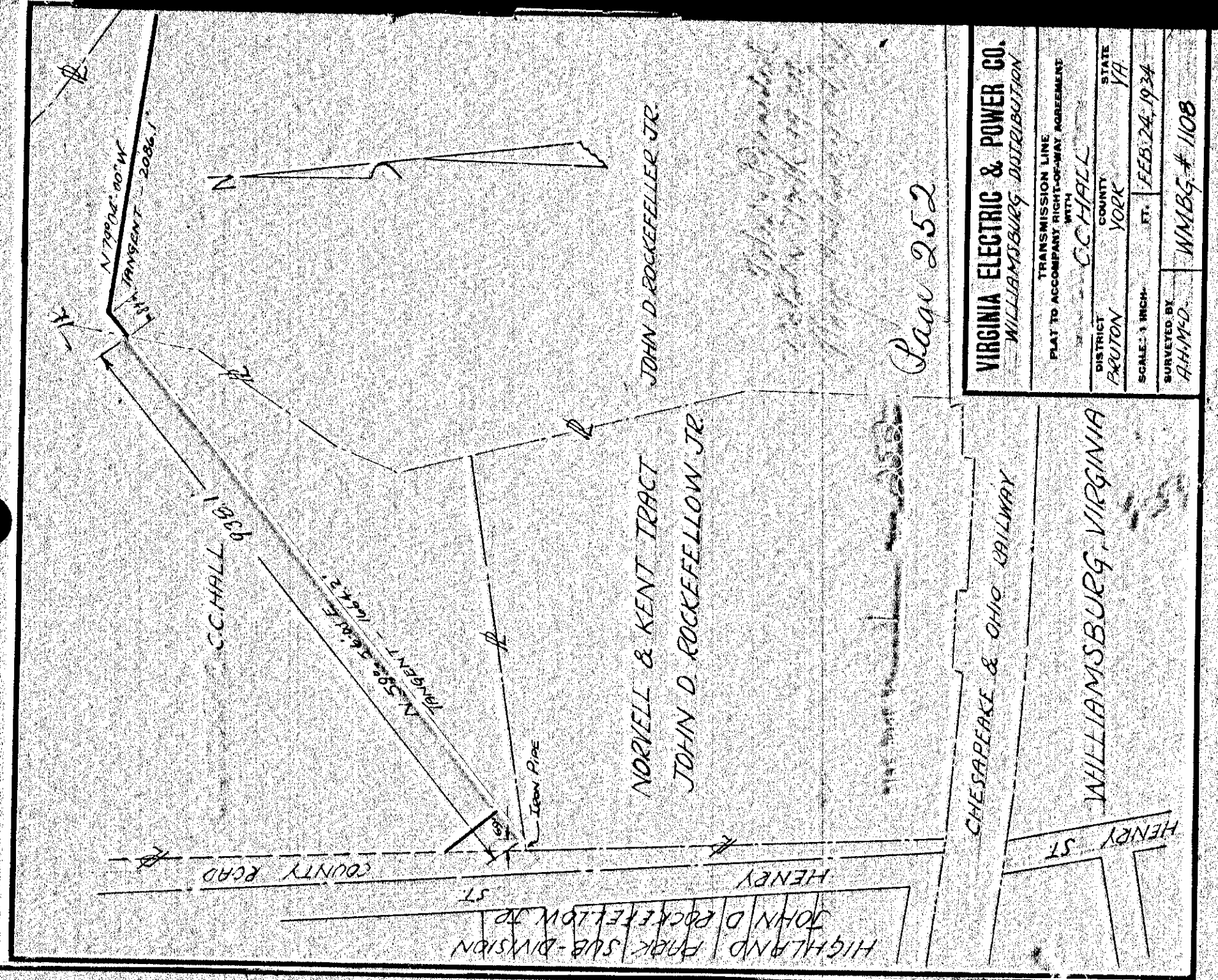

VIRGINIA ELECTRIC & POWER CO.  
 WILLIAMSBURG DISTRIBUTION  
 TRANSMISSION LINE  
 PLAT TO ACCOMPANY RIGHT-OF-WAY AGREEMENT  
 WITH  
 C.C. HALL  
 DISTRICT  
 COUNTY  
 YORK  
 STATE  
 VA  
 SCALE: 1" = 100'  
 SURVEYED BY  
 A.H.M.  
 FEB. 24, 1934  
 WMBG # 1108