

Filed Aug 10, 1937
 Plat Book 1, Page 313
 Recd Recorded Book
 51 at Page
 Floyd Holloway

VIRGINIA ELECTRIC & POWER CO.
 WILLIAMSBURG DISTRIBUTION
 PLAT TO ACCOMPANY RIGHT-OF-WAY AGREEMENT
 AS SHOWN
 COUNTY YORK STATE VIRGINIA
 SCALE: 1 INCH = 100 FT. JAN-15-1937
 SURVEYED BY F.B.S. WMBG-1250

313

315

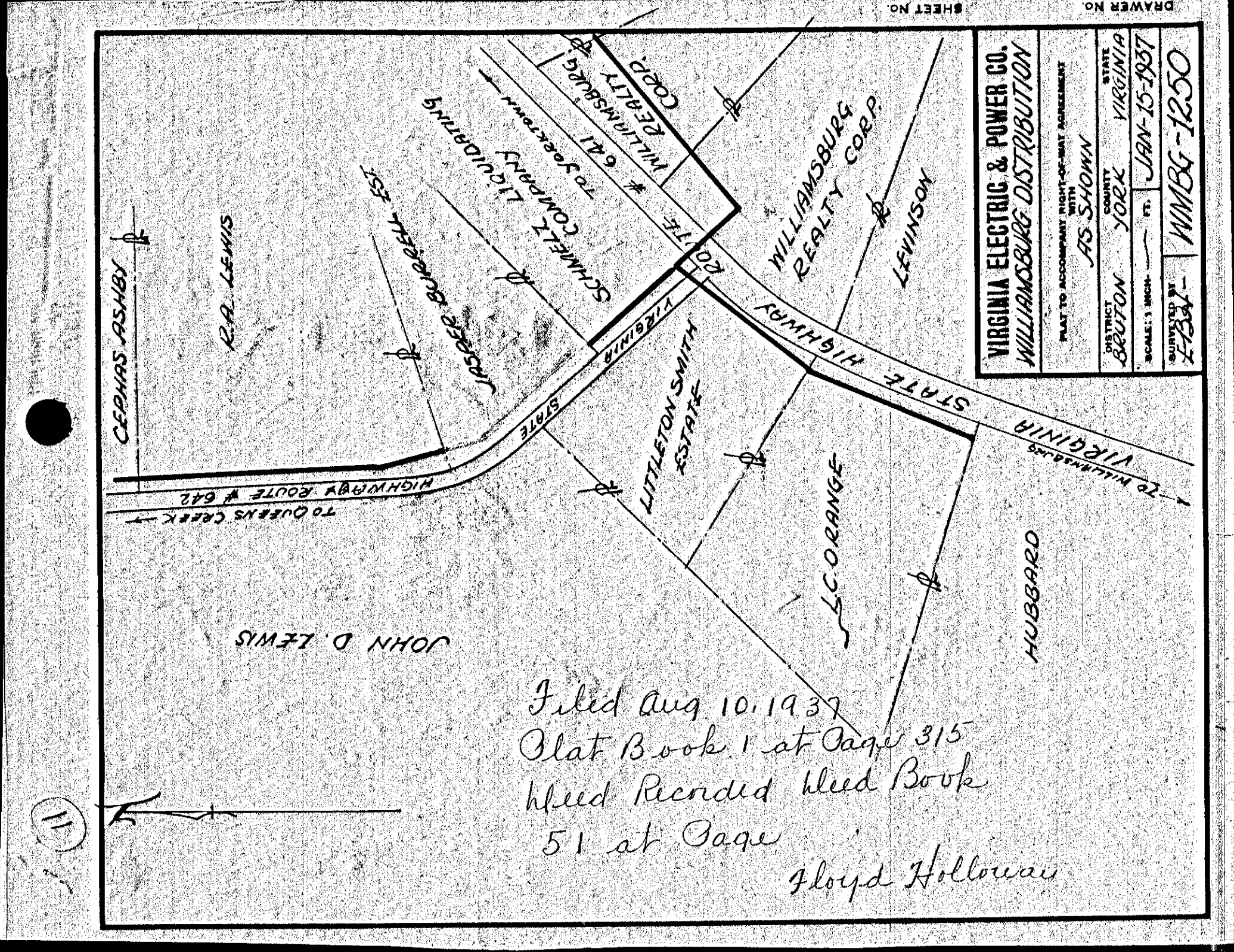

Filed Aug 10, 1937
 Plat Book 1 at Page 315
 Recd Recorded Book
 51 at Page
 Floyd Holloway

VIRGINIA ELECTRIC & POWER CO.
 WILLIAMSBURG DISTRIBUTION
 PLAT TO ACCOMPANY RIGHT-OF-WAY AGREEMENT
 AS SHOWN
 COUNTY YORK STATE VIRGINIA
 SCALE: 1 INCH = 100 FT. JAN-15-1937
 SURVEYED BY F.B.S. WMBG-1250

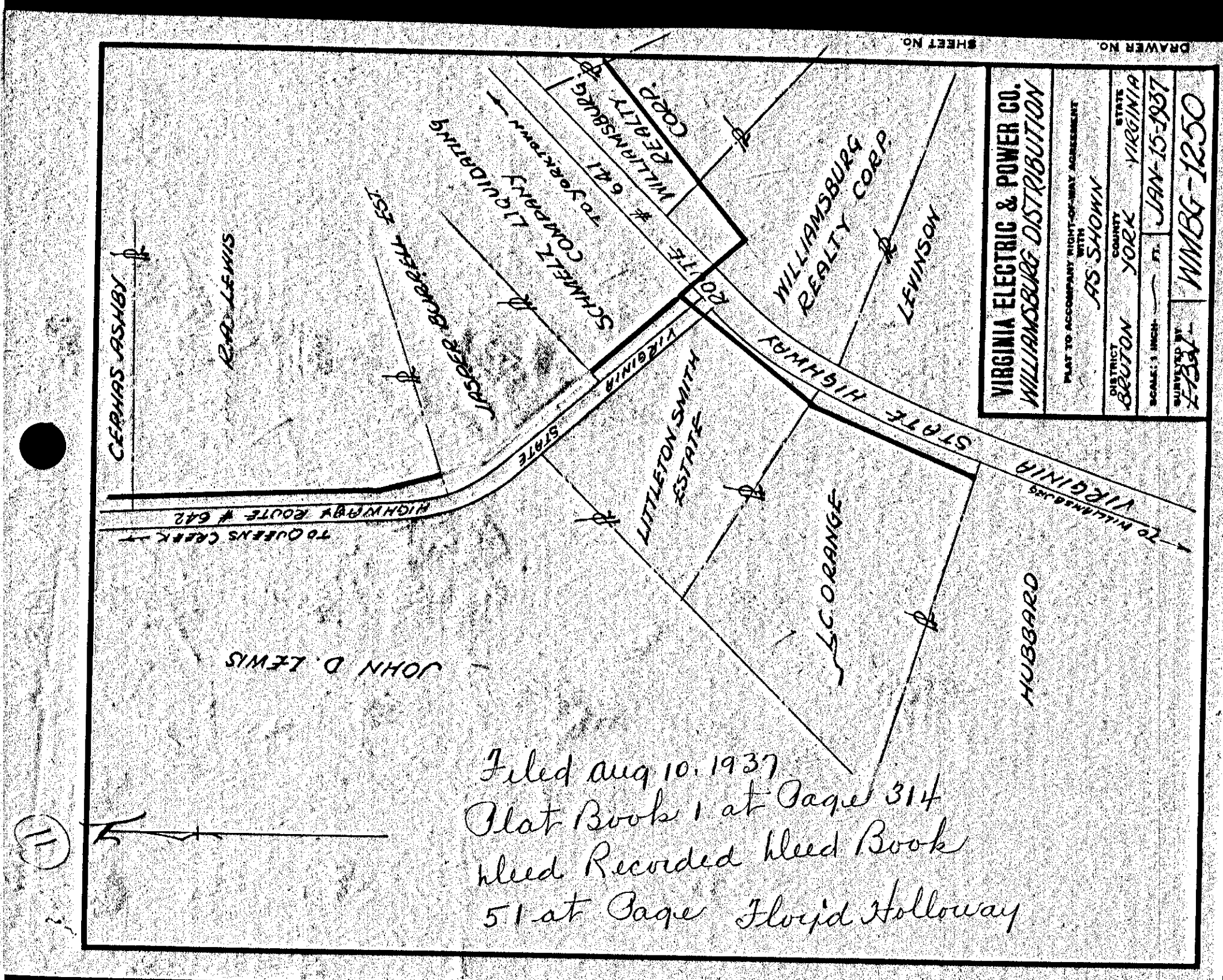

Filed Aug 10, 1937
 Plat Book 1 at Page 314
 Recd Recorded Book
 51 at Page
 Floyd Holloway

VIRGINIA ELECTRIC & POWER CO.
 WILLIAMSBURG DISTRIBUTION
 PLAT TO ACCOMPANY RIGHT-OF-WAY AGREEMENT
 AS SHOWN
 COUNTY YORK STATE VIRGINIA
 SCALE: 1 INCH = 100 FT. JAN-15-1937
 SURVEYED BY F.B.S. WMBG-1250

314

316

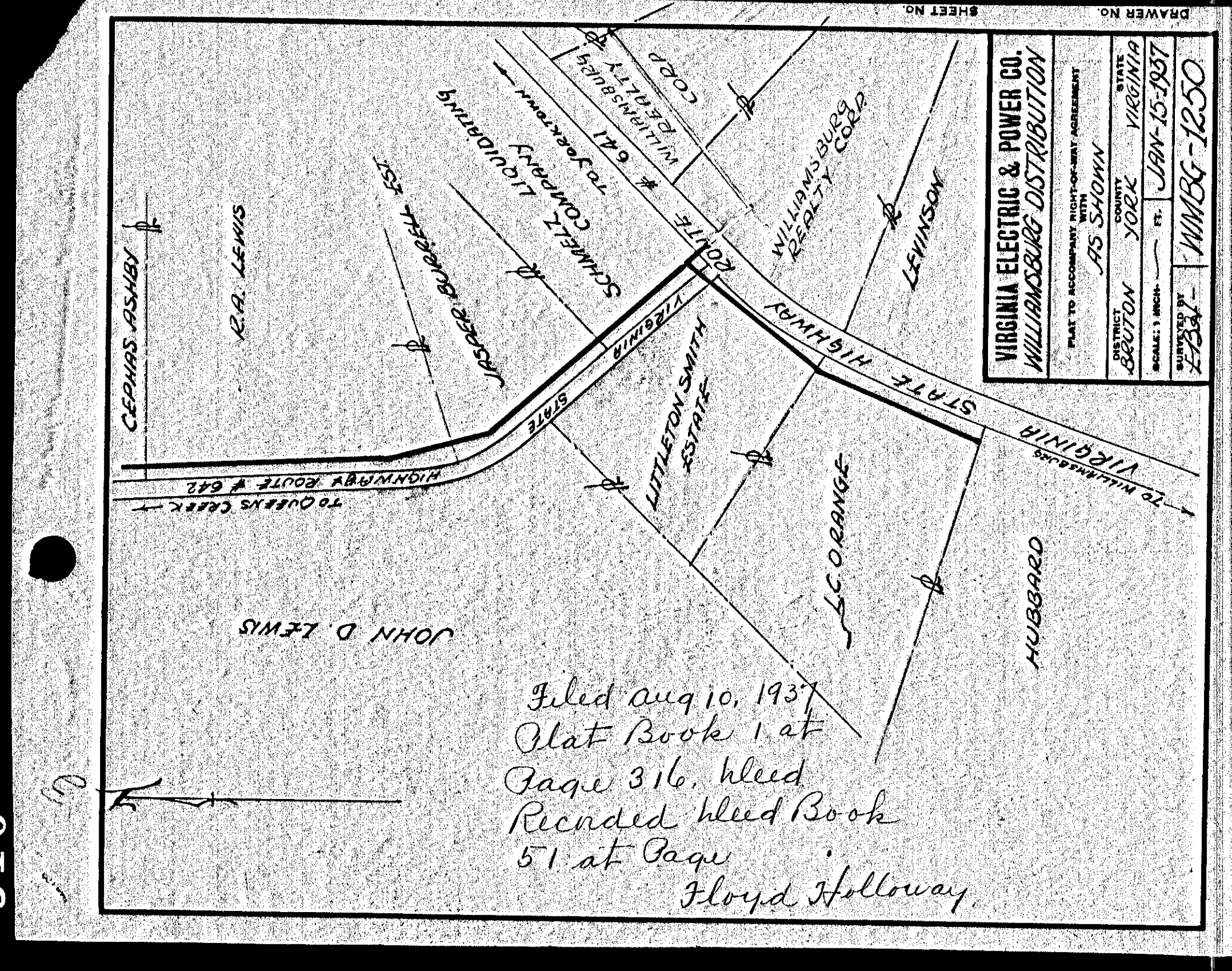

Filed Aug 10, 1937
 Plat Book 1 at
 Page 316, Recd
 Recorded Book
 51 at Page
 Floyd Holloway

VIRGINIA ELECTRIC & POWER CO.
 WILLIAMSBURG DISTRIBUTION
 PLAT TO ACCOMPANY RIGHT-OF-WAY AGREEMENT
 AS SHOWN
 COUNTY YORK STATE VIRGINIA
 SCALE: 1 INCH = 100 FT. JAN-15-1937
 SURVEYED BY F.B.S. WMBG-1250