

PLAT OF 2 ACRE LOT CONVEYED TO EDWARD A. PASCALL BY JOE DABNEY HEIRS SITUATED IN NELSON DISTRICT, YORK COUNTY, VIRGINIA. SCALE 1" = 40 FT. SURVEYED SEPT. 10 1938
F. G. Parthing
 CERTIFIED LAND SURVEYOR

The bleed of this Plat is Recorded in bleed Book 53 Page 92.

369

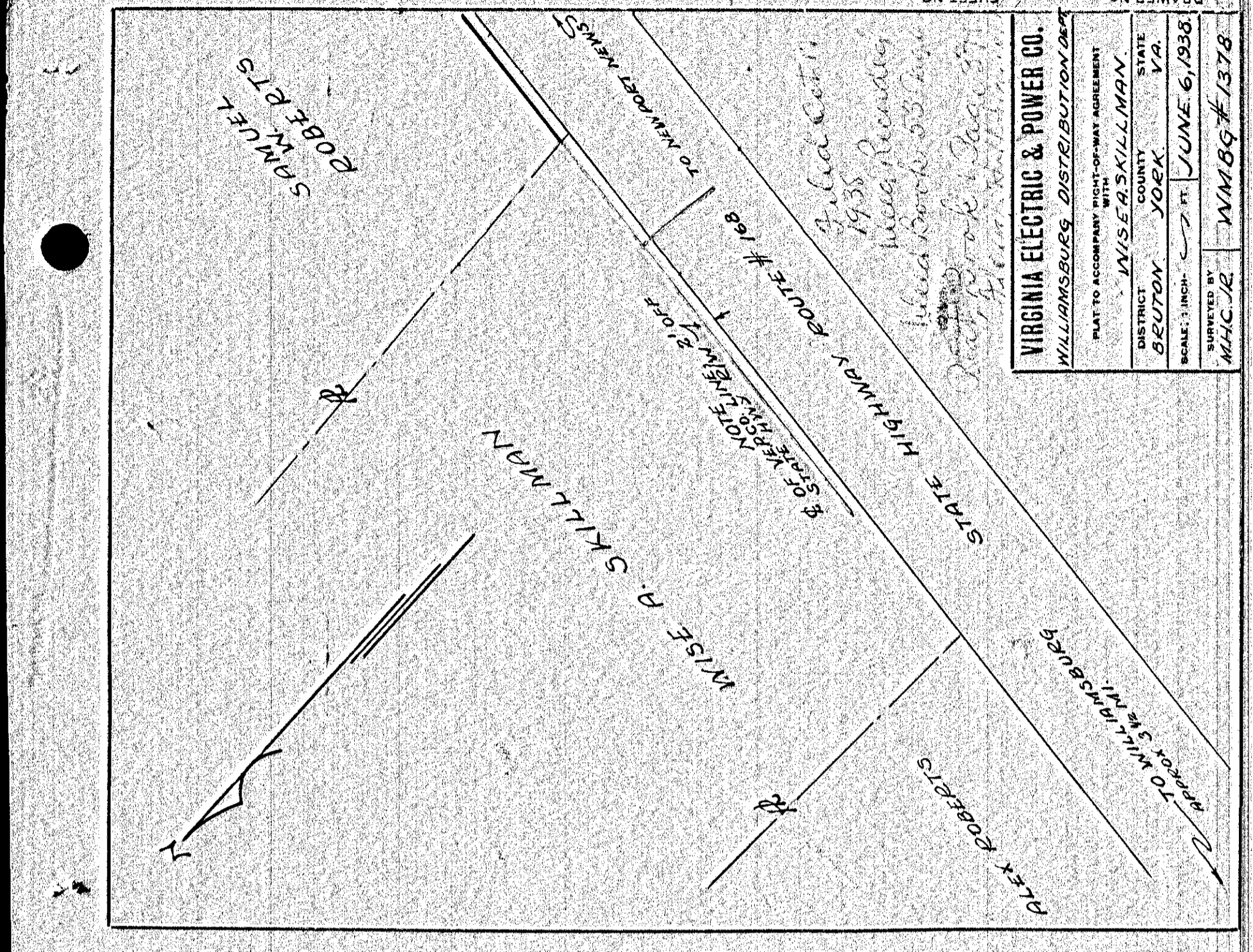

VIRGINIA ELECTRIC & POWER CO. WILLIAMSBURG DISTRIBUTION DEPT. PLAT TO ACCOMPANY RIGHT-OF-WAY AGREEMENT WITH AS SHOWN STATE COUNTY YORK VA DISTRICT BEUTON YOEK SCALE: 1" = 40 FT. SURVEYED BY MHC JR. WMBG # 1375

Filed Oct. 17, 1938
 Wiser A. Skillman
 Wiser Book 53
 Page 80
 Great Plat
 Book, Page 370
 Floyd Skillman

028

128

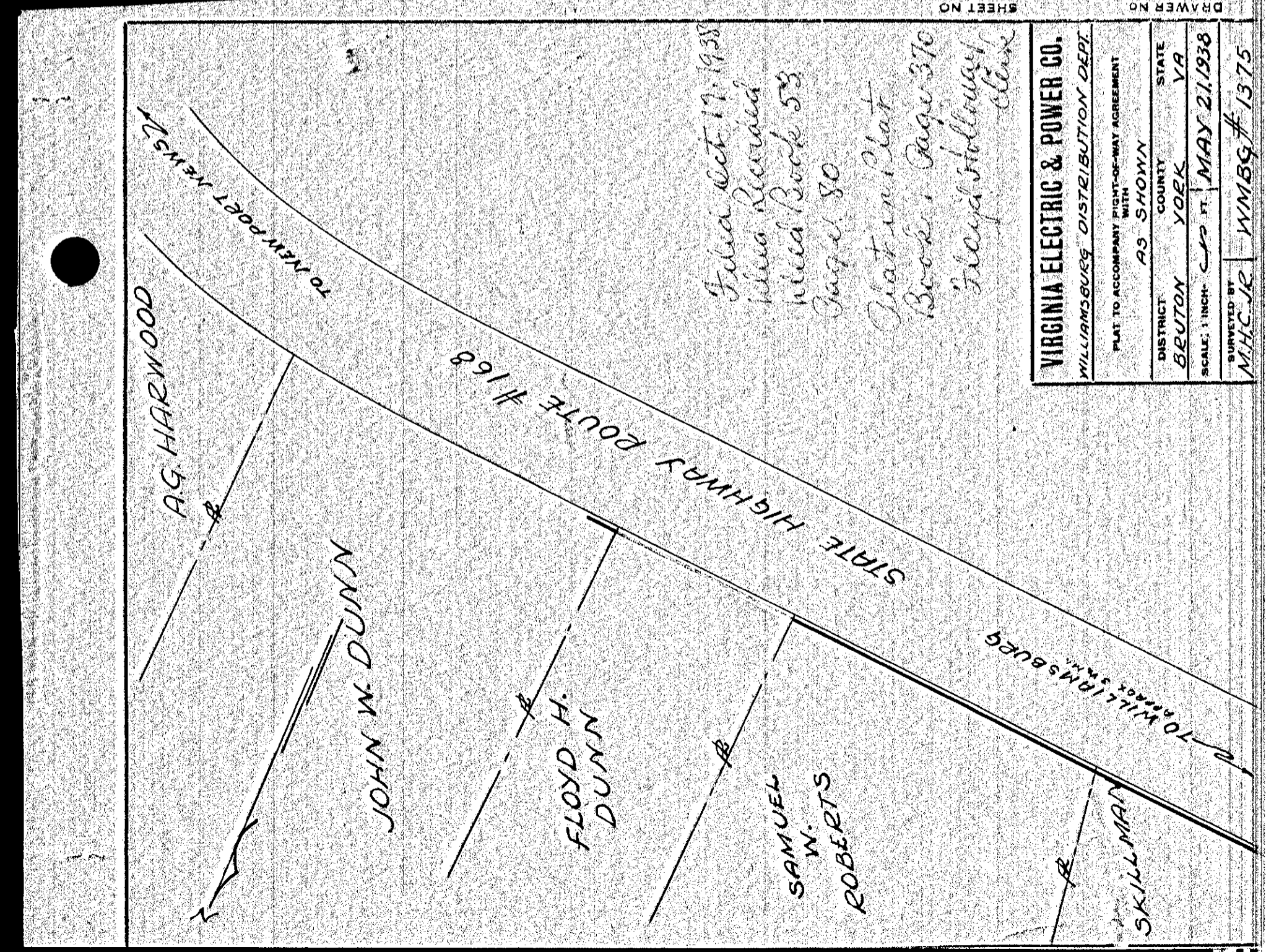

VIRGINIA ELECTRIC & POWER CO. WILLIAMSBURG DISTRIBUTION DEPT. PLAT TO ACCOMPANY RIGHT-OF-WAY AGREEMENT WITH AS SHOWN STATE COUNTY YORK VA DISTRICT BEUTON YOEK SCALE: 1" = 40 FT. SURVEYED BY MHC JR. WMBG # 1375

Filed Oct. 17, 1938
 Wiser A. Skillman
 Wiser Book 53
 Page 80
 Great Plat
 Book, Page 370
 Floyd Skillman