

Page 404
 Filed May 16, 1938
 Deed Recorded
 Deed Book No. 53, Page 47
 Floyd Holloway, Clerk

PLAT TO ACCOMPANY RIGHT-OF-WAY AGREEMENT
 AS SHOWN
 DISTRICT COUNTY STATE
 CITY OF WILLIAMSBURG VA
 SCALE: 1 INCH = 40 FT. DEC. 8, 1938.
 DRAWN BY *WMBG* NMBG.1405

404

406

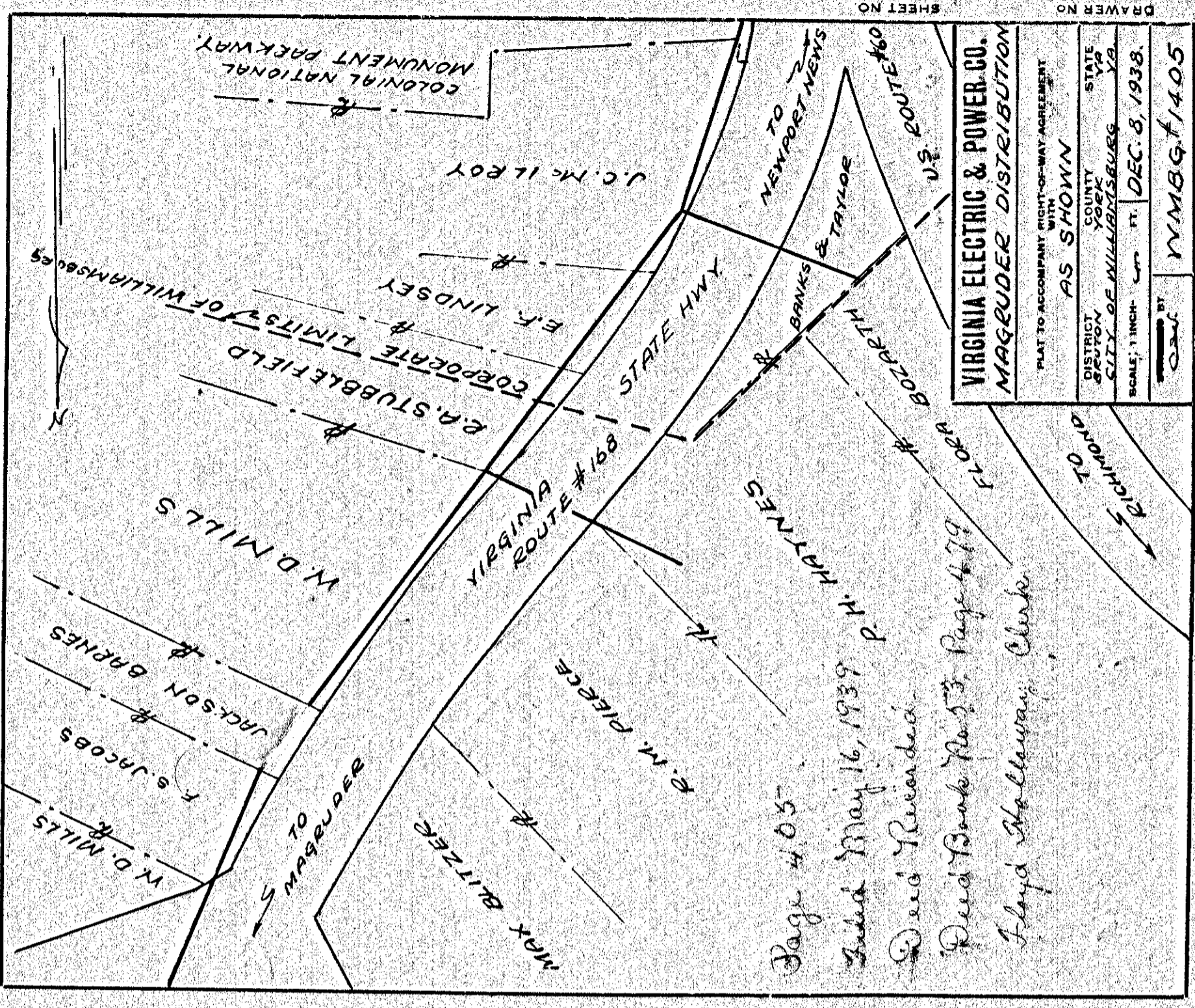

Page 405
 Filed May 16, 1938
 Deed Recorded
 Deed Book No. 53, Page 49
 Floyd Holloway, Clerk

PLAT TO ACCOMPANY RIGHT-OF-WAY AGREEMENT
 AS SHOWN
 DISTRICT COUNTY STATE
 CITY OF WILLIAMSBURG VA
 SCALE: 1 INCH = 40 FT. DEC. 8, 1938.
 DRAWN BY *WMBG* NMBG.1405

405

407

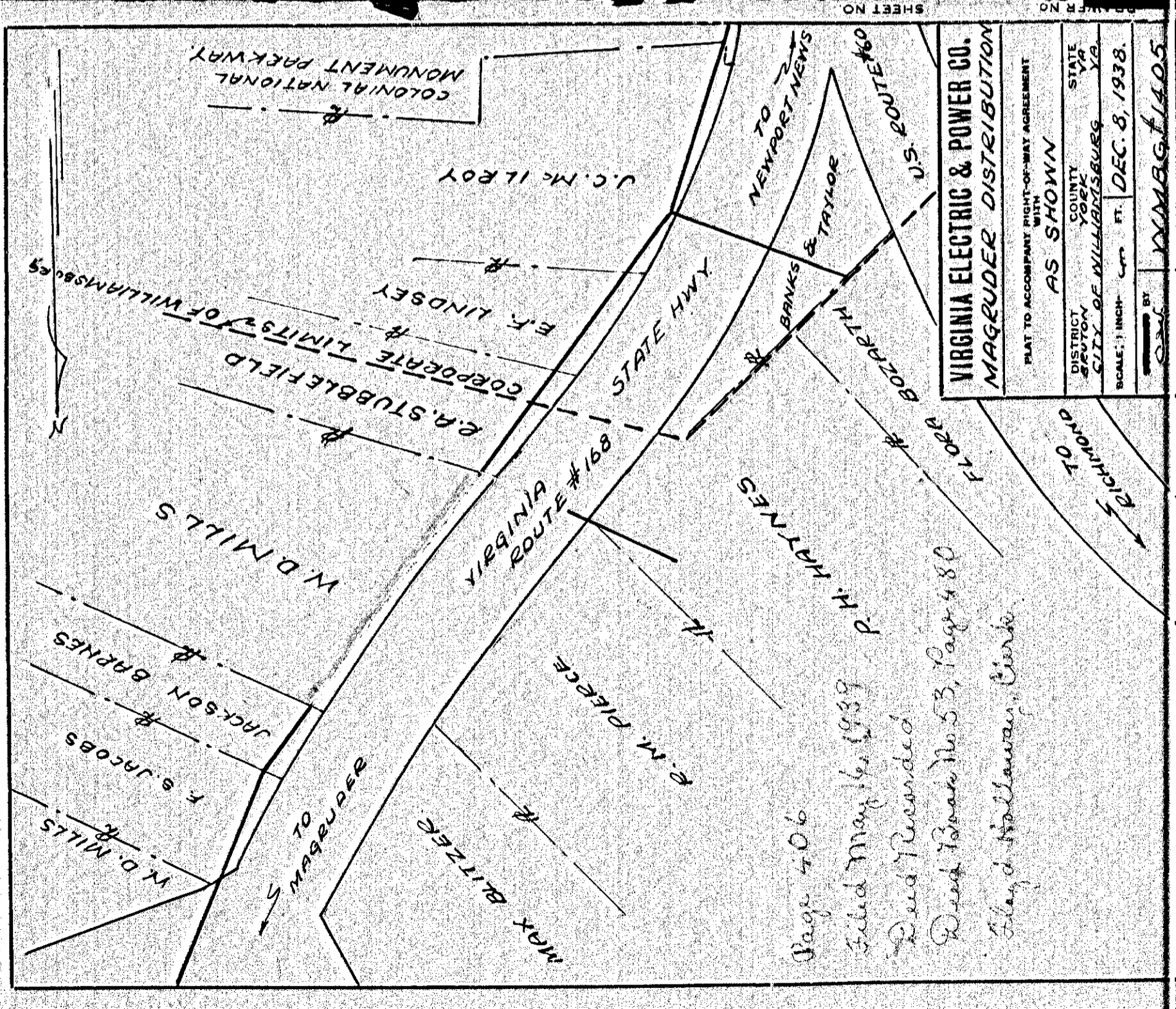

Page 406
 Filed May 16, 1938
 Deed Recorded
 Deed Book No. 53, Page 48
 Floyd Holloway, Clerk

PLAT TO ACCOMPANY RIGHT-OF-WAY AGREEMENT
 AS SHOWN
 DISTRICT COUNTY STATE
 CITY OF WILLIAMSBURG VA
 SCALE: 1 INCH = 40 FT. DEC. 8, 1938.
 DRAWN BY *WMBG* NMBG.1405

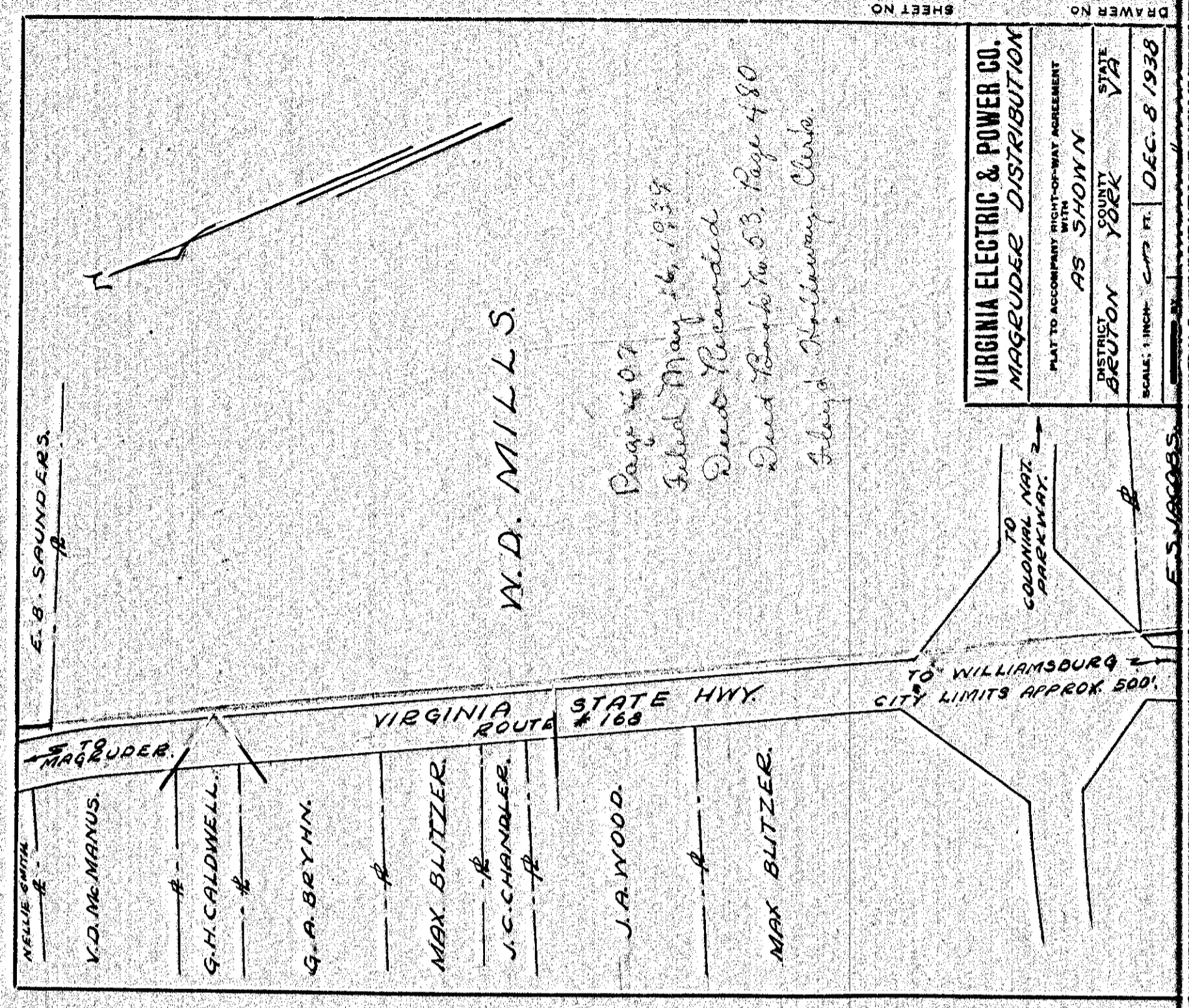

Page 407
 Filed May 16, 1938
 Deed Recorded
 Deed Book No. 53, Page 48
 Floyd Holloway, Clerk

PLAT TO ACCOMPANY RIGHT-OF-WAY AGREEMENT
 AS SHOWN
 DISTRICT COUNTY STATE
 CITY OF WILLIAMSBURG VA
 SCALE: 1 INCH = 40 FT. DEC. 8, 1938.
 DRAWN BY *WMBG* NMBG.1405

DRAWER NO. SHEET NO.