

Made July 5, 1939
 Deed Recorded
 Deed 13 vols No 53 page 587
 Lloyd McFest, Clerk
 YORK RIVER

VIRGINIA ELECTRIC & POWER CO.			
YORKTOWN DISTRIBUTION			
PLAT TO ACCOMPANY RIGHT-OF-WAY AGREEMENT			
DISTRICT	AS	COUNTY	SAWYIN
NELSON	YORK	STATE	VA
SCALE: 1 INCH = 50 FT.		DATE	MAY 18, 1939
DESIGNED BY	W.M.B.G.	DRAWN BY	W.M.B.G. # 1462

DRAWER NO. SHEET NO.

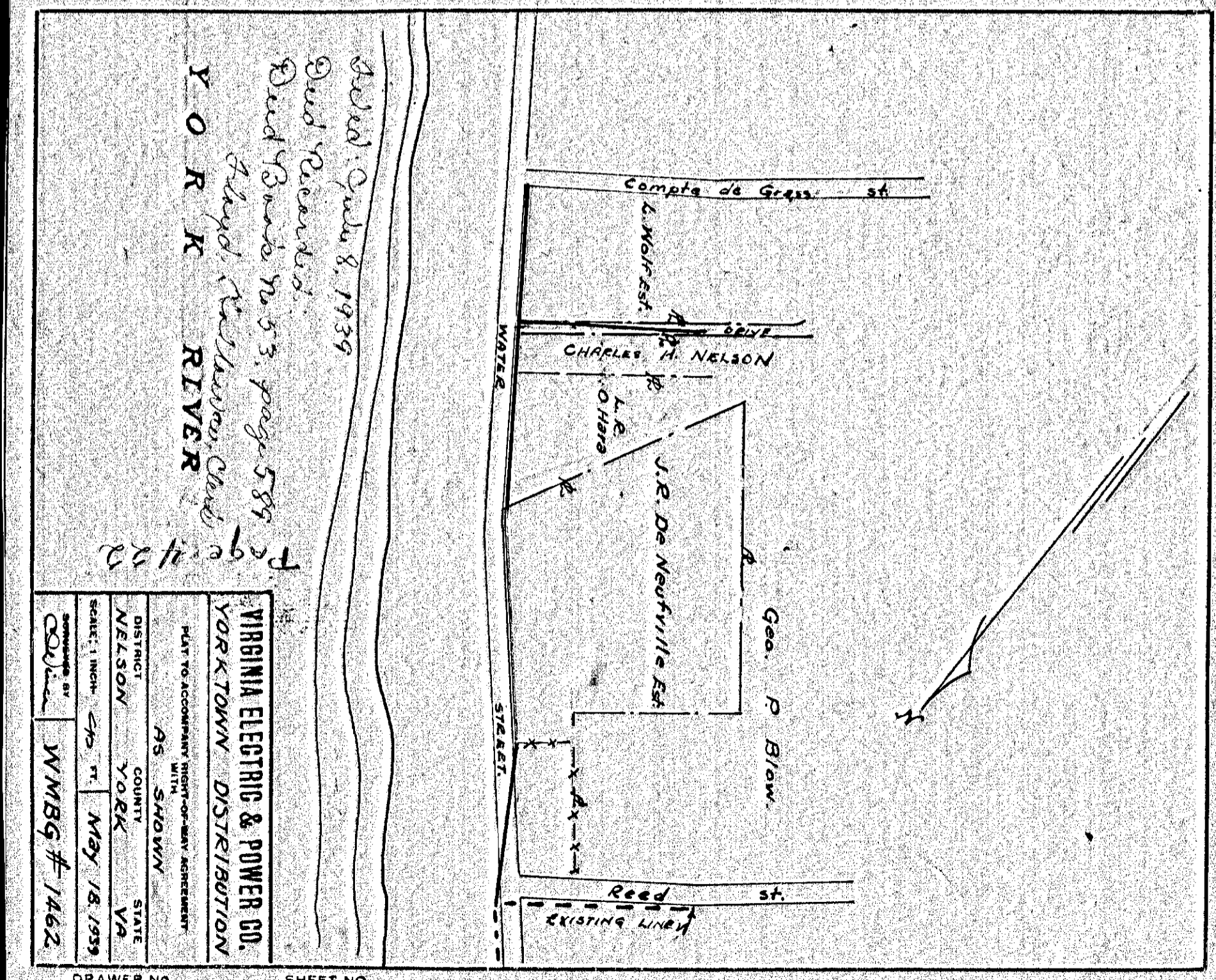

Made July 8, 1939
 Deed Recorded
 Deed 13 vols No 53, page 589
 Lloyd McFest, Clerk
 YORK RIVER

VIRGINIA ELECTRIC & POWER CO.			
YORKTOWN DISTRIBUTION			
PLAT TO ACCOMPANY RIGHT-OF-WAY AGREEMENT			
DISTRICT	AS	COUNTY	SAWYIN
NELSON	YORK	STATE	VA
SCALE: 1 INCH = 50 FT.		DATE	MAY 18, 1939
DESIGNED BY	W.M.B.G.	DRAWN BY	W.M.B.G. # 1462

DRAWER NO. SHEET NO.

4221

4222

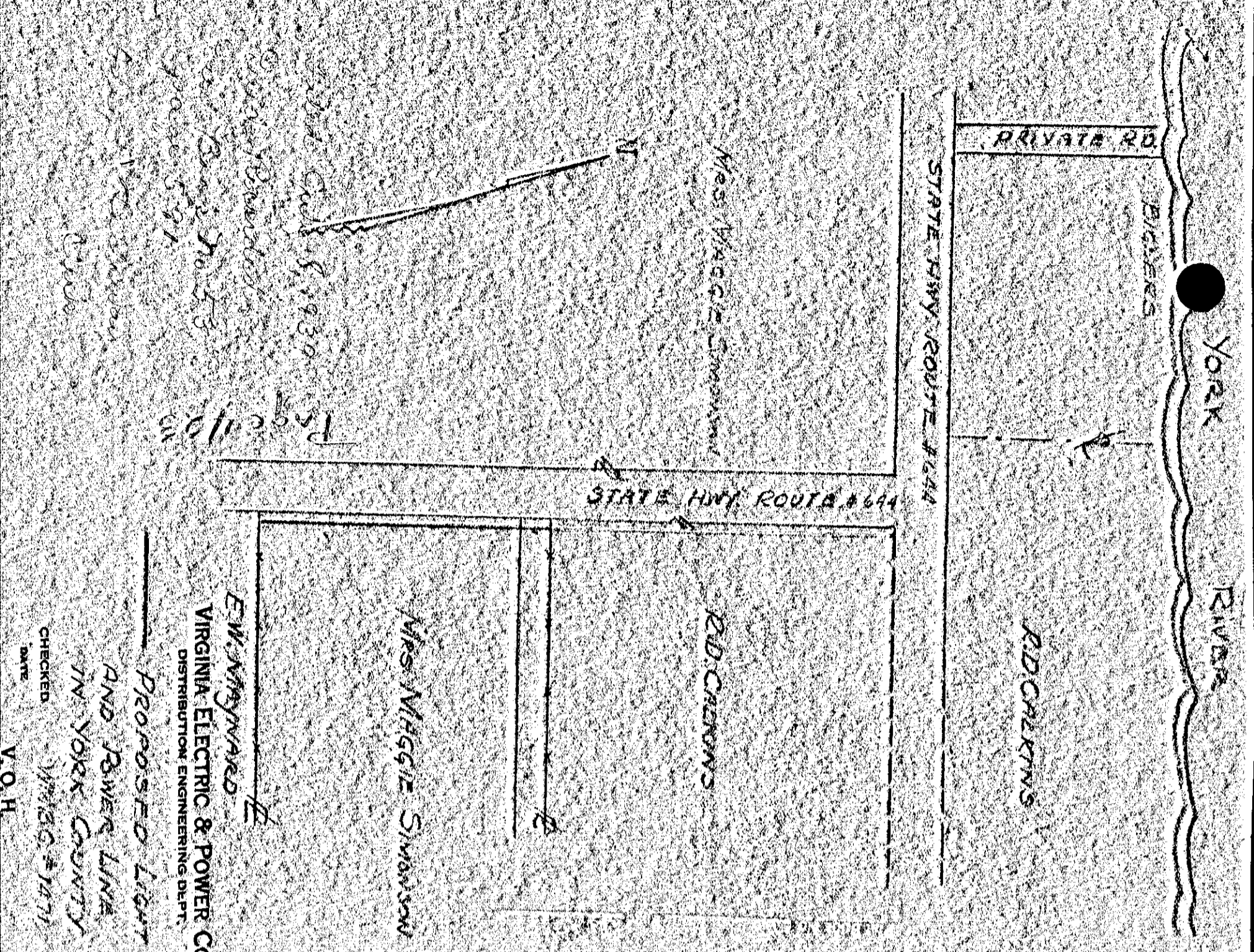

Made July 8, 1939
 Deed Recorded
 Deed 13 vols No 53
 Lloyd McFest, Clerk
 YORK RIVER

VIRGINIA ELECTRIC & POWER CO.			
YORKTOWN DISTRIBUTION			
PLAT TO ACCOMPANY RIGHT-OF-WAY AGREEMENT			
DISTRICT	AS	COUNTY	SAWYIN
NELSON	YORK	STATE	VA
SCALE: 1 INCH = 50 FT.		DATE	MAY 18, 1939
DESIGNED BY	W.M.B.G.	DRAWN BY	W.M.B.G. # 1462

DRAWER NO. SHEET NO.

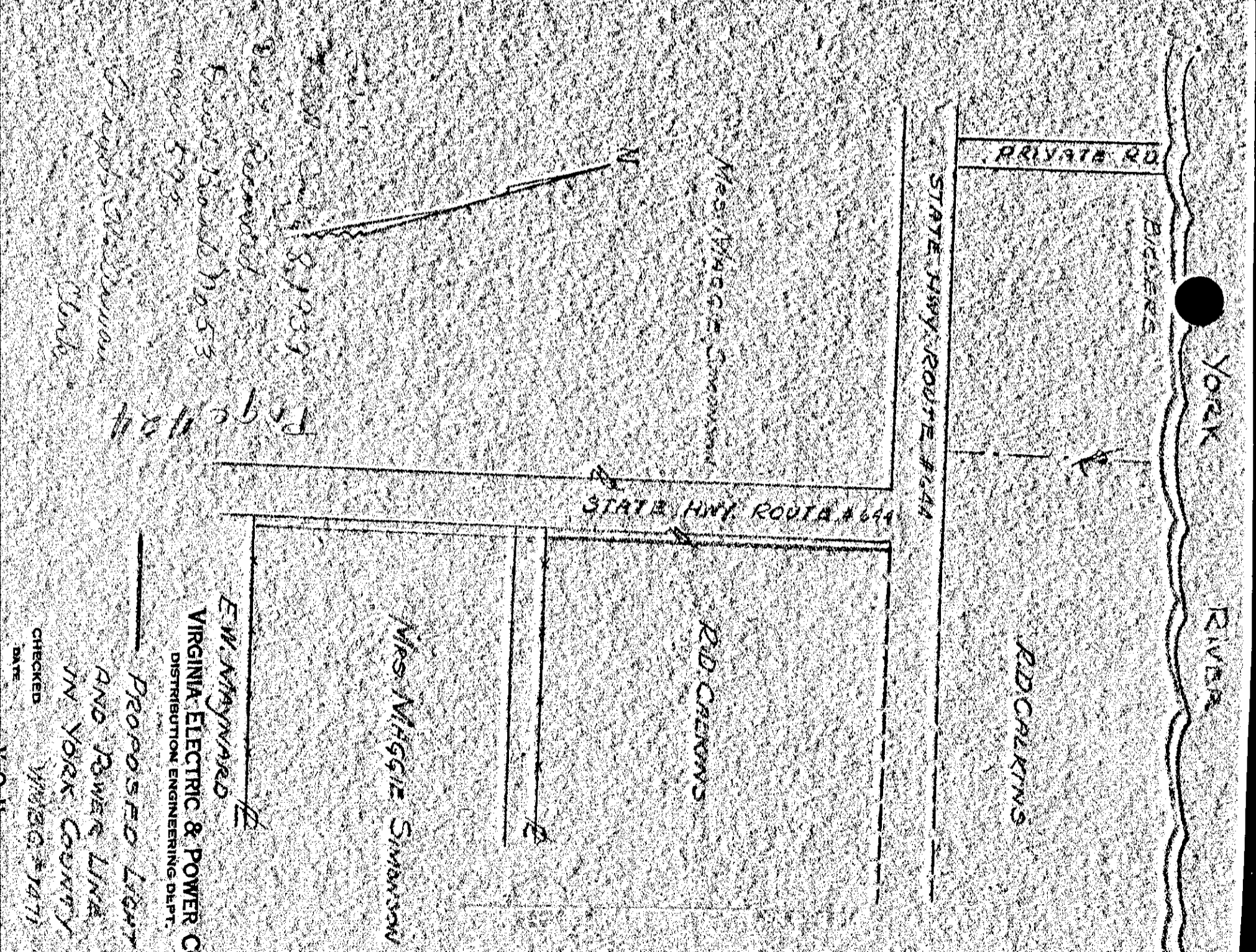

Made July 8, 1939
 Deed Recorded
 Deed 13 vols No 53
 Lloyd McFest, Clerk
 YORK RIVER

VIRGINIA ELECTRIC & POWER CO.			
YORKTOWN DISTRIBUTION			
PLAT TO ACCOMPANY RIGHT-OF-WAY AGREEMENT			
DISTRICT	AS	COUNTY	SAWYIN
NELSON	YORK	STATE	VA
SCALE: 1 INCH = 50 FT.		DATE	MAY 18, 1939
DESIGNED BY	W.M.B.G.	DRAWN BY	W.M.B.G. # 1462

DRAWER NO. SHEET NO.

4223

4224