

VIRGINIA ELECTRIC & POWER CO.
DISTRIBUTION ENGINEERING DEPT.

PLAT TO ACCOMPANY RIGHT-OF-WAY AGREEMENT WITH

| | |
|------------------|------------|
| DISTRICT | AS SHOWN |
| COUNTY | SHOWA |
| STATE | VA |
| DISTRICT | BRUTON |
| COUNTY | YORK |
| STATE | VA |
| SCALE: 1" = 100' | |
| SUBMITTED BY | WMBG #1485 |
| DATE | 1/23/39 |

Handwritten notes:
 Sold Sept 22, 1939
 D.B. # 54 pages 133
 D.B. # 54 pages 133
 D.B. # 54 pages 133

PAGE 431

DRAWER NO. SHEET NO.

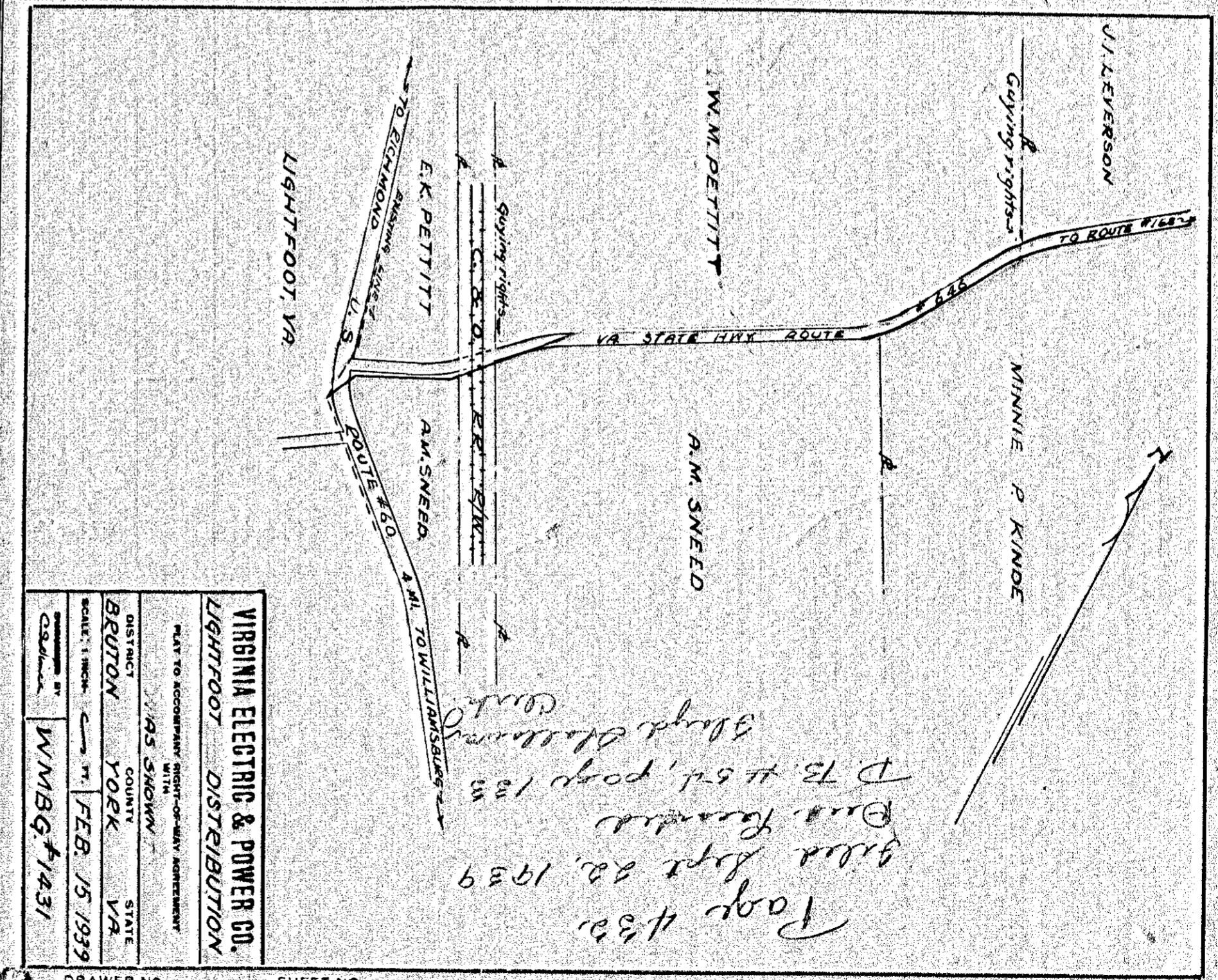

VIRGINIA ELECTRIC & POWER CO.
LIGHTFOOT DISTRIBUTION

PLAT TO ACCOMPANY RIGHT-OF-WAY AGREEMENT WITH

| | |
|------------------|-------------|
| DISTRICT | AS SHOWN |
| COUNTY | SHOWA |
| STATE | VA |
| DISTRICT | BRUTON |
| COUNTY | YORK |
| STATE | VA |
| SCALE: 1" = 100' | |
| SUBMITTED BY | WMBG #1431 |
| DATE | FEB 15 1939 |

Handwritten notes:
 Page 432
 Sold Sept 22, 1939
 D.B. # 54, page 133
 D.B. # 54, page 133
 D.B. # 54, page 133

DRAWER NO. SHEET NO.

431

432

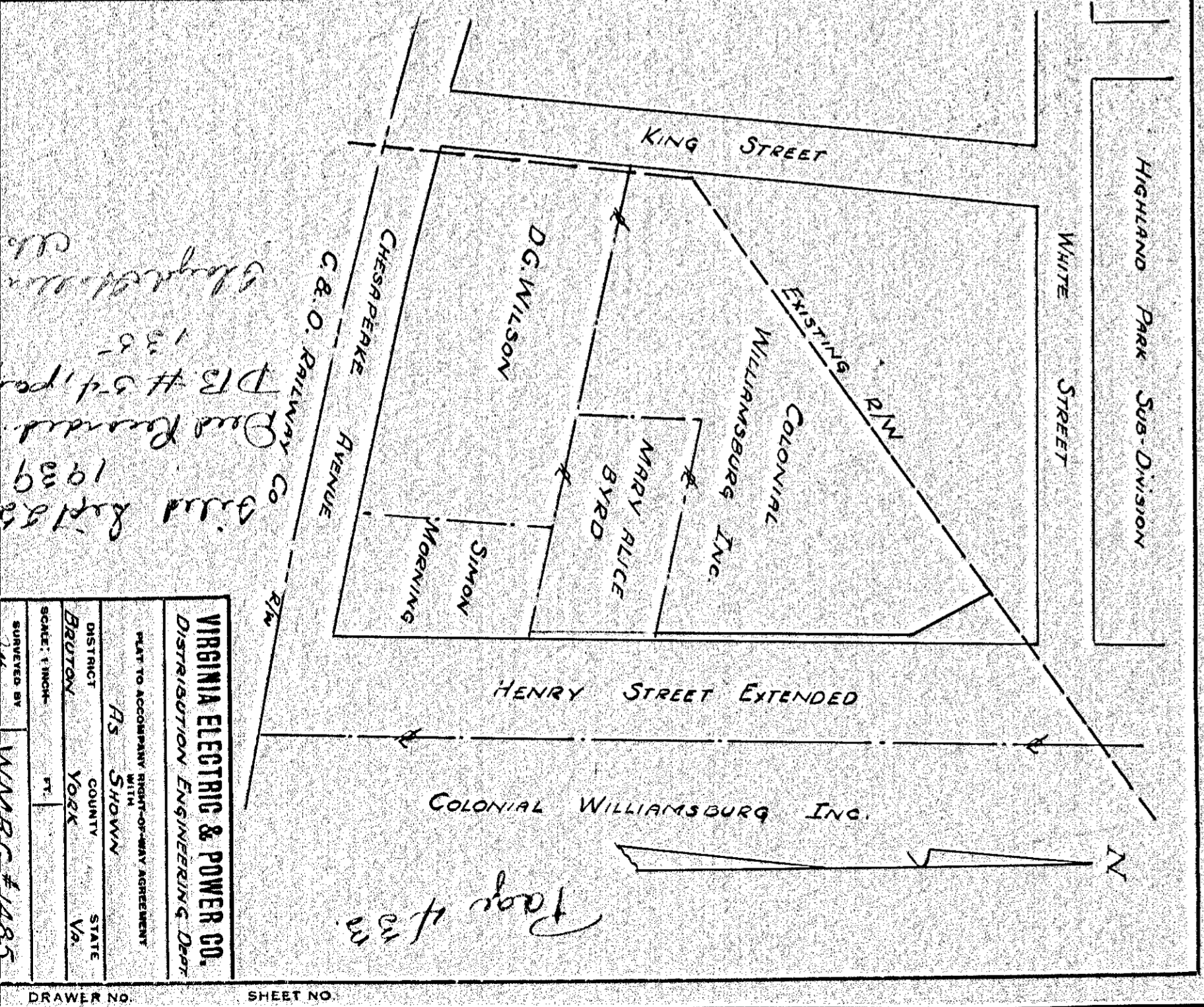

VIRGINIA ELECTRIC & POWER CO.
DISTRIBUTION ENGINEERING DEPT.

PLAT TO ACCOMPANY RIGHT-OF-WAY AGREEMENT WITH

| | |
|------------------|------------|
| DISTRICT | AS SHOWN |
| COUNTY | SHOWA |
| STATE | VA |
| DISTRICT | BRUTON |
| COUNTY | YORK |
| STATE | VA |
| SCALE: 1" = 100' | |
| SUBMITTED BY | WMBG #1485 |
| DATE | 1/23/39 |

Handwritten notes:
 Sold Sept 22, 1939
 D.B. # 54, page 133
 D.B. # 54, page 133
 D.B. # 54, page 133

PAGE 433

DRAWER NO. SHEET NO.

433