

VIRGINIA ELECTRIC & POWER CO.
 Johnson Extension
 PLAT TO ACCOMPANY RIGHT-OF-WAY AGREEMENT
 WITH
 AS SHOWN
 DISTRICT COUNTY STATE
 BRUNTON YORK VA
 SCALE: 1"=100'
 C.W.L. WMBG # 1511

DRAWER NO. SHEET NO.

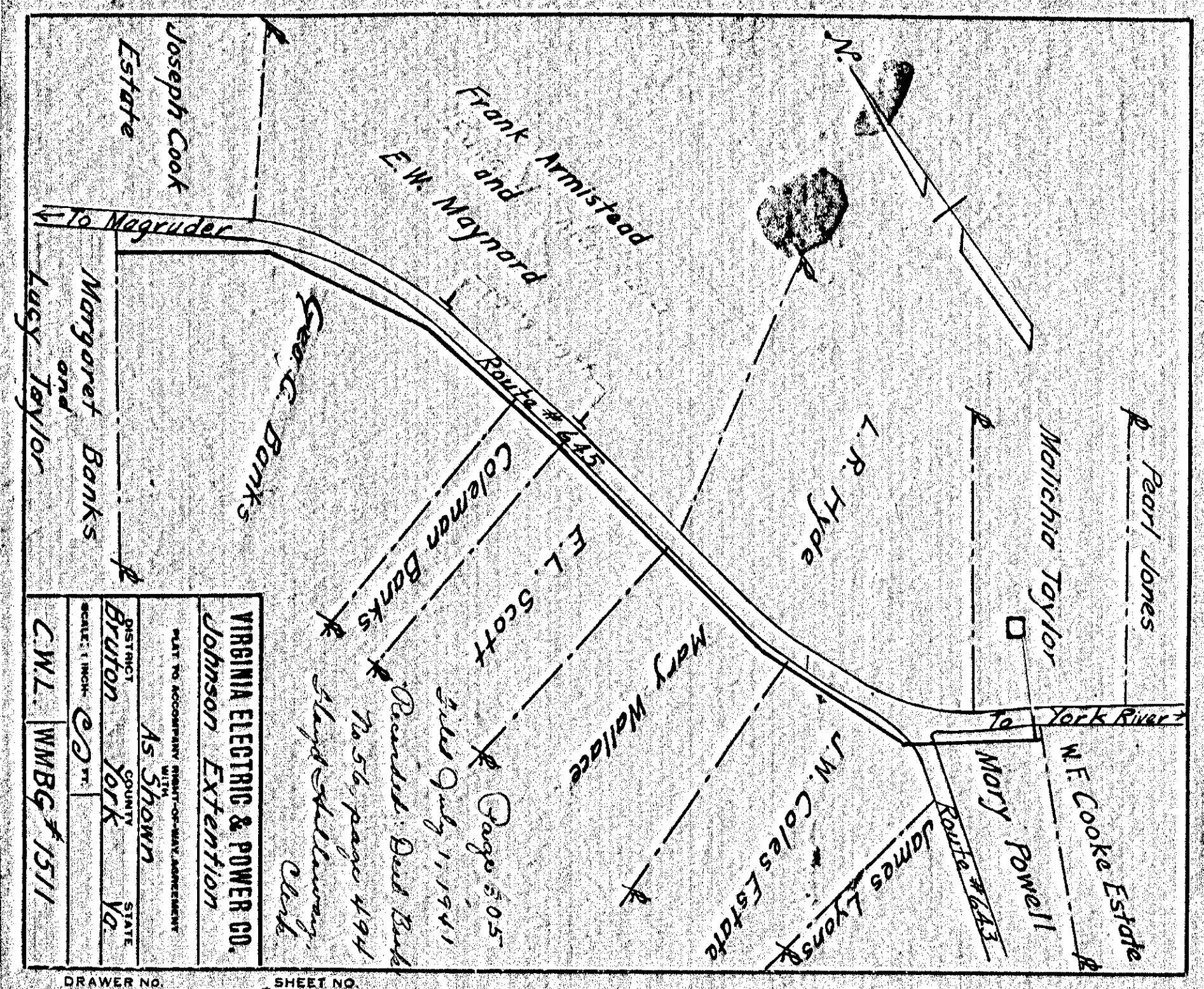

VIRGINIA ELECTRIC & POWER CO.
 Johnson Extension
 PLAT TO ACCOMPANY RIGHT-OF-WAY AGREEMENT
 WITH
 AS SHOWN
 DISTRICT COUNTY STATE
 BRUNTON YORK VA
 SCALE: 1"=100'
 C.W.L. WMBG # 1511

DRAWER NO. SHEET NO.

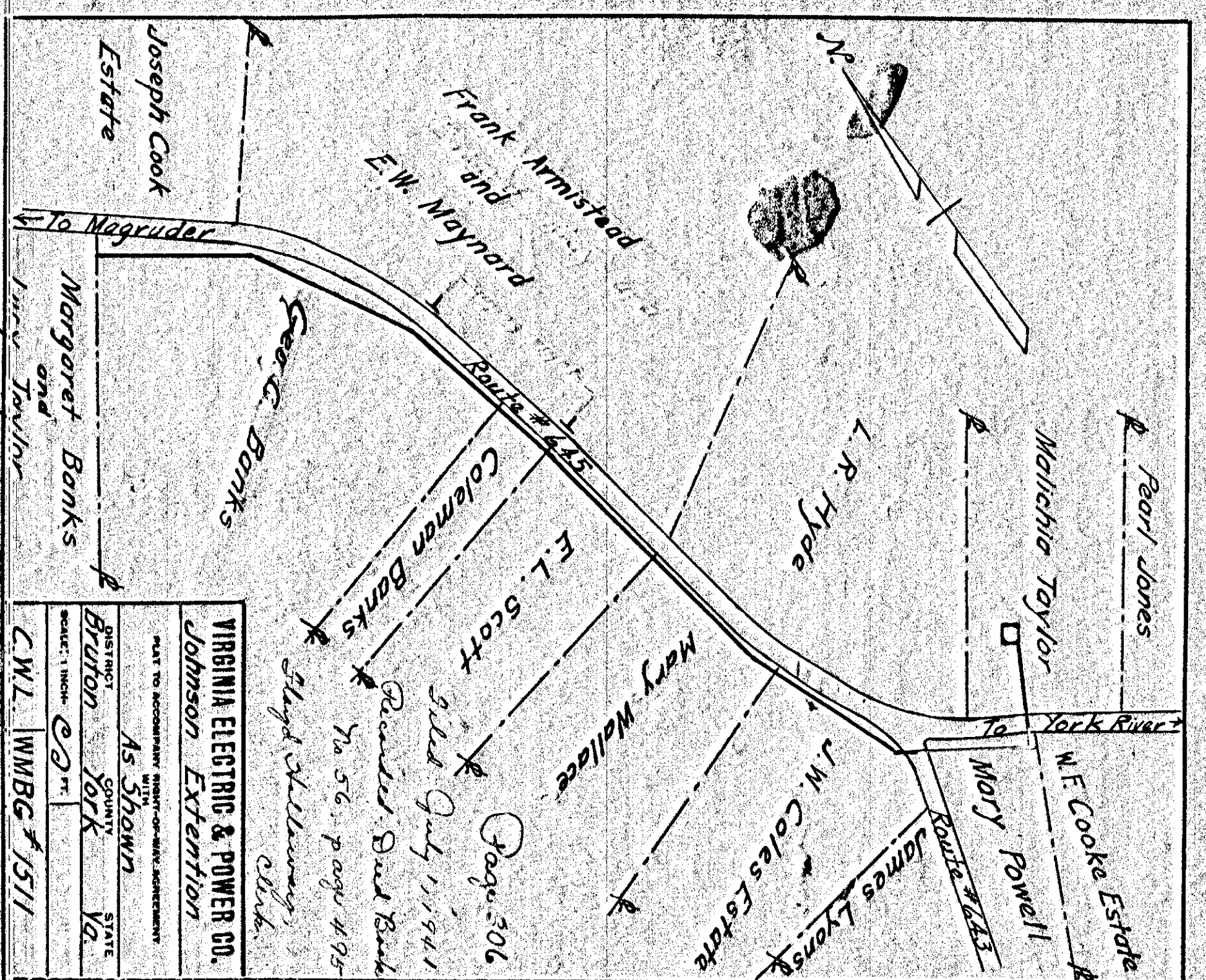

VIRGINIA ELECTRIC & POWER CO.
 Johnson Extension
 PLAT TO ACCOMPANY RIGHT-OF-WAY AGREEMENT
 WITH
 AS SHOWN
 DISTRICT COUNTY STATE
 BRUNTON YORK VA
 SCALE: 1"=100'
 C.W.L. WMBG # 1511

DRAWER NO. SHEET NO.

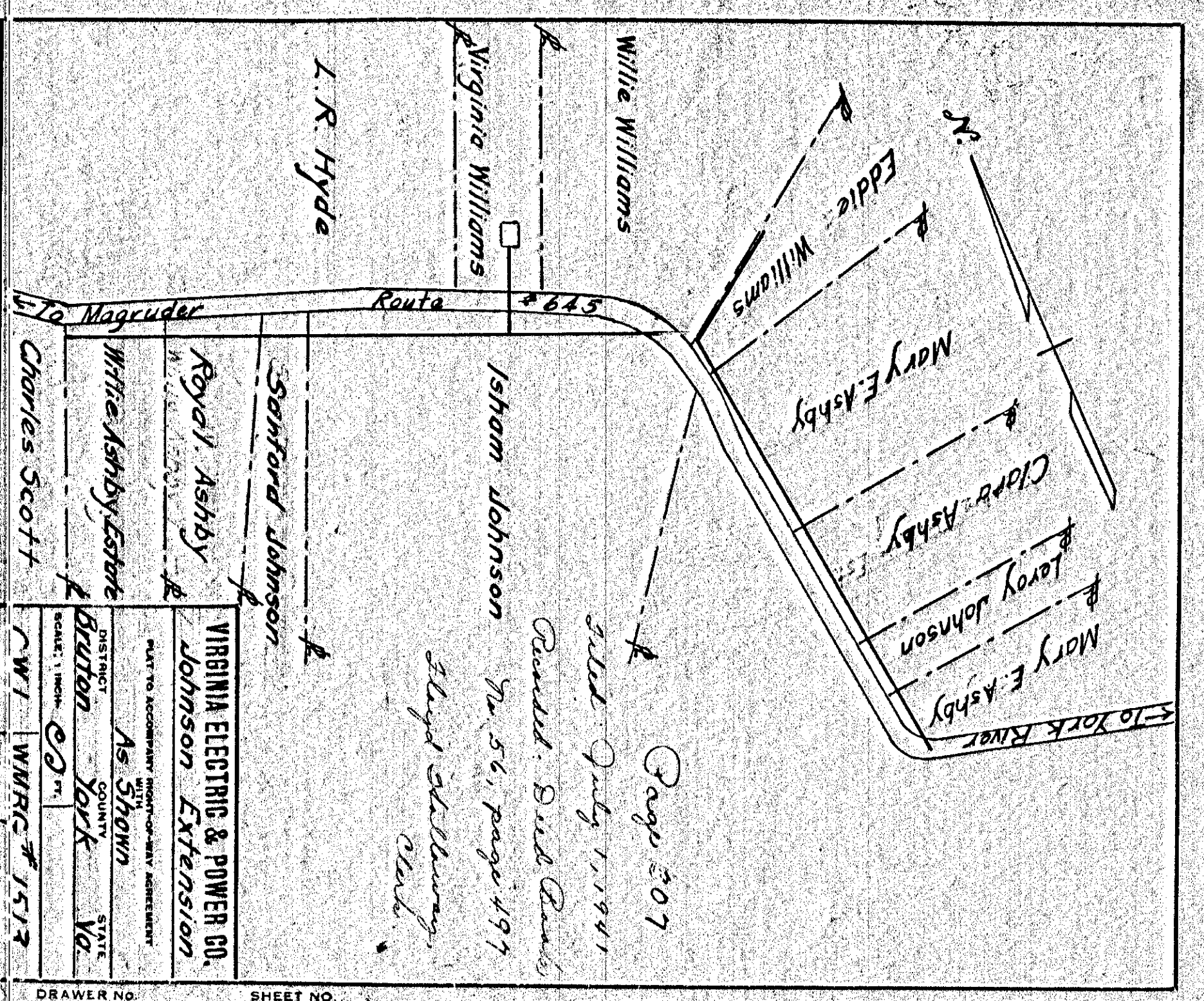

VIRGINIA ELECTRIC & POWER CO.
 Johnson Extension
 PLAT TO ACCOMPANY RIGHT-OF-WAY AGREEMENT
 WITH
 AS SHOWN
 DISTRICT COUNTY STATE
 BRUNTON YORK VA
 SCALE: 1"=100'
 C.W.L. WMBG # 1512

DRAWER NO. SHEET NO.

606

607

604

605