

VIRGINIA ELECTRIC & POWER CO.
Camp Peary Extension
 PLAT TO ACCOMPANY RIGHT-OF-WAY AGREEMENT
 WITH
R. B. Watts
 DISTRICT
BRITTON COUNTY
York STATE
Va.
 SCALE: 1"=100'
 SURVEYED BY *W. Hall*
WMBS# 1659

DRAWER NO. SHEET NO.

Notes: The Right of Way of course the plat is a part of records in
 Sub Book 58, page 503 **660**

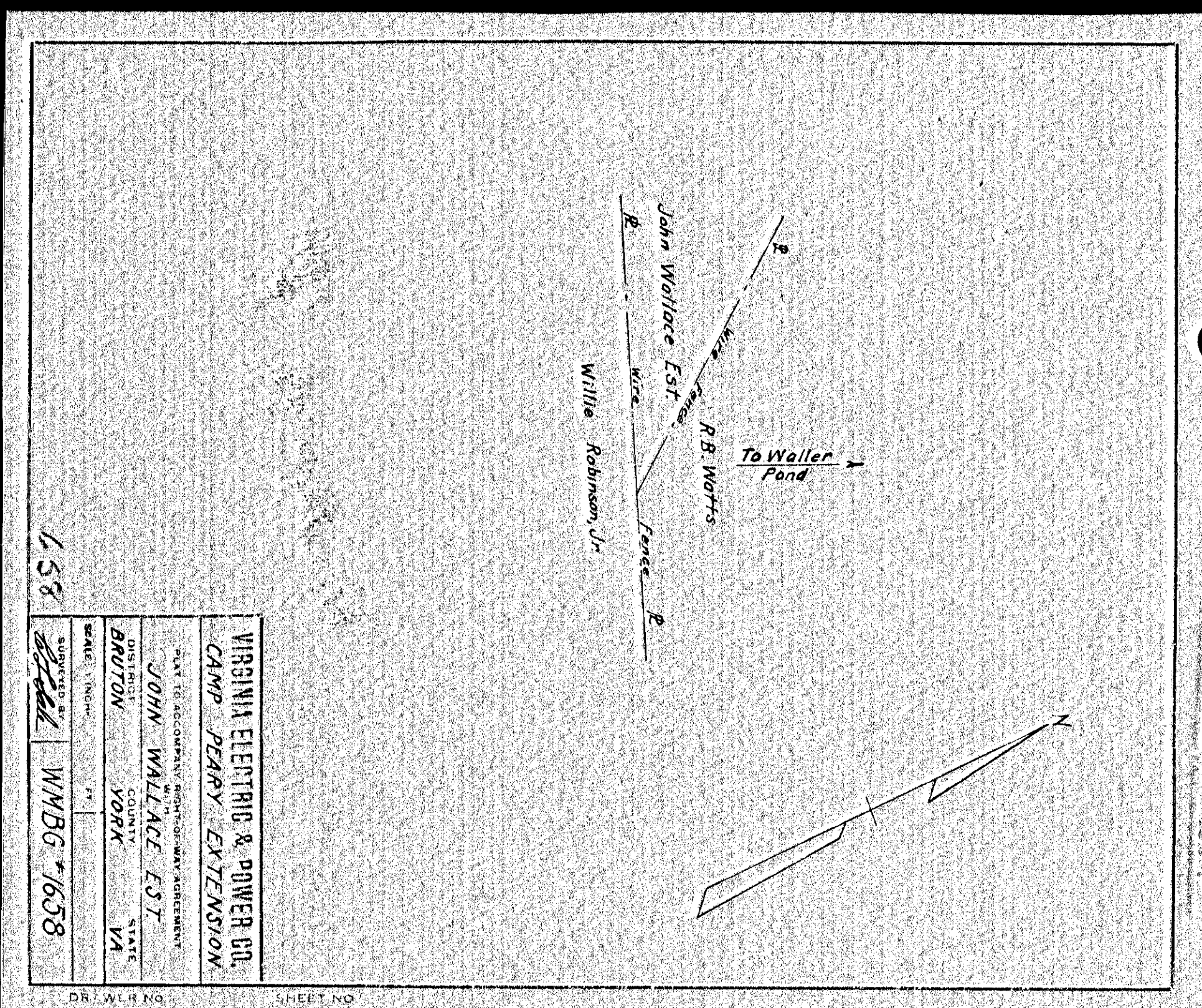

VIRGINIA ELECTRIC & POWER CO.
Camp Peary Extension
 PLAT TO ACCOMPANY RIGHT-OF-WAY AGREEMENT
 WITH
JOHN WALLACE EST.
 DISTRICT
BRITTON COUNTY
York STATE
Va.
 SCALE: 1"=100'
 SURVEYED BY *W. Hall*
WMBS# 1658

DRAWER NO. SHEET NO.

Notes: The Right of Way of course the plat is a part of records in
 Sub Book 58, page 500 **658**

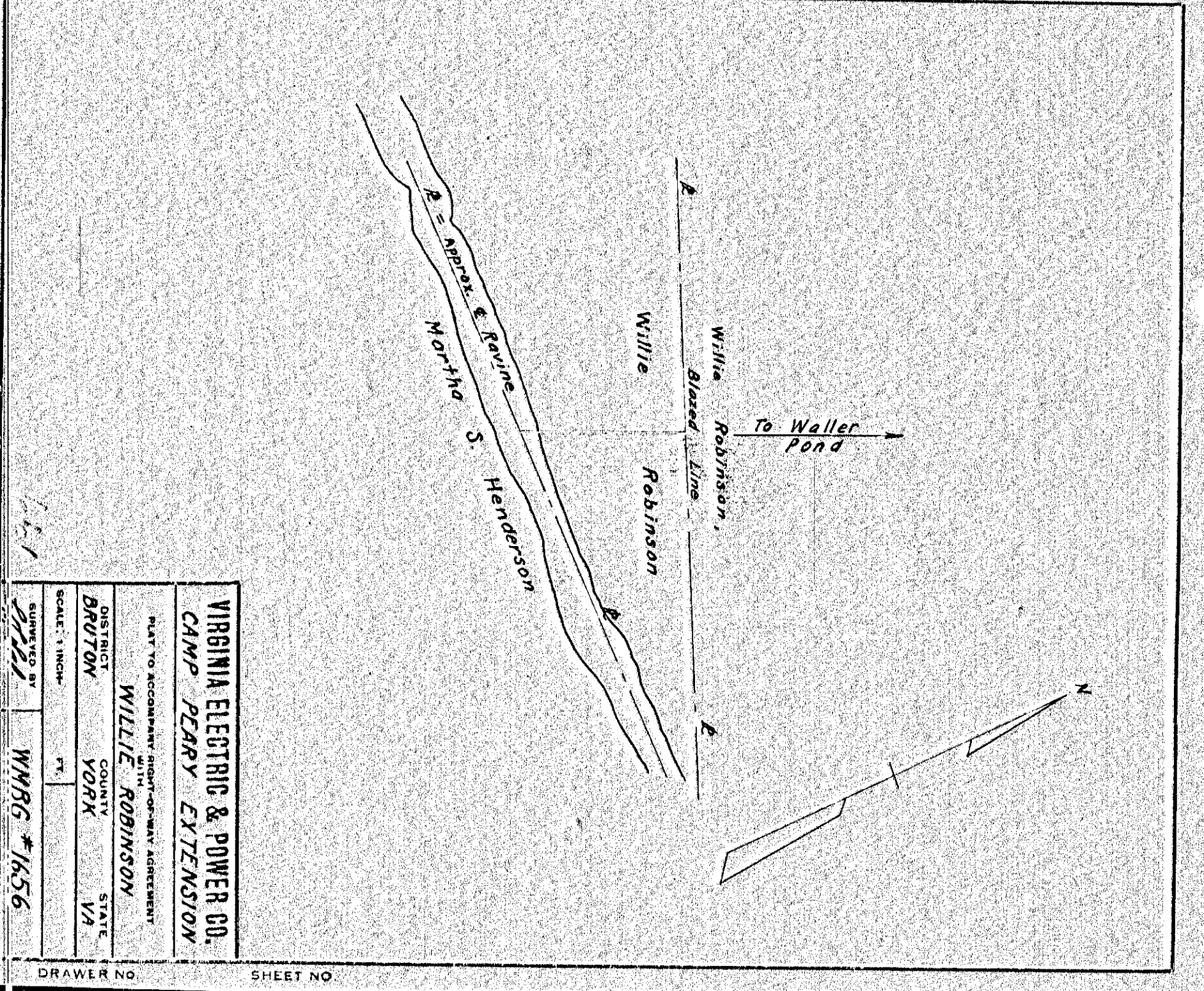

VIRGINIA ELECTRIC & POWER CO.
Camp Peary Extension
 PLAT TO ACCOMPANY RIGHT-OF-WAY AGREEMENT
 WITH
WILLIE ROBINSON
 DISTRICT
BRITTON COUNTY
York STATE
Va.
 SCALE: 1"=100'
 SURVEYED BY *W. Hall*
WMBS# 1656

DRAWER NO. SHEET NO.

Notes: The Right of Way of course the plat is a part of records in
 Sub Book 58, page 501 **661**

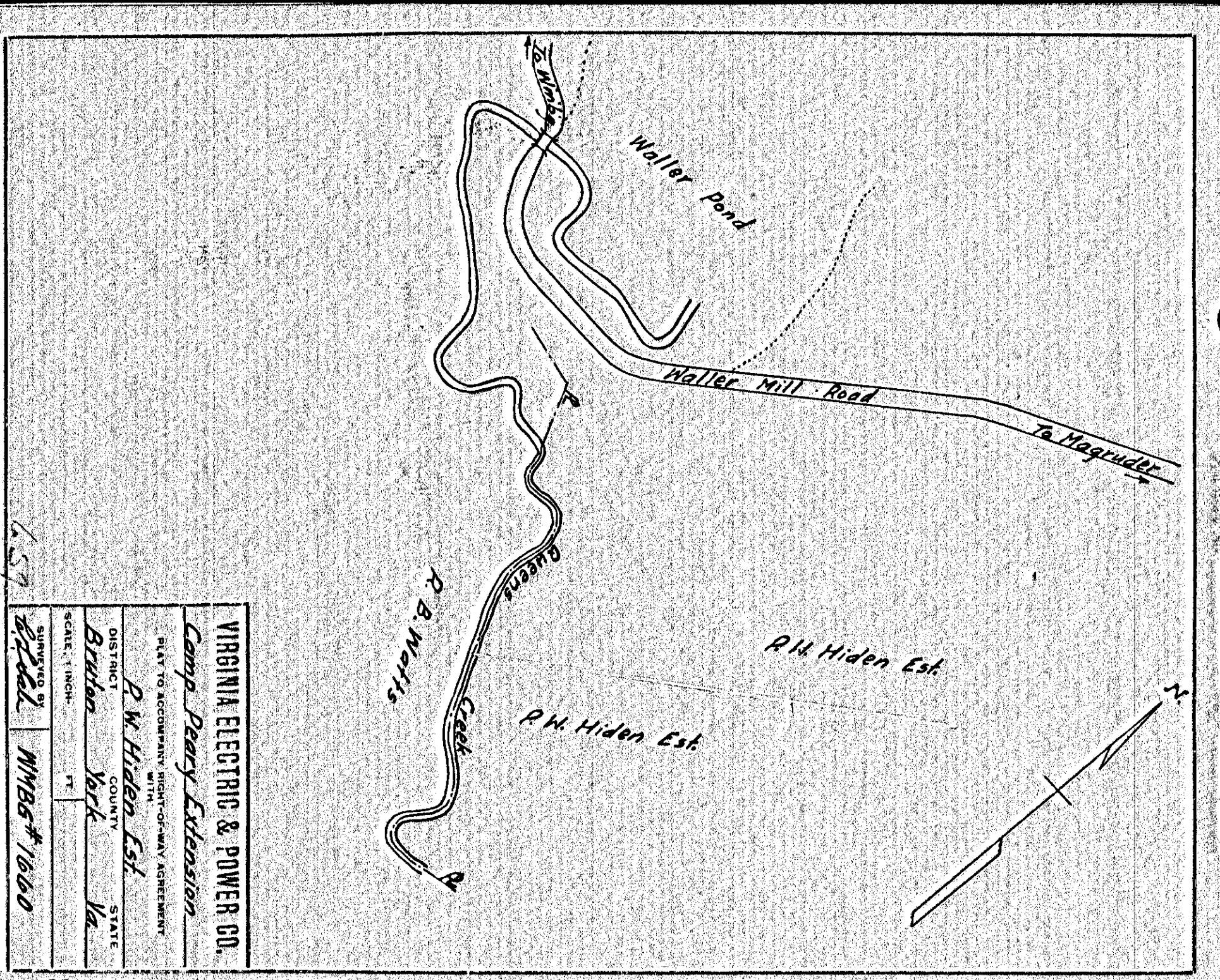

VIRGINIA ELECTRIC & POWER CO.
Camp Peary Extension
 PLAT TO ACCOMPANY RIGHT-OF-WAY AGREEMENT
 WITH
R. H. Hiden Est.
 DISTRICT
BRITTON COUNTY
York STATE
Va.
 SCALE: 1"=100'
 SURVEYED BY *W. Hall*
WMBS# 1660

DRAWER NO. SHEET NO.

Notes: The Right of Way of course the plat is a part of records in
 Sub Book 58, page 501 **659**