

VIRGINIA ELECTRIC & POWER CO.  
 Camp Peary Extension  
 R.M. Hiden Est.  
 DISTRICT  
 BRUTON YORK VA  
 SCALE: 1 INCH = 1 FT  
 SURVEYED BY  
 WMBG # 1659

DRAWER NO SHEET NO

658  
 Note: The right of way of creek this sheet is a part of record 658  
 Acad Book 58, page 590

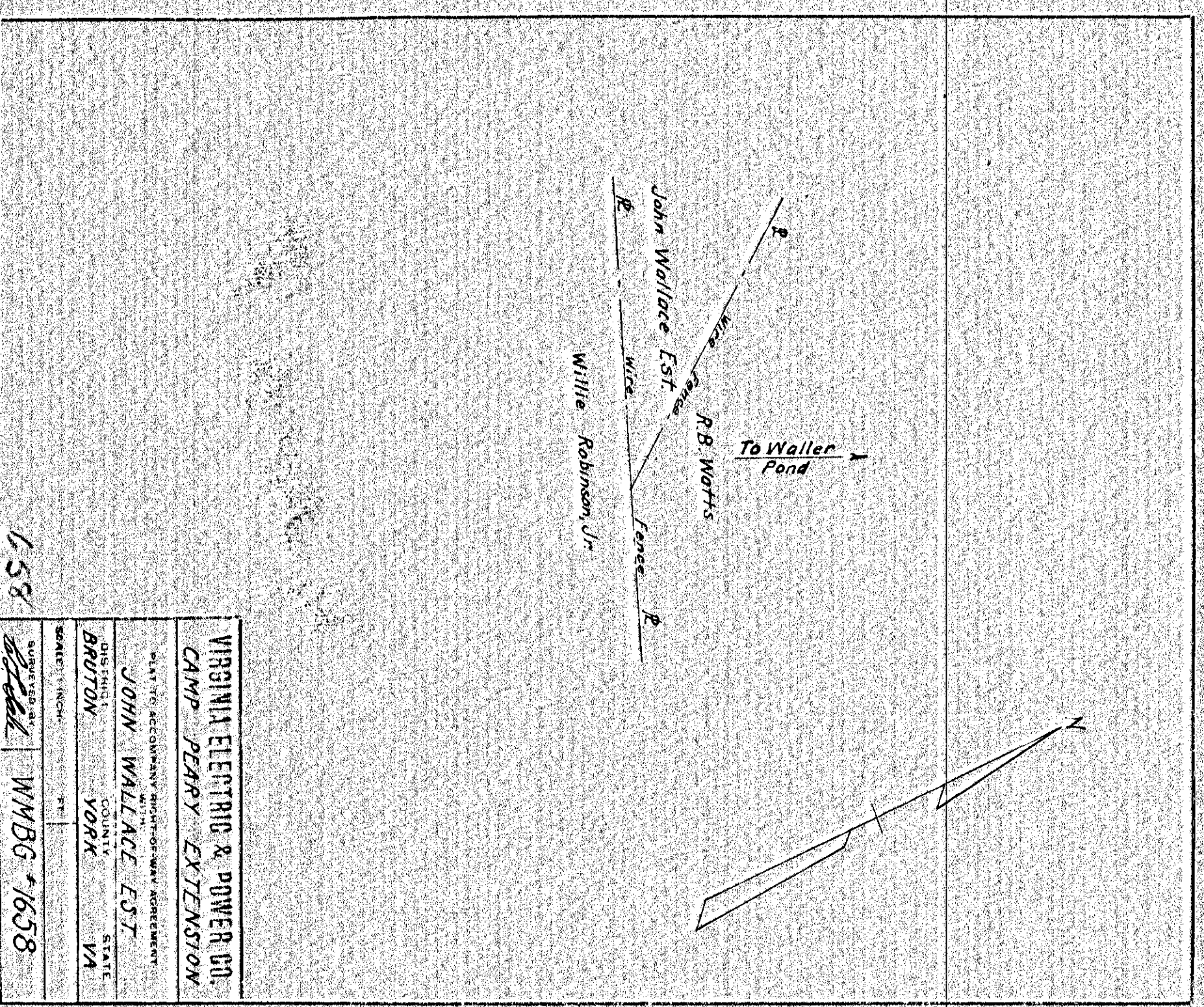

VIRGINIA ELECTRIC & POWER CO.  
 Camp Peary Extension  
 JOHN WALLACE EST  
 DISTRICT  
 BRUTON YORK VA  
 SCALE: 1 INCH = 1 FT  
 SURVEYED BY  
 WMBG # 1658

DRAWER NO SHEET NO

660  
 Note: The right of way of creek this sheet is a part of records 658  
 Acad Book 58, page 593

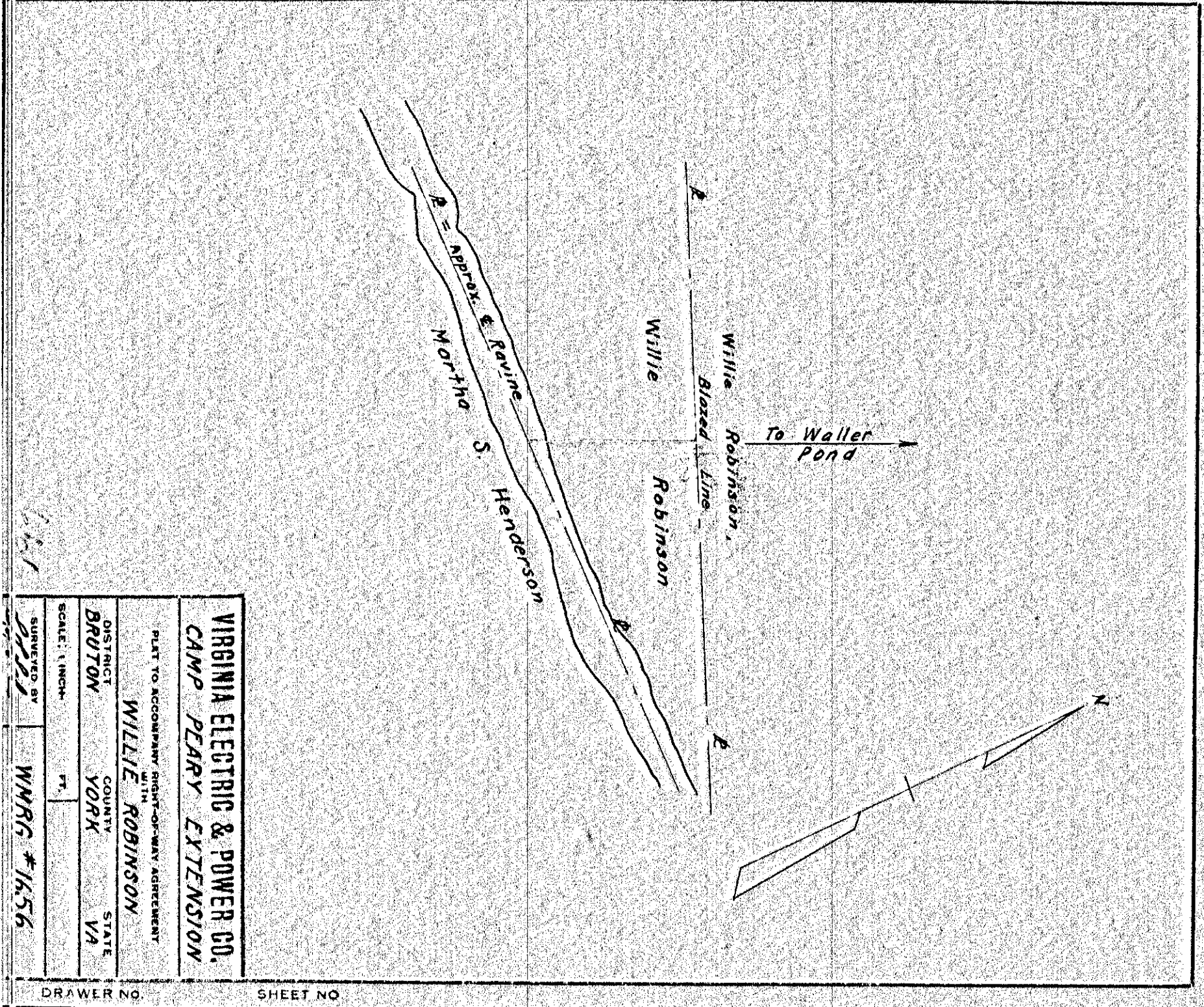

VIRGINIA ELECTRIC & POWER CO.  
 Camp Peary Extension  
 WILLIE ROBINSON  
 DISTRICT  
 BRUTON YORK VA  
 SCALE: 1 INCH = 1 FT  
 SURVEYED BY  
 WMBG # 1656

DRAWER NO SHEET NO

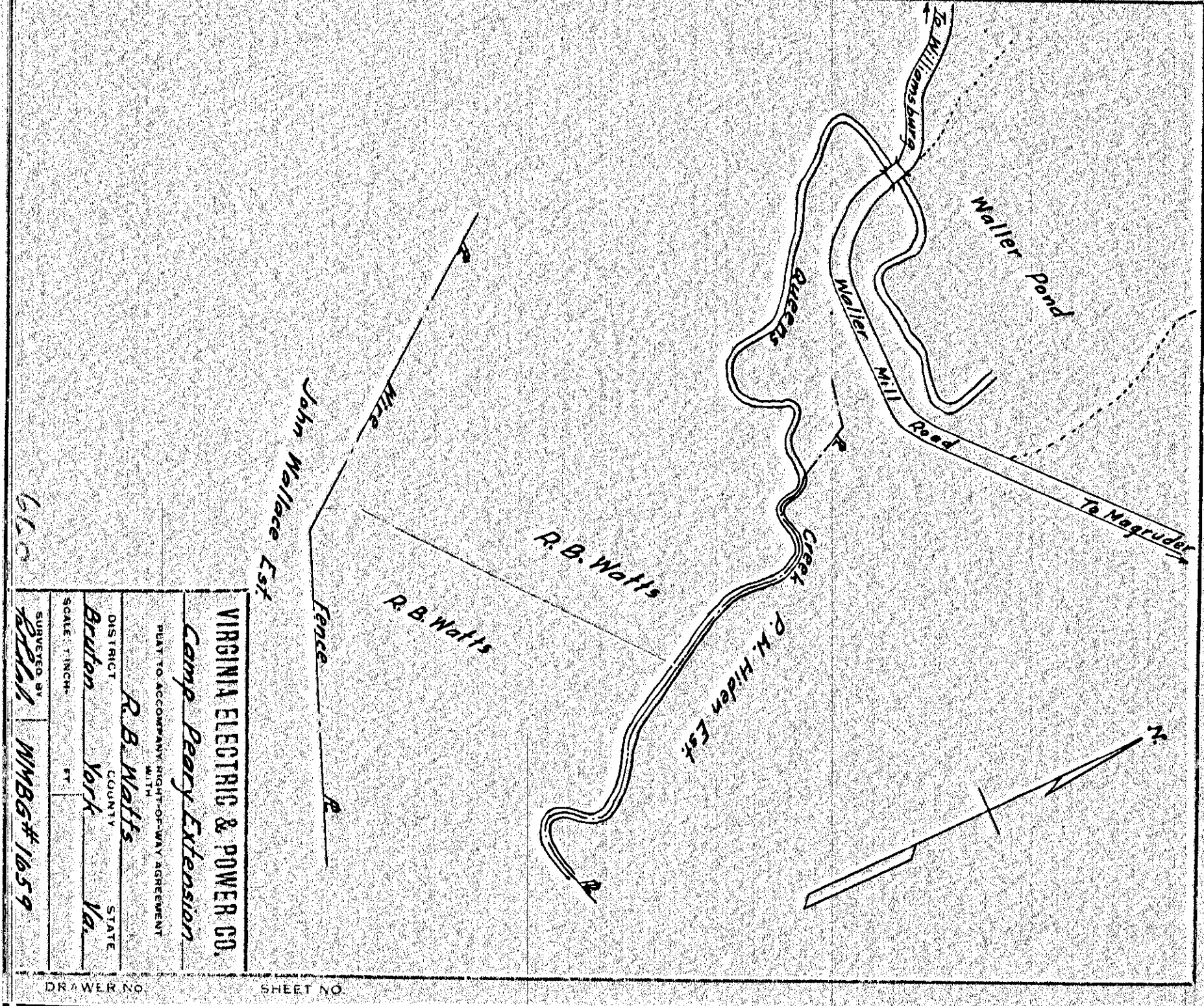

VIRGINIA ELECTRIC & POWER CO.  
 Camp Peary Extension  
 R.M. Hiden Est.  
 DISTRICT  
 BRUTON YORK VA  
 SCALE: 1 INCH = 1 FT  
 SURVEYED BY  
 WMBG # 1659

DRAWER NO SHEET NO

661  
 Note: The right of way of creek this sheet is a part of records 658  
 Acad Book 58, page 594