

~ PALACE HEIGHTS ~  
 SECTION ONE  
 A W.E. DAVIS DEVELOPMENT  
 SITUATED IN BRUTON DISTRICT YORK  
 COUNTY VIRGINIA  
 SURVEYED AUG. 1939  
 REVISOR FEB. 3, 1941, TO SHOW  
 LOTS NO 20, 29, Y.D.N.H.M.  
 SCALE 1" = 100'  
 BERNARD MECKASST. Y.D.M.C.MANUS

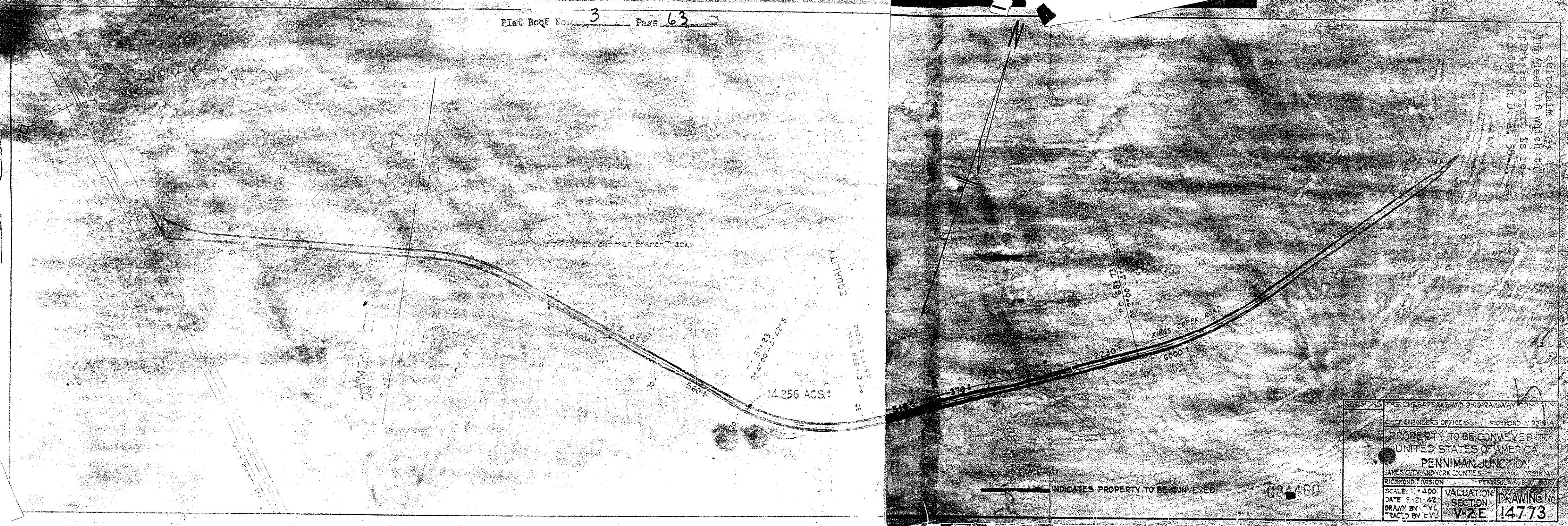

THE CHEESAPEAKE AND OHIO RAILWAY COMPANY  
 ENGINEERS OFFICE RICHMOND, VA.  
 PROPERTY TO BE CONVEYED TO  
 UNITED STATES OF AMERICA  
 PENNYMAN JUNCTION  
 JAMES CITY AND YORK COUNTIES, VIRGINIA  
 RICHMOND DIVISION  
 SCALE 1" = 400'  
 DATE 5-21-42  
 DRAWN BY C.V.L.  
 CHECKED BY C.V.L.  
 VALUATION SECTION  
 V-2E  
 DRAWING NO.  
 14773