

SURVEYOR'S PLAT.

Survey of a waterfront tract of one and fifty-two hundredths (1.52) acres located on the north shore of Cheseman's Creek tributary of the Poquoson River, York County, Virginia, adjoining the lands now or formerly owned by Coleman on east and north; by the lands now or formerly owned by Col. and Wm. Pressey on the west; by Cheseman's Creek on the south. Reference; the Virginia-Hampton Quadrangle, US Geo. Survey, (R-pr.1932). Scale of plat, 1 inch equals 100 feet. Courses are true. The magnetic Variation is 6 1/2 degrees West, 1938. From original notes of Sydney Smith, Surveyor, Yorktown, Va, on March 7, 1910.

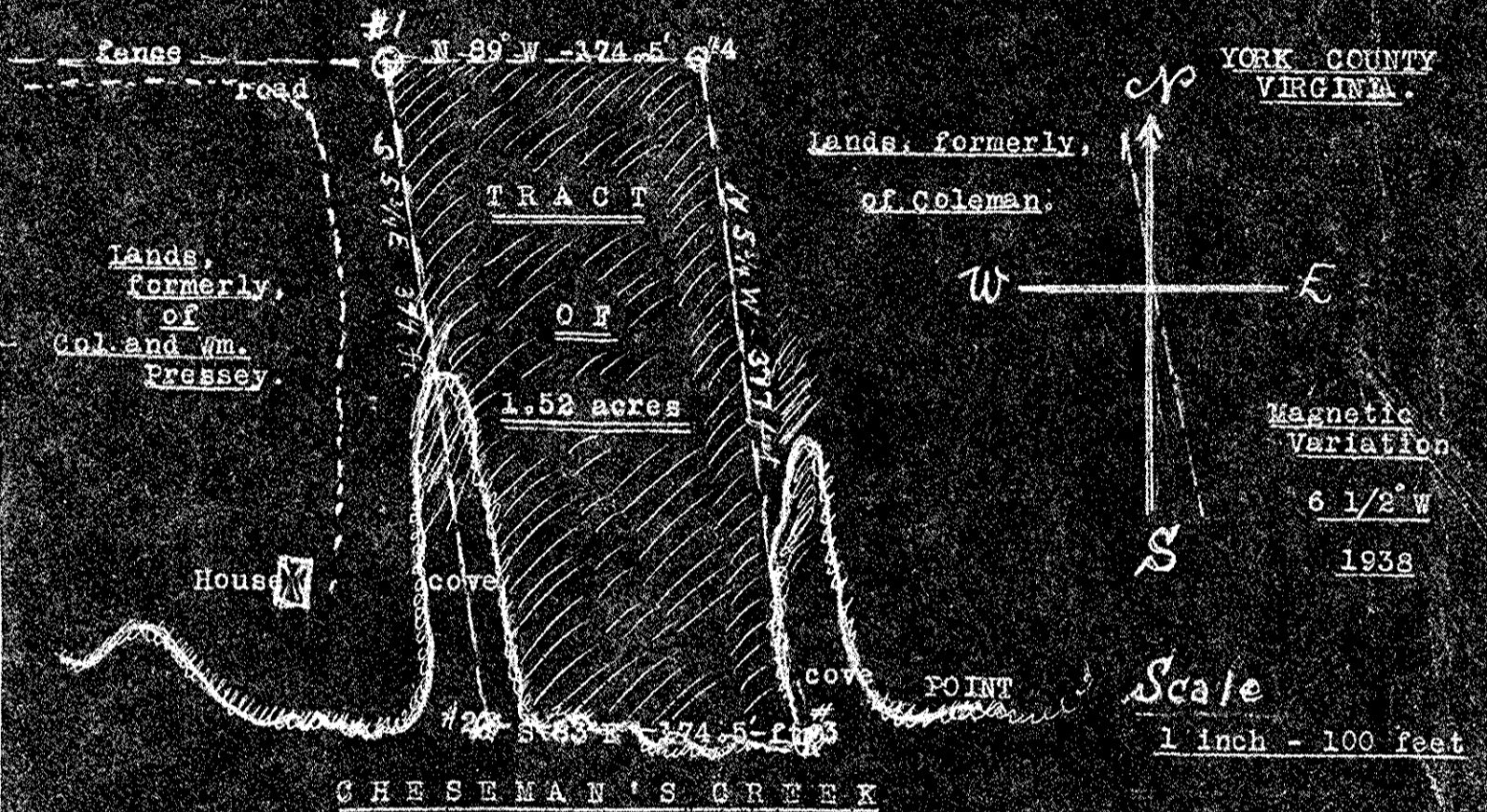

DESCRIPTION OF PROPERTY

Commencing at a point, #1, marked by an iron stob located at the northeast corner of the property now or formerly owned by Wm. and Col. Pressey; thence true S 5 3/4 E for 374 feet to point #2; thence S 83 E for 174 1/2 feet to point #3; thence N 5 3/4 W for 377 feet to point #4; thence N 89 W for 174 1/2 feet to the point of beginning; a tract of land containing one and fifty-two hundredths acres more or less; bounded on south by Cheseman's Creek; on west by a cove and the lands now or formerly owned by Col. and William Pressey; on the north and east by the lands now or formerly owned by Father Coleman.

3
 Page 70
 2 cards
 Plat Book No.

9
 26ms &