

TRACED FROM NO. 11
VIRGINIA ELECTRIC AND POWER COMPANY
PLAT TO ACCOMPANY RIGHT-OF-WAY AGREEMENT
DISTRICT PENINSULA
COUNTY YORK
STATE VIRGINIA
NEWSPRINT MADE OFFICE NO. 211/115
J.B.D. 1950

Plan Book No. H Page 170

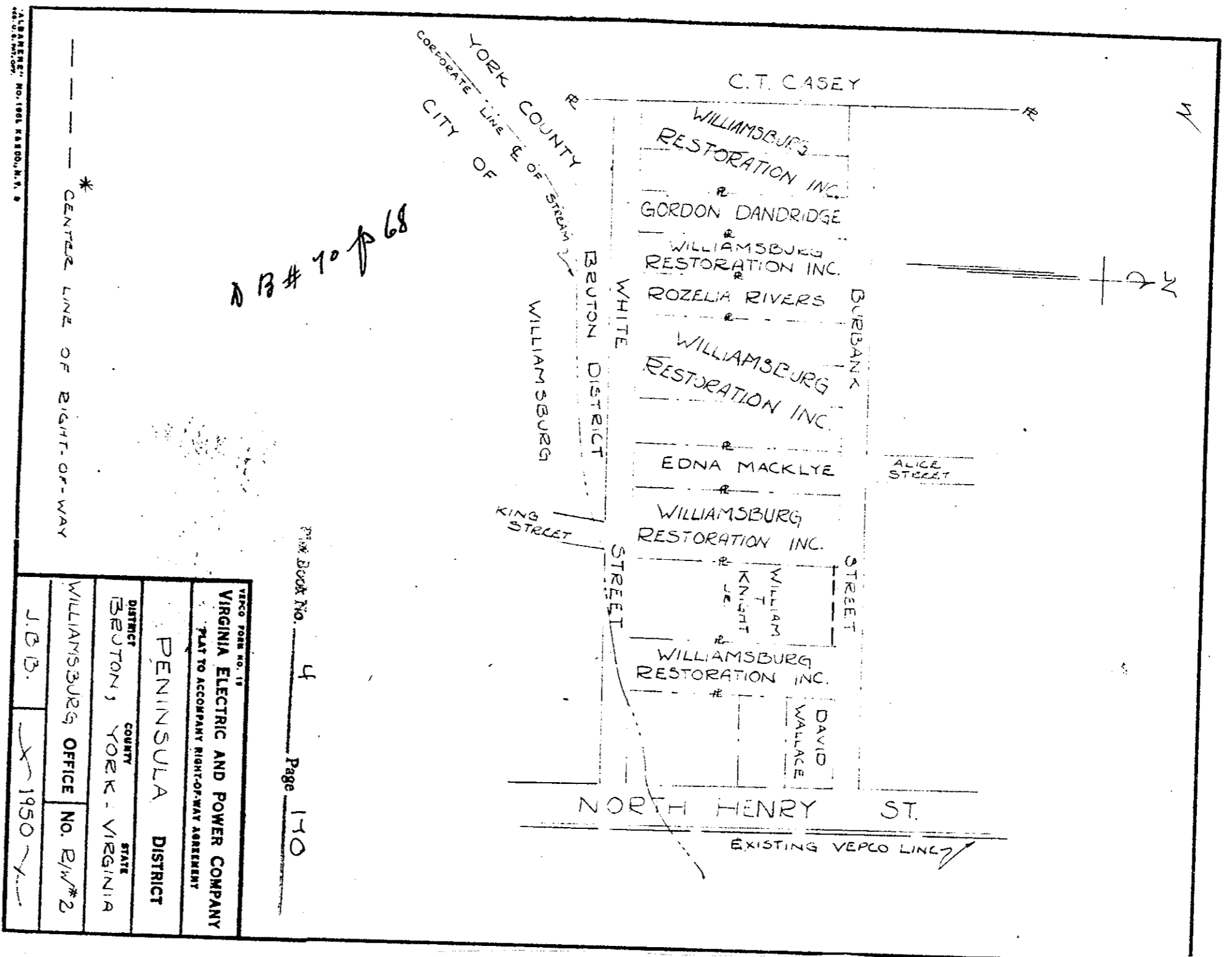

TRACED FROM NO. 11
VIRGINIA ELECTRIC AND POWER COMPANY
PLAT TO ACCOMPANY RIGHT-OF-WAY AGREEMENT
DISTRICT PENINSULA
COUNTY YORK
STATE VIRGINIA
WILLIAMSBURG OFFICE NO. 211/115
J.B.D. 1950

Plan Book No. H Page 170

AB # 70 p 68

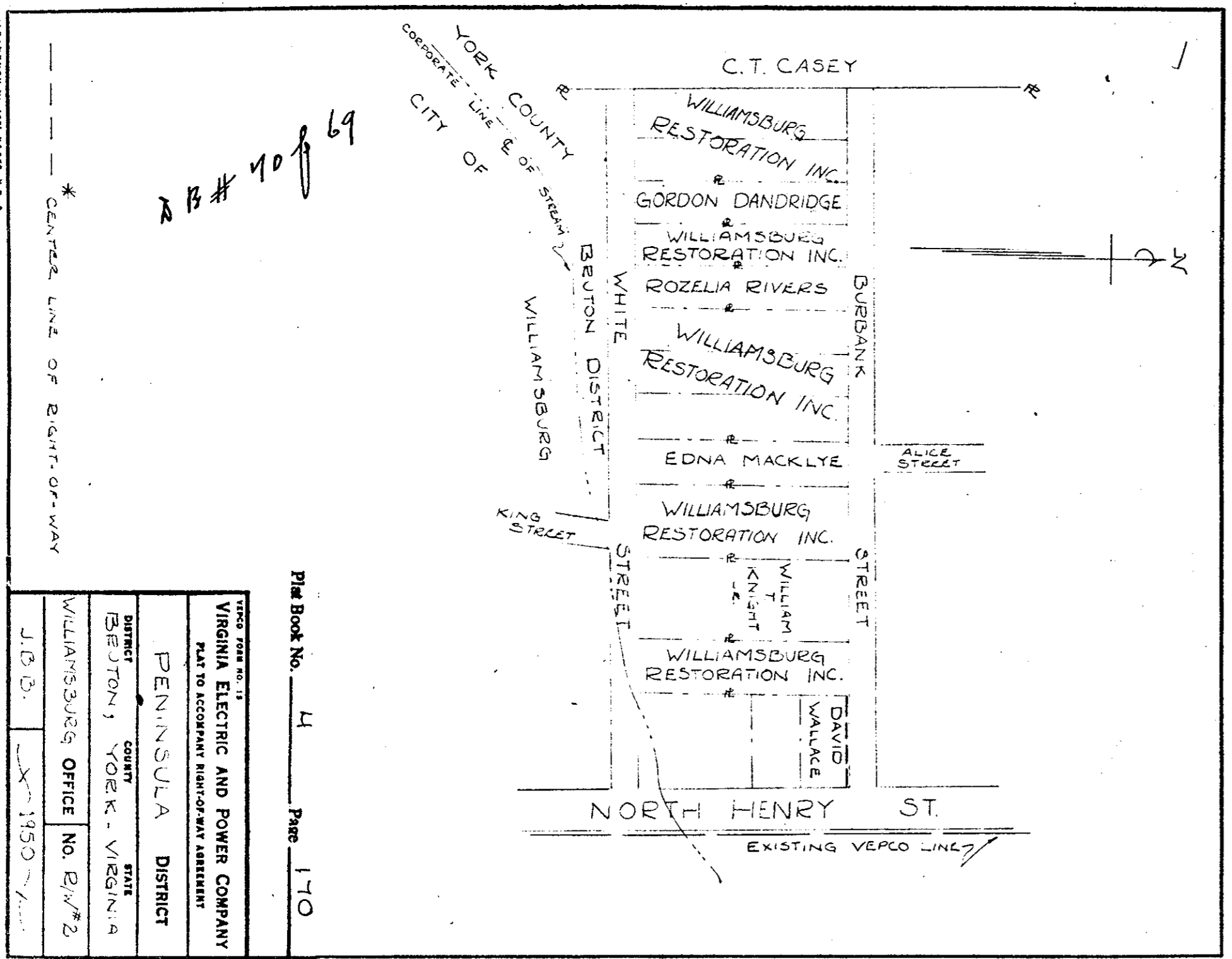

TRACED FROM NO. 11
VIRGINIA ELECTRIC AND POWER COMPANY
PLAT TO ACCOMPANY RIGHT-OF-WAY AGREEMENT
DISTRICT PENINSULA
COUNTY YORK
STATE VIRGINIA
WILLIAMSBURG OFFICE NO. 211/115
J.B.D. 1950

Plan Book No. H Page 170

AB # 70 p 69

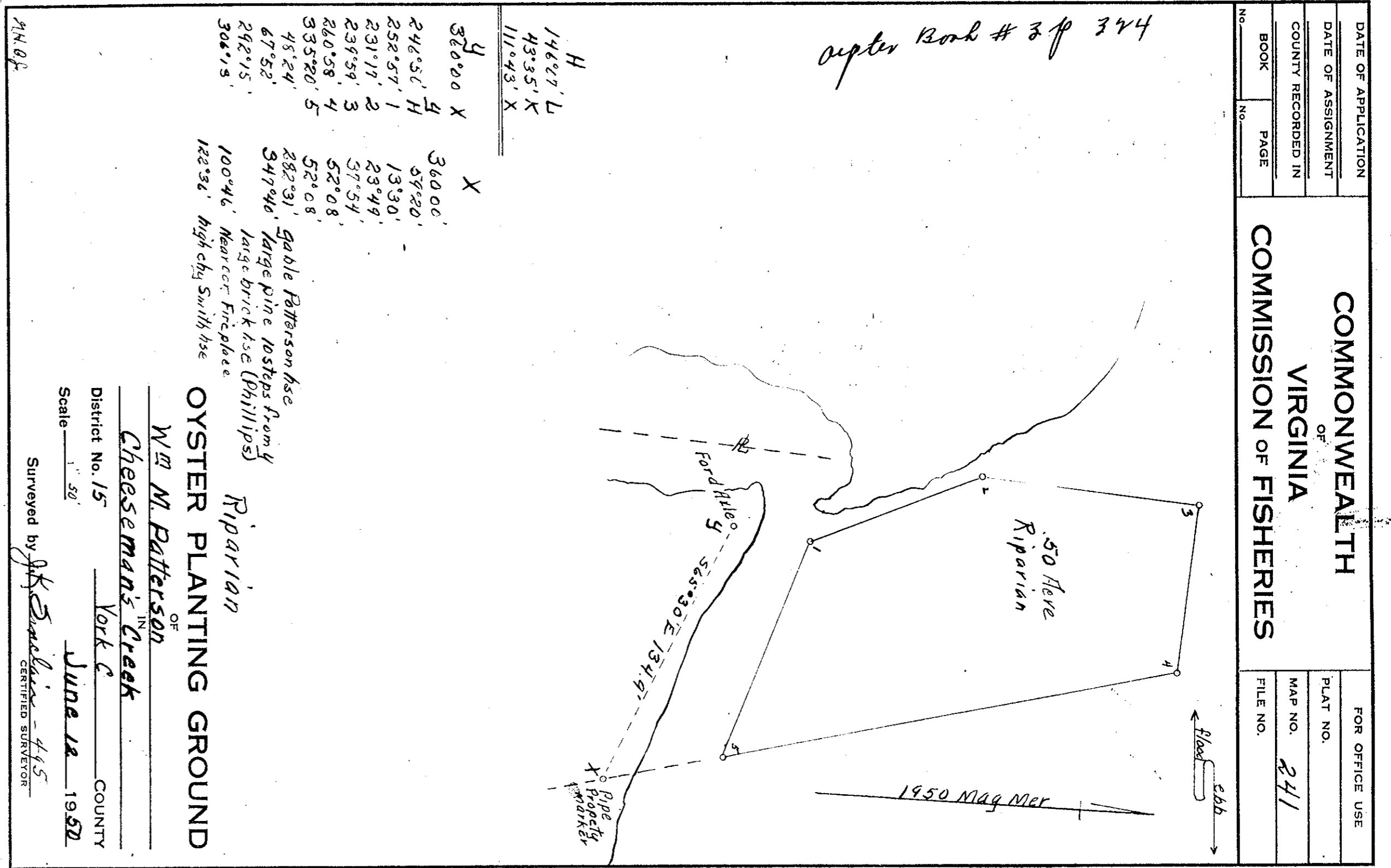

Wm M. Patterson
 OF
 Cheeseman's Creek
 District No. 15 York County
 Surveyed by J.K. Swadlow 4/5
 CERTIFIED SURVEYOR

PLAN

DATE OF APPLICATION
DATE OF ASSIGNMENT
COUNTY RECORDED IN
BOOK PAGE
NO. NO.
FOR OFFICE USE
PLAT NO.
MAP NO. 241
FILE NO.

COMMONWEALTH
 OF
 VIRGINIA
 COMMISSION OF FISHERIES

Book # 3 p 374

