

REVISED	FHW REGION	STATE	FEDERAL AID PROJECT	ROUTE	STATE PROJECT	SHEET NO.
84/18/96	3	VA		64	0064-099-106, RW-201 C-501	5

- POWER POLES PROPERTY OF VIRGINIA POWER**
P.O. BOX 323, NORFOLK, VA. 23502
- WATER LINES PROPERTY OF CITY OF NEWPORT NEWS,**
DEPARTMENT OF PUBLIC UTILITIES, 600 WARWICK BLDG.,
NEWPORT NEWS, VA. 23605
- GAS LINES PROPERTY OF VIRGINIA NATURAL GAS COMPANY**
500 EAST VIRGINIA BEACH BLDG., NORFOLK, VA. 23502
- ⑥ RAMP E
Δ - 83° 12' 06.33" RT.
D - 1158' 12"
T - 485.87
L - 697.03
R - 480.00
PC - 254-68.90
PI - 259-95.08
PT - 261-65.93
E - 0.080
V - 40MPH
 - ⑤ RAMP D
Δ - 82° 35' 52.47" RT.
D - 1156' 12"
T - 481.67
L - 691.57
R - 480.00
PC - 256-29.99
PI - 260-51.66
PT - 263-21.96
E - 0.080
V - 40MPH
 - ④ RAMP D
Δ - 0° 15' 07"
D - 0' 15' 07"
T - 95.29
L - 190.57
R - 22882.32
PC - 251-42.54
PI - 254-92.39
PT - 253-33.12
E - 0.0208
V - 70MPH
 - ④A RAMP D
Δ - 14° 50' 32.63" RT.
D - 4° 59' 59"
T - 149.27
L - 296.87
R - 1146.00
PC - 253-33.12
PI - 254-92.39
PT - 256-29.99
E - 0.035
V - 40MPH
 - ① RAMP B
Δ - 4° 32' 33.58" RT.
D - 1307' 00"
T - 151.57
L - 302.87
R - 3820.00
PC - 86-98.49
PI - 88-50.00
PT - 90-01.35
E - 0.0208
V - 40MPH
 - ② RAMP B
Δ - 4° 32' 33.58" RT.
D - 1307' 00"
T - 151.57
L - 302.87
R - 3820.00
PC - 90-01.35
PI - 91-52.287
PT - 93-04.22
E - 0.0208
V - 40MPH
 - W.B.L. ROUTE 64
Δ - 5° 07' 20" LT.
D - 0' 15' 07" LT.
T - 1024.37
L - 2047.37
R - 22901.32
PC - 1196-10.15
PI - 1206-34.52
PT - 1216-57.52

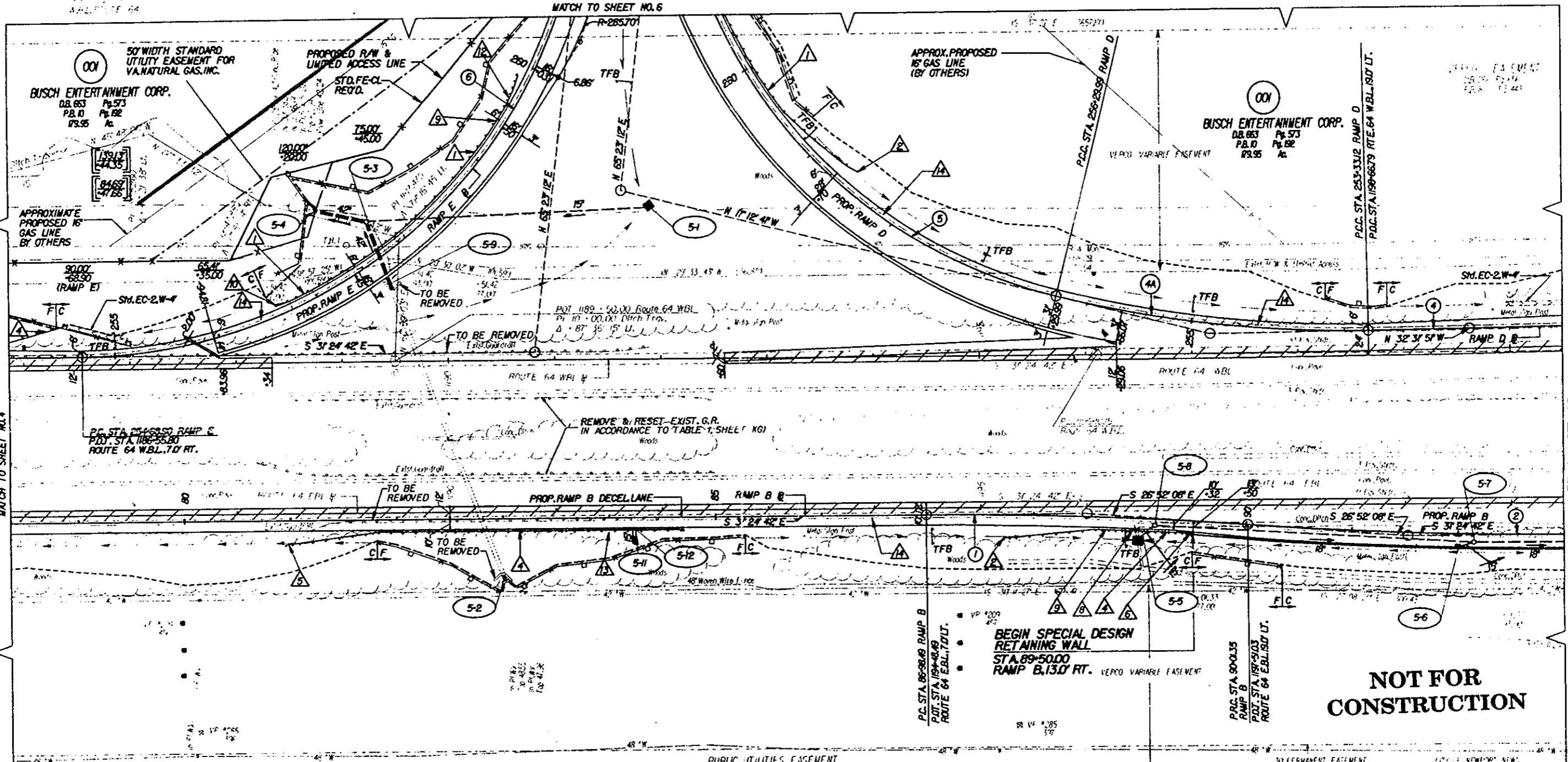
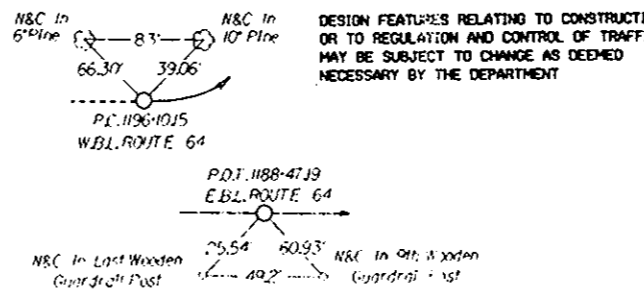

- ① DENOTES ST'D. GR-8 RECD.
- ② DENOTES ST'D. GR-6 TERMINAL RECD.
- ③ DENOTES ST'D. GR-7 TERMINAL RECD.
- ④ DENOTES ST'D. GR-8 TYPE II TERMINAL RECD.
- ⑤ DENOTES ST'D. GR-8 TYPE III TERMINAL RECD.
- ⑥ DENOTES ST'D. GR-3 RECD.
- ⑦ DENOTES ST'D. GR-2 RECD.
- ⑧ DENOTES ST'D. GR-6 TERMINAL RECD.
- ⑨ DENOTES FIXED OBJECT ATTACH. GR-FOM, TYPE I RECD.
- ⑩ DENOTES ST'D. GR-8B RECD.
- ⑪ DENOTES ST'D. GR-8A RECD.
- ⑫ DENOTES ST'D. GR-8HW TERMINAL END SECTION
- ⑬ DENOTES ST'D. UD-4
- TFB DENOTES TEMPORARY FILTER BARRIER
- TSF DENOTES TEMPORARY SILT FENCE
- ①② DENOTES DEMOLITION OF PAVEMENT
- C Denotes Construction Limits In Cuts
- E Denotes Construction Limits In Fills

NOT FOR CONSTRUCTION

INDEX

ALIGNMENT	1E
PROFILES	1
RAMP E	5A
RAMP D	5C
RAMP B	4A, 5B
DRAINAGE	DESCR. 8B

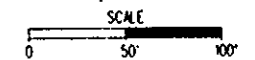

Gannett Fleming
ENGINEERS AND PLANNERS

SUPERVISED BY: _____
DESIGNED BY: _____
CADD OPERATOR: _____
REVISED BY: _____

PLAN	DATE	BY	CHKD.