

SUBDIVISION OF THE PROPERTY OF RICHMOND ROAD ASSOCIATES, L.L.C., PARCEL CONTAINING 63.510 ACRES

BRUTON DISTRICT YORK COUNTY VIRGINIA DATE: 6/22/98 SCALE: N/A DRAWN: PWM

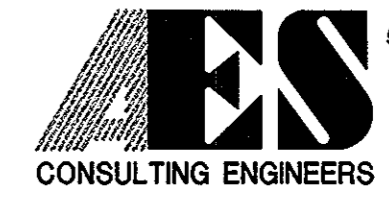

5248 Olde Towne Road, Suite 1 Williamsburg, Virginia 23188 (757) 253-0040 Fax (757) 220-8994

JOB NO. 8452

SHEET 1 OF 2

REVISED 7/21/98 PER YORK COUNTY COMMENTS

GENERAL NOTES:

- 1) PROPERTY TO BE SUBDIVIDED IS ALL OF ASSESSOR'S PARCEL 5-50
2) PROPERTY IS CURRENTLY ZONED "EO" ECONOMIC OPPORTUNITY DISTRICT.
3) PROPERTY AS SHOWN LIES IN ZONE "X", (AREAS DETERMINED TO BE OUTSIDE THE 500 YEAR FLOODPLAIN) PER F.I.R.M #510182-0025B, DATED DECEMBER 16, 1988.
4) NONE OF THE AREA CONTAINED IN THIS SUBDIVISION IS WITHIN A RESOURCE PROTECTION AREA OR RESOURCE MANAGEMENT AREA
5) TOTAL AREA SUBDIVIDED IS 63.510 ACRES AND IS COMPUTED TO THE CENTERLINE OF THE STREAM. TRAVERSE LINES ALONG STREAM ARE FOR CLOSURE PURPOSES ONLY.
6) SETBACKS LINES ARE AS FOLLOWS: FRONT 45' MIN. SIDE 10' MIN. REAR 10' MIN.

REFERENCES

- DEED BOOK 970, PAGE 20
DEED BOOK 987, PAGE 740
PLAT BOOK 11, PAGE 676
PLAT BOOK 6, PAGE 87

APPROVED: YORK COUNTY BOARD OF SUPERVISORS

BY: John T. Dunn, PE, PLAT APPROVING AGENT

DATE: 7-22-98

STATE OF VIRGINIA COUNTY OF YORK

IN THE CLERK'S OFFICE OF THE CIRCUIT COURT FOR THE COUNTY OF YORK THE 22nd DAY OF July, 1998.

THIS MAP WAS PRESENTED AND ADMITTED TO RECORD AS THE LAW DIRECTS, PLAT BOOK 12, PAGE 6010.

TESTE: NANCY B. KANE, CLERK

BY: Kristen N. Nelson, D.C.

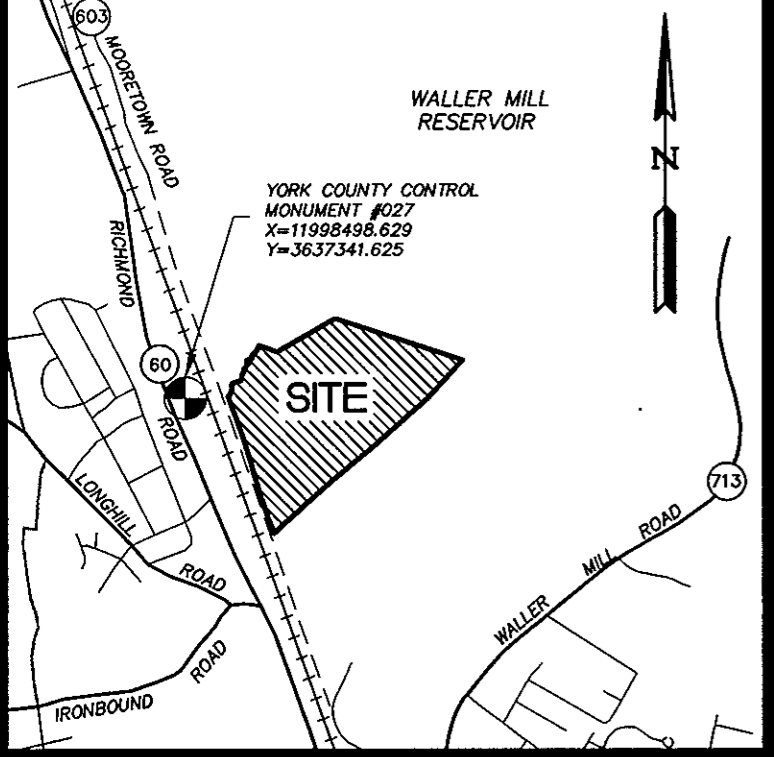

VICINITY MAP SCALE: 1"= 2000'

OWNER'S CONSENT AND DEDICATION

THE PLATTING OF THE LAND HEREON IS WITH THE FREE CONSENT AND IN ACCORDANCE WITH THE DESIRES OF THE UNDERSIGNED OWNERS, PROPRIETORS, AND TRUSTEES.

RICHMOND ROAD ASSOCIATES, L.L.C.

C. Lewis Waltrip, II, PRESIDENT

7-21-98 DATE

NOTARY: STATE OF VIRGINIA

Notary Public in and for the State of Virginia do hereby certify that the above named person whose name is signed to the foregoing writing has acknowledged the same before me in my jurisdiction aforesaid.

GIVEN UNDER MY HAND THIS 21st DAY OF July, 1998.

MY COMMISSION EXPIRES 1/31/2000

Vernard E. Lockwood II, CORPORATE OFFICER (TRUSTEE) 7/21/98 DATE

Notary Public in and for the State of Virginia do hereby certify that the above named person whose name is signed to the foregoing writing has acknowledged the same before me in my jurisdiction aforesaid.

GIVEN UNDER MY HAND THIS 21 DAY OF July, 1998.

MY COMMISSION EXPIRES 12-31-2001

SURVEYOR'S STATEMENT

TO THE BEST OF MY KNOWLEDGE AND BELIEF, ALL THE REQUIREMENTS AS SET FORTH IN THE SUBDIVISION ORDINANCE OF THE COUNTY OF YORK, VIRGINIA, HAVE BEEN COMPLIED WITH, INCLUDING A CLOSURE OF NOT LESS THAN 1'/ 20,000'.

THIS IS TO CERTIFY THAT THE LAND EMBRACED IN THIS SUBDIVISION IS IN THE NAME OF RICHMOND ROAD ASSOCIATES, L.L.C., A VIRGINIA LIMITED LIABILITY COMPANY, AND WAS ACQUIRED FROM WILLIAM F. MERSHON AND KATHRYN M. AINSWORTH, SUBSTITUTE TRUSTEE UNDER THE MERSHON LAND TRUST AGREEMENT, BY DEED DATED JANUARY 5, 1998 AND DULY RECORDED IN THE CLERK'S OFFICE OF THE CIRCUIT COURT OF THE COUNTY OF YORK, VIRGINIA IN DEED BOOK 987, AT PAGE 740. A DEED OF TRUST DATED JANUARY 6, 1998 IS HELD BY FIRST COASTAL BANK, PRINCESS ANNE SERVICE CORP., VERNARD E. LOCKWOOD, II, CORPORATE OFFICER (TRUSTEE), AND IS DULY RECORDED IN THE CLERK'S OFFICE OF THE CIRCUIT COURT OF THE COUNTY OF YORK, VIRGINIA, IN DEED BOOK 987, PAGE 743. I CERTIFY THAT THE IRON PIPES, RODS OR MONUMENTS SHOWN ON THIS PLAT WILL BE SET ON OR BEFORE JUNE 22, 1999.



G.T. Wilson, Jr., C.L.S. 6/22/98 DATE

NOTES:

- 1. DRAINAGE AND UTILITY EASEMENTS CONVEYED TO THE COUNTY BY RECORDATION OF THIS PLAT SHALL BE EXCLUSIVE TO THE COUNTY, UNLESS OTHERWISE NOTED. CONVEYANCE OF SUCH EASEMENTS TO THE COUNTY ALSO INCLUDE: (i) THE RIGHT OF INGRESS AND EGRESS OVER THE OWNER'S LAND ADJACENT TO THE EASEMENT AS NECESSARY TO INSPECT, MAINTAIN AND OPERATE THE COUNTY'S FACILITIES WITHIN THE EASEMENT AND (ii) THE RIGHT OF THE COUNTY TO ASSIGN TO OTHERS FROM TIME TO TIME THE RIGHT TO LOCATE FACILITIES THEREIN SERVING THE PUBLIC, INCLUDING, BUT NOT LIMITED TO, WATER, ELECTRIC, TELEPHONE, COMMUNICATIONS, AND GAS UTILITY FACILITIES.
2. THE RECORDATION OF THIS PLAT SHALL OPERATE TO TRANSFER TO THE COUNTY OF YORK ANY EASEMENTS INDICATED ON THE PLAT FOR DRAINAGE AND/OR SANITARY SEWER TO CREATE A PUBLIC RIGHT-OF-PASSAGE OVER THE SAME, UNLESS OTHERWISE NOTED ON THIS PLAT.

CURVE DATA

Table with 7 columns: NUMBER, RADIUS, DELTA, ARC, TANGENT, CHORD, CHORD BEARING. Contains data for curves C1 through C7.

UTILITIES:

DEVELOPMENT OF THE LOTS WITHIN THIS SUBDIVISION IS CONTINGENT UPON THE PROVISION OF PUBLIC WATER AND PUBLIC SEWER.

ANY EXISTING WELLS THAT ARE TO BE TAKEN OUT OF SERVICE SHALL BE PROPERLY ABANDONED IN ACCORDANCE WITH CURRENT STATE HEALTH DEPARTMENT REGULATIONS.

07.21.98-13:09 84520P02.dwg