

THE CHESAPEAKE CORP.
 J.W. MARSHALL TRACTS
 On BACK CREEK and near SEAFORD
 GRAFTON DIST. YORK COUNTY, VA.
 Declination 6° 21' W
 West Point, Va January 28, 1936
 Scale 1"=200'

DB 50-389

G. Evans
 Certified Surveyor

YK-9
 G.L. EVANS
 Certified Surveyor
 West Point, Va.

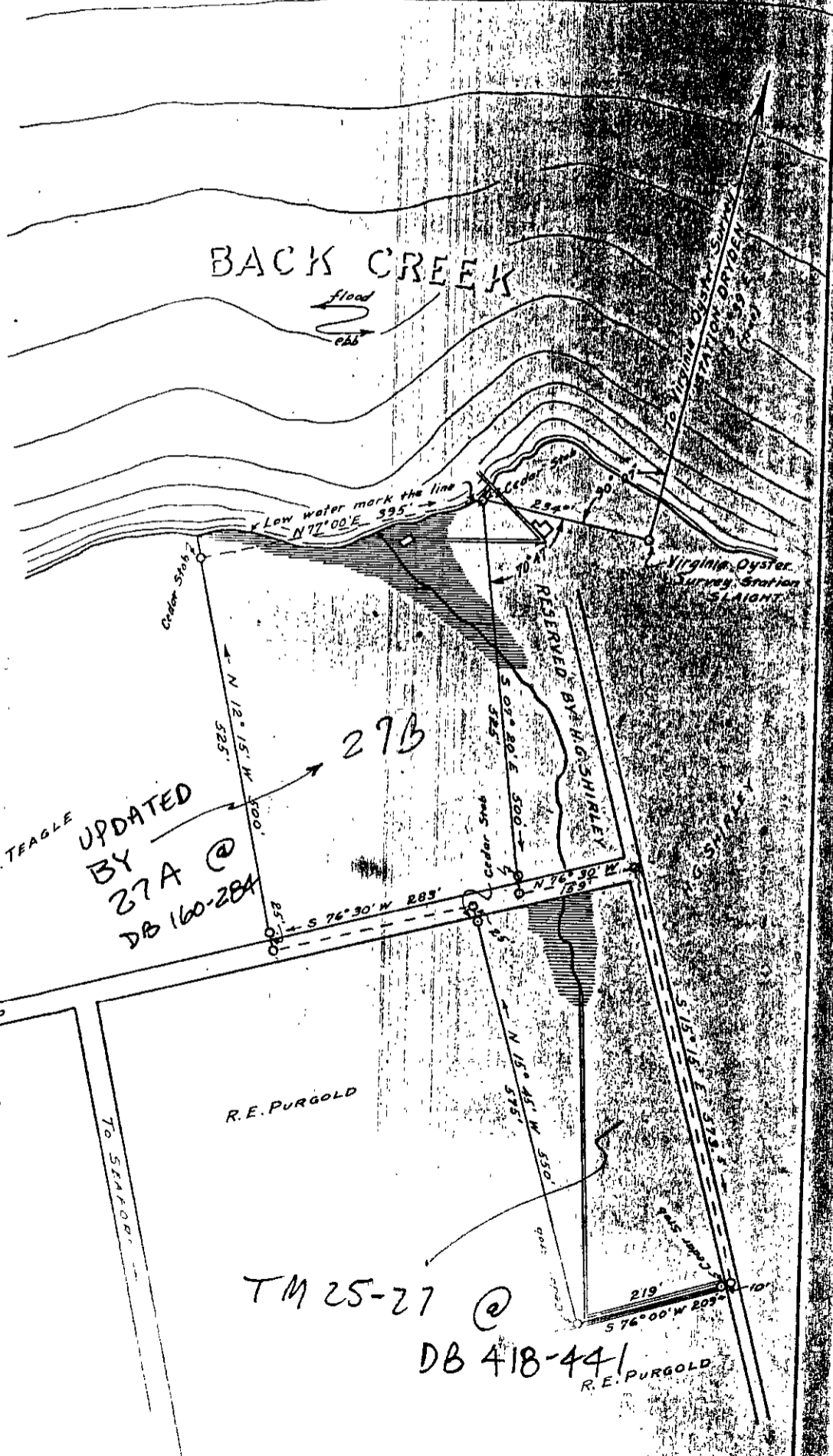
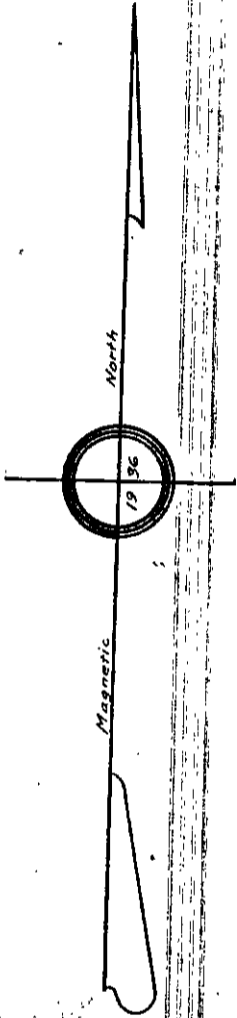

C.S. TEAGLE
 UPDATED
 BY
 27A @
 DB 160-284

27B

R.E. PURGOLD

TM 25-27 @

DB 418-441

R.E. PURGOLD

25-27B ✓

NOTED BY [unclear] 1/27/36