

404-836

PLAT REFERENCE:  
D.B. 121, Pg. 19

BOOK 404 PAGE 836

NIF HARRIS ESTATE

NORTH

NIF WILLIE WHITE

N7°05'E 102.93'

N75°59'W 159.75'

N7°04'E 45.35'

PIPE FND.

45.28'

LOT 3

LOT 4

LOT 2-A

(RECORDED AS N81°05'W → 319.16')  
N81°07'19"W 318.69'

BACK CREEK

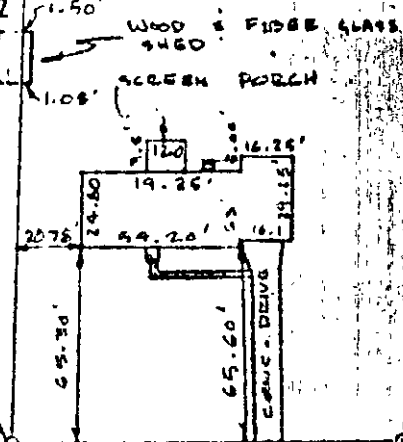

N77°59'W 577.59'6

486.92'

S6°59'W 132.26'

LANDING ROAD  
(STATE RT. #627)

#15 LANDING ROAD

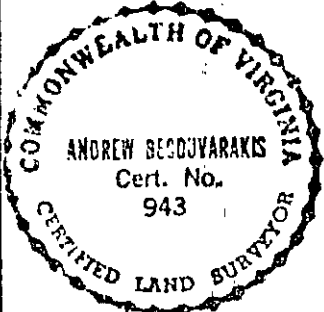

TO ALL PARTIES INTERESTED IN TITLE TO PREMISES SURVEYED: I HEREBY CERTIFY THAT ON SEPT. 13, 1984

I SURVEYED THE PROPERTY SHOWN ON THIS PLAT, AND THAT THE TITLE LINES AND THE WALLS OF THE BUILDINGS ARE

PLAT OF THE PROPERTY OF KENNETH W. & JOAN K. BLANTON

LOT 3  
S. STROUD ESTATE

... ASSOC.  
... VIRGINIA

F.B. 174 PG. 54, 55, 56

25 I (2) LOT 3