

Design File - c:\documents of ms_jacob\17935\17935\03.dgn Ref. File - c:\documents of ms_jacob\17935\17935\05.dgn Ref. File - c:\documents of ms_jacob\17935\17935\06.dgn Ref. File - c:\documents of ms_jacob\17935\17935\07.dgn Ref. File - c:\documents of ms_jacob\17935\17935\08.dgn Ref. File - c:\documents of ms_jacob\17935\17935\09.dgn Ref. File - c:\documents of ms_jacob\17935\17935\10.dgn Ref. File - c:\documents of ms_jacob\17935\17935\11.dgn Ref. File - c:\documents of ms_jacob\17935\17935\12.dgn Ref. File - c:\documents of ms_jacob\17935\17935\13.dgn Ref. File - c:\documents of ms_jacob\17935\17935\14.dgn Ref. File - c:\documents of ms_jacob\17935\17935\15.dgn Ref. File - c:\documents of ms_jacob\17935\17935\16.dgn Ref. File - c:\documents of ms_jacob\17935\17935\17.dgn Ref. File - c:\documents of ms_jacob\17935\17935\18.dgn Ref. File - c:\documents of ms_jacob\17935\17935\19.dgn Ref. File - c:\documents of ms_jacob\17935\17935\20.dgn Ref. File - c:\documents of ms_jacob\17935\17935\21.dgn Ref. File - c:\documents of ms_jacob\17935\17935\22.dgn Ref. File - c:\documents of ms_jacob\17935\17935\23.dgn Ref. File - c:\documents of ms_jacob\17935\17935\24.dgn Ref. File - c:\documents of ms_jacob\17935\17935\25.dgn Ref. File - c:\documents of ms_jacob\17935\17935\26.dgn Ref. File - c:\documents of ms_jacob\17935\17935\27.dgn Ref. File - c:\documents of ms_jacob\17935\17935\28.dgn Ref. File - c:\documents of ms_jacob\17935\17935\29.dgn Ref. File - c:\documents of ms_jacob\17935\17935\30.dgn Ref. File - c:\documents of ms_jacob\17935\17935\31.dgn Ref. File - c:\documents of ms_jacob\17935\17935\32.dgn Ref. File - c:\documents of ms_jacob\17935\17935\33.dgn Ref. File - c:\documents of ms_jacob\17935\17935\34.dgn Ref. File - c:\documents of ms_jacob\17935\17935\35.dgn Ref. File - c:\documents of ms_jacob\17935\17935\36.dgn Ref. File - c:\documents of ms_jacob\17935\17935\37.dgn Ref. File - c:\documents of ms_jacob\17935\17935\38.dgn Ref. File - c:\documents of ms_jacob\17935\17935\39.dgn Ref. File - c:\documents of ms_jacob\17935\17935\40.dgn Ref. File - c:\documents of ms_jacob\17935\17935\41.dgn Ref. File - c:\documents of ms_jacob\17935\17935\42.dgn Ref. File - c:\documents of ms_jacob\17935\17935\43.dgn Ref. File - c:\documents of ms_jacob\17935\17935\44.dgn Ref. File - c:\documents of ms_jacob\17935\17935\45.dgn Ref. File - c:\documents of ms_jacob\17935\17935\46.dgn Ref. File - c:\documents of ms_jacob\17935\17935\47.dgn Ref. File - c:\documents of ms_jacob\17935\17935\48.dgn Ref. File - c:\documents of ms_jacob\17935\17935\49.dgn Ref. File - c:\documents of ms_jacob\17935\17935\50.dgn Ref. File - c:\documents of ms_jacob\17935\17935\51.dgn Ref. File - c:\documents of ms_jacob\17935\17935\52.dgn Ref. File - c:\documents of ms_jacob\17935\17935\53.dgn Ref. File - c:\documents of ms_jacob\17935\17935\54.dgn Ref. File - c:\documents of ms_jacob\17935\17935\55.dgn Ref. File - c:\documents of ms_jacob\17935\17935\56.dgn Ref. File - c:\documents of ms_jacob\17935\17935\57.dgn Ref. File - c:\documents of ms_jacob\17935\17935\58.dgn Ref. File - c:\documents of ms_jacob\17935\17935\59.dgn Ref. File - c:\documents of ms_jacob\17935\17935\60.dgn Ref. File - c:\documents of ms_jacob\17935\17935\61.dgn Ref. File - c:\documents of ms_jacob\17935\17935\62.dgn Ref. File - c:\documents of ms_jacob\17935\17935\63.dgn Ref. File - c:\documents of ms_jacob\17935\17935\64.dgn Ref. File - c:\documents of ms_jacob\17935\17935\65.dgn Ref. File - c:\documents of ms_jacob\17935\17935\66.dgn Ref. File - c:\documents of ms_jacob\17935\17935\67.dgn Ref. File - c:\documents of ms_jacob\17935\17935\68.dgn Ref. File - c:\documents of ms_jacob\17935\17935\69.dgn Ref. File - c:\documents of ms_jacob\17935\17935\70.dgn Ref. File - c:\documents of ms_jacob\17935\17935\71.dgn Ref. File - c:\documents of ms_jacob\17935\17935\72.dgn Ref. File - c:\documents of ms_jacob\17935\17935\73.dgn Ref. File - c:\documents of ms_jacob\17935\17935\74.dgn Ref. File - c:\documents of ms_jacob\17935\17935\75.dgn Ref. File - c:\documents of ms_jacob\17935\17935\76.dgn Ref. File - c:\documents of ms_jacob\17935\17935\77.dgn Ref. File - c:\documents of ms_jacob\17935\17935\78.dgn Ref. File - c:\documents of ms_jacob\17935\17935\79.dgn Ref. File - c:\documents of ms_jacob\17935\17935\80.dgn Ref. File - c:\documents of ms_jacob\17935\17935\81.dgn Ref. File - c:\documents of ms_jacob\17935\17935\82.dgn Ref. File - c:\documents of ms_jacob\17935\17935\83.dgn Ref. File - c:\documents of ms_jacob\17935\17935\84.dgn Ref. File - c:\documents of ms_jacob\17935\17935\85.dgn Ref. File - c:\documents of ms_jacob\17935\17935\86.dgn Ref. File - c:\documents of ms_jacob\17935\17935\87.dgn Ref. File - c:\documents of ms_jacob\17935\17935\88.dgn Ref. File - c:\documents of ms_jacob\17935\17935\89.dgn Ref. File - c:\documents of ms_jacob\17935\17935\90.dgn Ref. File - c:\documents of ms_jacob\17935\17935\91.dgn Ref. File - c:\documents of ms_jacob\17935\17935\92.dgn Ref. File - c:\documents of ms_jacob\17935\17935\93.dgn Ref. File - c:\documents of ms_jacob\17935\17935\94.dgn Ref. File - c:\documents of ms_jacob\17935\17935\95.dgn Ref. File - c:\documents of ms_jacob\17935\17935\96.dgn Ref. File - c:\documents of ms_jacob\17935\17935\97.dgn Ref. File - c:\documents of ms_jacob\17935\17935\98.dgn Ref. File - c:\documents of ms_jacob\17935\17935\99.dgn Ref. File - c:\documents of ms_jacob\17935\17935\100.dgn

DESIGN FEATURES RELATING TO CONSTRUCTION OR TO REGULATION AND CONTROL OF TRAFFIC MAY BE SUBJECT TO CHANGE AS DEEMED NECESSARY BY THE DEPARTMENT

REVISED	TOWNSHIP	STATE	FEDERAL AID PROJECT	ROUTE	STATE PROJECT	SHEET NO
09/18/01 10/17/01	3	VA		782	0782-099-188.C-501	

HAMPTON ROADS DISTRICT DESIGN UNIT

MATCHLINE STA. 30+60.000 SHEET 4

2/9/02 091606

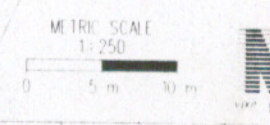
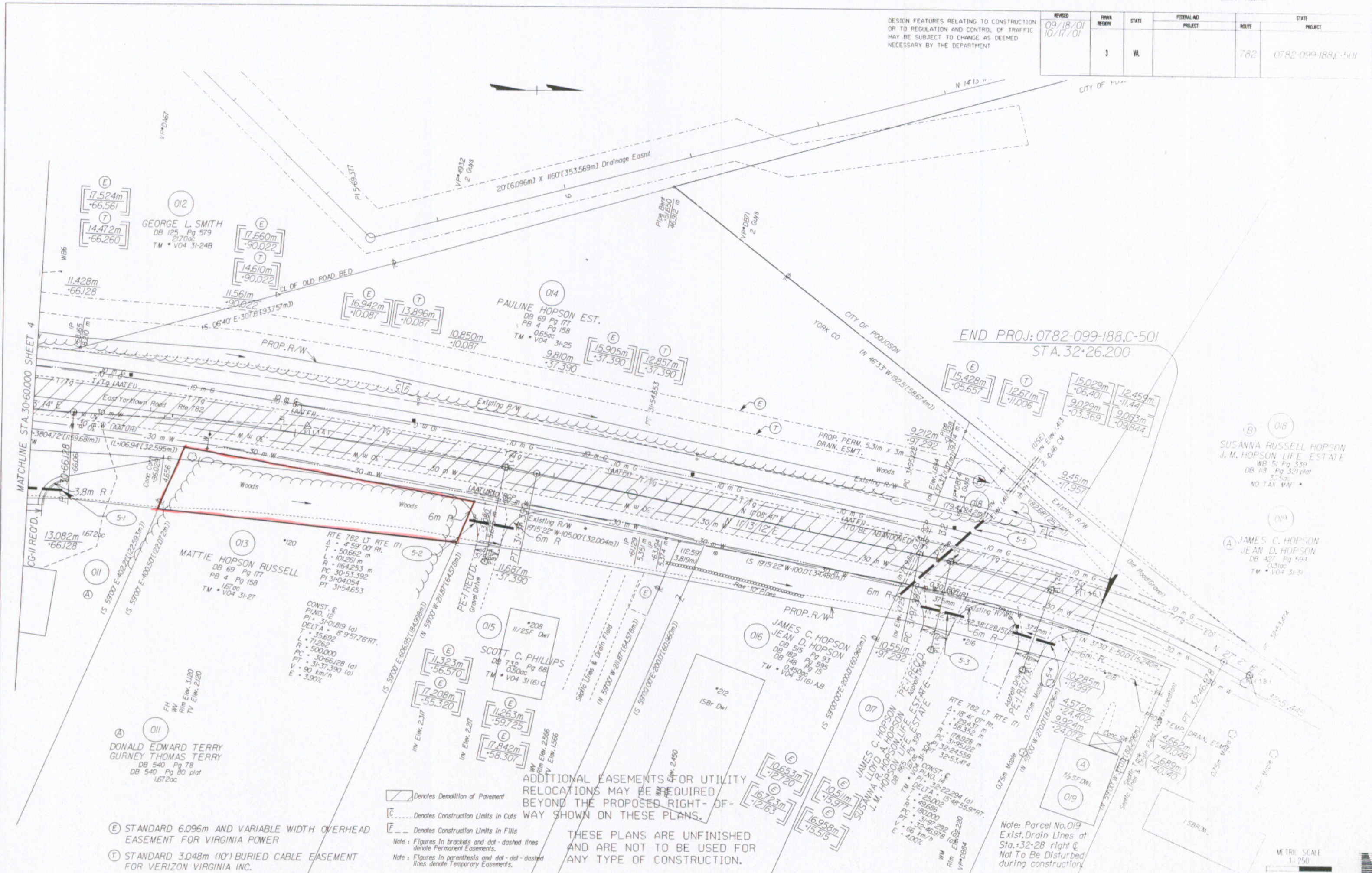

PLAN NO.	PROJECT	FEJ NO.	SHEET NO.
A	0782-099-188		4