

Design File - c:\documents of ms\_jacov...  
Design Date - 1/17/01

Ref. File - c:\documents of ms\_jacov...  
Design Date - 1/17/01

Ref. File - c:\documents of ms\_jacov...  
Design Date - 1/17/01

Ref. File - c:\documents of ms\_jacov...  
Design Date - 1/17/01

Ref. File - c:\documents of ms\_jacov...  
Design Date - 1/17/01

Ref. File - c:\documents of ms\_jacov...  
Design Date - 1/17/01

Ref. File - c:\documents of ms\_jacov...  
Design Date - 1/17/01

Ref. File - c:\documents of ms\_jacov...  
Design Date - 1/17/01

Ref. File - c:\documents of ms\_jacov...  
Design Date - 1/17/01

Ref. File - c:\documents of ms\_jacov...  
Design Date - 1/17/01

DESIGN FEATURES RELATING TO CONSTRUCTION OR TO REGULATION AND CONTROL OF TRAFFIC MAY BE SUBJECT TO CHANGE AS DEEMED NECESSARY BY THE DEPARTMENT

REVISED	FWA REGION	STATE	FEDERAL AID PROJECT	ROUTE	STATE PROJECT
09/18/01 10/17/01	1	VA		782	100-100-100-100

HAMPTON ROADS DISTRICT DESIGN UNIT

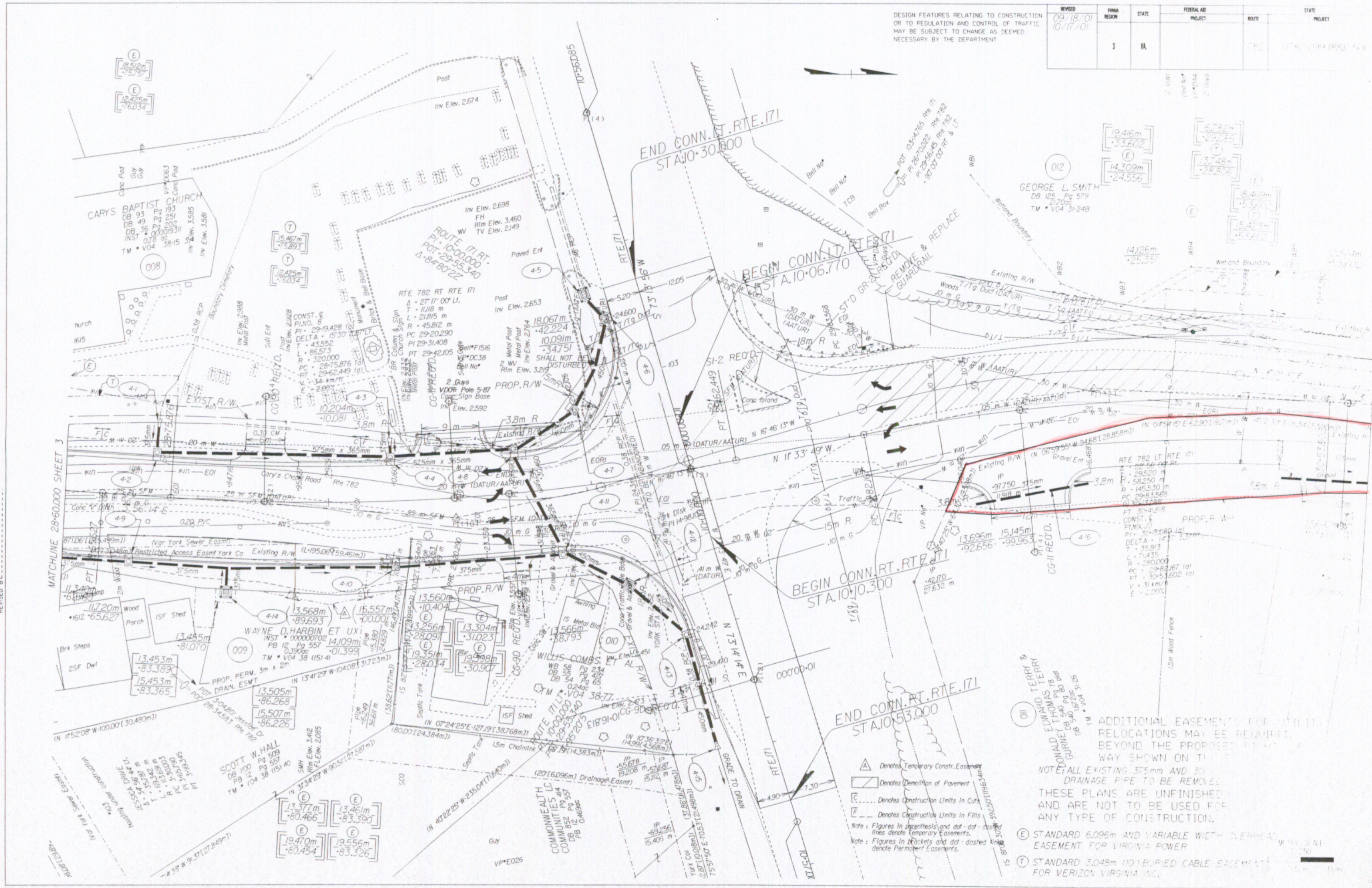

SURVEYED BY - B.G. HARMON, 12/25/97  
SUPERVISED BY - K.E. BATTEN, 1/10/98  
DESIGNED BY - K.E. BATTEN, 1/10/98  
CADD OPERATOR - JACOB JACOVICH, 1/17/01  
REVIEWED BY -

NOTE: ALL EXISTING 375mm AND 300mm DRAINAGE PIPE TO BE REMOVED. THESE PLANS ARE UNFINISHED AND ARE NOT TO BE USED FOR ANY TYPE OF CONSTRUCTION.

NOTE: FIGURES IN PARENTHESES AND DOT-DASHED LINES DENOTE TEMPORARY EASEMENTS. FIGURES IN BRACKETS AND DOT-DASHED LINES DENOTE PERMANENT EASEMENTS.

△ Denotes Temporary Constr. Easement  
 ▨ Denotes Demolition of Pavement  
 - - - Denotes Construction Limits in Cut  
 - - - Denotes Construction Limits in Fills

① STANDARD 6.096m AND VARIABLE WIDTH OVERHEAD EASEMENT FOR VIRGINIA POWER  
 ② STANDARD 3.048m (10') BURIED CABLE EASEMENT FOR VERIZON VIRGINIA INC.

2/12/02 10:44

