



NOW OR FORMERLY  
TILLEY  
INST. # 00001815 JUN 13 02  
TM # 29-00-00-143

N6°48'00"E 159.00'



349.55'  
TM# 29-00-00-149  
GPIN# 504a-1797-2875  
33,544 SQ. FT.

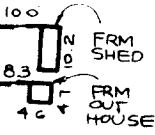

201.55'  
S88°15'00"E

NOW OR FORMERLY  
RICHMOND ESTATE  
TM # 29-00-00-146A  
DB 135 \ PG 132

NOW OR FORMERLY  
DILLARD  
TM # 29-00-00-149 A  
DB 194 \ PG 732

N88°15'00"W 146.00'  
S6°48'00"W 148.00'

NOW OR FORMERLY  
WILKERSON  
TM# 29-00-00-149B  
INST. # 000010202

S88°15'00"E 148.00'

THE PROPERTY AS DEPICTED ON THIS PLAT  
DOES NOT VIOLATE THE PROVISIONS OF THE  
YORK COUNTY SUBDIVISION ORDINANCE  
SIGNED: *Al Maddalena*  
TITLE: Chief of Development & Compliance  
DATE: 6/12/02

1289' ± TO  
DARBY ROAD

S6°48'00"W 11.00'  
(ROUTE 653)  
FIRBY ROAD  
(30' R/W)

NOTE : PROPERTY SHOWN HEREON IS LOCATED  
IN ZONE X AS SHOWN ON FLOOD  
INSURANCE RATE MAP COMMUNITY-  
PANEL NUMBER 510182 0039B  
EFFECTIVE DATE : DEC. 16, 1988

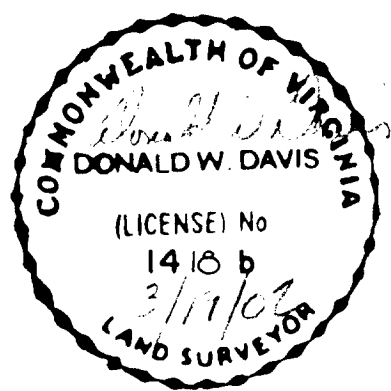

Filed in the Clerk's Office, Circuit Court, York Co., VA  
the 13 day of June, 2002  
Teste: Lynn S. Jenkins, Clerk 12:32 pm  
by *Natalie C. Owen D.C.*

- SYMBOLS:
- PIPE FOUND
  - PIPE SET
  - ROD FOUND
  - CONC. MONUMENT

I, *Donald W. Davis*  
HEREBY CERTIFY THAT THE  
SURVEY REPRESENTED BY THIS  
PLAT WAS MADE BY ME ON  
THIS DATE AND IS CORRECT  
TO THE BEST OF MY KNOW-  
LEDGE AND BELIEF THERE ARE  
NO ENCROACHMENTS OF BUILD-  
INGS UNLESS SHOWN HEREON.  
DAVIS & ASSOCIATES  
SURVEYORS & PLANNERS  
YORK COUNTY, VIRGINIA

JOB LOCATION # 307 FIRBY ROAD  
PLAT OF THE PROPERTY OF:  
**EARNEST H. & ALICE B. WILKERSON**  
PARCEL OF LAND  
CONTAINING: 33,544 SQ. FT.  
COUNTY OF YORK, VIRGINIA  
INST. # 02 000 2878