

N/F  
 STEPHEN R. MUNDAY et ux  
 T.M. 2F-8-8-148  
 206 WICHITA LANE  
 GPIN# D20C-1806-2174  
 D.B.492 PG.157  
 SKIMINO HILLS,  
 SECTION EIGHT, LOT 148  
 EXISTING 40'  
 DRAINAGE AND  
 UTILITY  
 EASEMENT

PG 0558 SEP 21 04  
 N/E  
 CAROL E. SPAETZ  
 T.M. 2F-8-8-149  
 208 WICHITA LANE  
 GPIN# D20C-1886-2098  
 D.B.571 PG.567  
 SKIMINO HILLS,  
 SECTION EIGHT, LOT 149

N/F ARLAND D. VANNATTA ET  
 UX T.M. 2F-8-8-150  
 210 WICHITA LANE  
 GPIN# D20C-1996-1948  
 D.B.462 PG.164  
 SKIMINO HILLS,  
 SECTION EIGHT, LOT 150

EXISTING 20'  
 DRAINAGE AND  
 UTILITY EASEMENT

N22°07'04"E  
 27.31'  
 L1  
 L2  
 35.16'  
 S22°07'04"W  
 20.00'  
 N67°52'56"W

**PROPOSED 20' PERMANENT  
 UTILITY EASEMENT HEREBY  
 CONVEYED TO YORK COUNTY  
 (605 SQ. FT.)**

N/F  
 CHARLES C. CRANE, JR ET UX  
 T.M. 2F-7-7-131  
 117 NINA CIRCLE  
 GPIN#D20C-1415-2233  
 D.B.902 PG.608  
 SKIMINO HILLS,  
 SECTION SEVEN, LOT 131

N/F JOHN D. TAYLOR  
 T.M. 2F-6-6-52  
 123 CHAPEL HILL LANE  
 GPIN# D20C-1717-1828  
 INST.#020016014  
 SKIMINO HILLS,  
 SECTION SIX, LOT 52

L1 S70°43'32"E  
 5.64'

L2 N84°19'54"E  
 16.24'

N25°51'32"E  
 194.45'  
 (SURVEY TIE LINE)

N/F G. ETHAN REYNOLDS  
 T.M. 2F-6-6-51  
 121 CHAPEL HILL LANE  
 GPIN#D20C-1506-1848  
 INSTR.#030000203  
 SKIMINO HILLS,  
 SECTION SIX, LOT 51

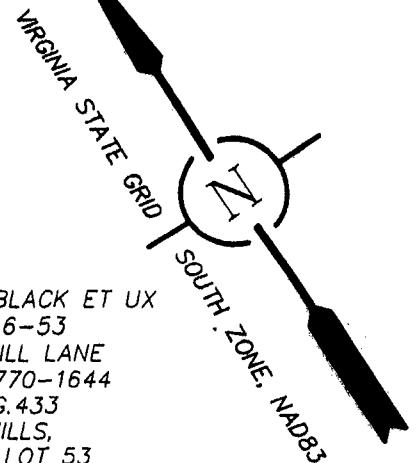

N/F ROBERT E.L. BLACK ET UX  
 T.M. 2F-6-6-53  
 120 CHAPEL HILL LANE  
 GPIN# D20C-1770-1644  
 D.B.523 PG.433  
 SKIMINO HILLS,  
 SECTION SIX, LOT 53

**YORK COUNTY  
 APPROVED FOR RECORDATION**  
 BY: *J.B. [Signature]*  
 TITLE: *Right of Way Agent*  
 DATE: *9-21-04*

CHAPEL HILL LANE  
 50' R/W

**NOTE:**

- 1) THIS PLAT WAS MADE WITHOUT THE BENEFIT OF A TITLE REPORT.
- 2) PARCEL LINES ARE COMPILED FROM RECORD DOCUMENTS AND PHYSICAL EVIDENCE AS FOUND.
- 3) THIS PLAT DOES NOT REPRESENT A FIELD BOUNDARY SURVEY.

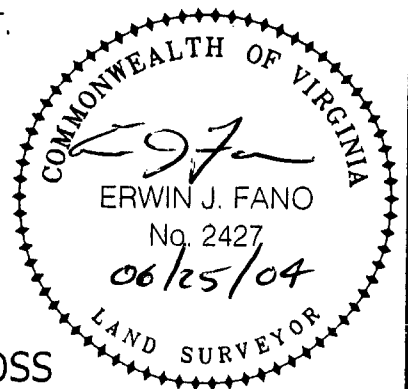

**COMPILED PLAT SHOWING  
 A PROPOSED 20' PERMANENT UTILITY EASEMENT ACROSS  
 THE PROPERTY OF JOHN D. TAYLOR**

SKIMINO HILLS, SECTION SIX, LOT 52  
 BRUTON MAGISTERIAL DISTRICT, YORK COUNTY, VIRGINIA



**Draper Aden Associates**

Engineering • Surveying • Environmental Services

8050 Villa Park Drive  
 Richmond, VA 23228  
 804-264-2228 Fax: 804-264-8773

Blacksburg, VA  
 Charlottesville, VA  
 Hampton Roads, VA  
 Raleigh-Durham, NC

DRAWN	BJU	SCALE	1"=50'
CHECKED		DATE	6-25-04

**PLAN NO. R02559-09-123 CHAPEL HILL**