

SUFFOLK DISTRICT DESIGN UNIT

DESIGN FEATURES RELATING TO CONSTRUCTION OR TO REGULATION AND CONTROL OF TRAFFIC MAY BE SUBJECT TO CHANGE AS DEEMED NECESSARY BY THE DEPARTMENT

REVISED	FINA REGION	STATE	FEDERAL AID PROJECT	ROUTE	STATE PROJECT	SHEET NO.
4/30/97 7/08/97 8/25/97 8/28/97	3	VA.		0603	0603-099-171, C-501	8

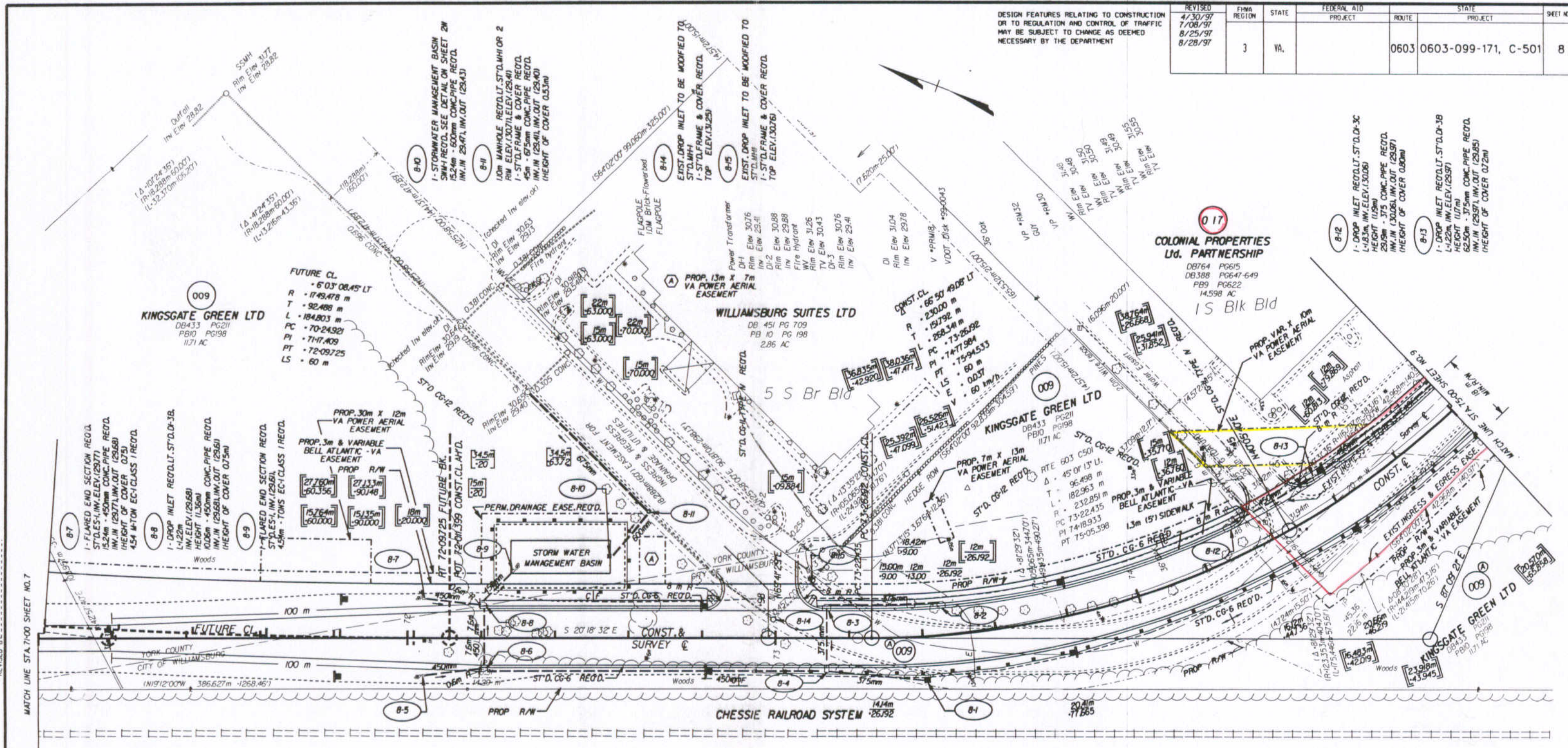

SURVEYED BY: R. O. HARMON  
 SUPERVISED BY: E. N. HOLLOWELL  
 DESIGNED BY: R. T. SCOTT, JR.  
 CAD OPERATOR: [Name]  
 REVISED BY: [Name]

MATCH LINE STA. 71+00 SHEET NO. 7

5714-00

- 8-1 1-DROP INLET RECD.LT. STD.D-3B  
 L-1.83m INV.ELEV.(129.77)  
 HEIGHT (1.22m)  
 INV.IN (130.31) INV.OUT (130.04)  
 (HEIGHT OF COVER 0.90m)
- 8-2 1-DROP INLET RECD.LT. STD.D-3C  
 L-1.83m INV.ELEV.(130.6)  
 HEIGHT (1.22m)  
 INV.IN (130.61) INV.OUT (130.4)  
 (HEIGHT OF COVER 0.79m)
- 8-3 1-DROP INLET RECD.LT. STD.D-3C  
 L-1.83m INV.ELEV.(130.0)  
 HEIGHT (1.22m)  
 INV.IN (130.31) INV.OUT (130.04)  
 (HEIGHT OF COVER 0.90m)
- 8-4 1-DROP INLET RECD.LT. STD.D-3A  
 INV.ELEV.(129.56)  
 HEIGHT (1.59m)  
 INV.IN (130.01) INV.OUT (129.77)  
 (HEIGHT OF COVER 0.91m)
- 8-5 1-FLARED END SECTION RECD.  
 STD.D-5L INV.ELEV.(129.61)  
 L-1.22m - 450mm CONC.PIP RECD.  
 INV.IN (129.71) INV.OUT (130.04)  
 (HEIGHT OF COVER 0.75m)
- 8-6 1-DROP INLET RECD.LT. STD.D-3B  
 L-1.22m INV.ELEV.(129.77)  
 HEIGHT (1.22m)  
 INV.IN (129.71) INV.OUT (129.68)  
 (HEIGHT OF COVER 0.75m)

C Denotes Construction Limits In Cuts  
 F Denotes Construction Limits In Fills  
 DENOTES ROCK CHECK DAM

FIGURES IN BRACKETS AND DOT - DASHED LINES DENOTE PERMANENT EASEMENTS.

