

DESIGN FEATURES RELATING TO CONSTRUCTION OR TO REGULATION AND CONTROL OF TRAFFIC MAY BE SUBJECT TO CHANGE AS DEEMED NECESSARY BY THE DEPARTMENT.

REVISED	FEMA REGION	STATE	FEDERAL AID PROJECT	ROUTE	STATE PROJECT	SHEET NO.
12-02-96						
12-20-96						
01-24-97						
03-26-97						
04-28-97						
08-27-97						
09-09-97						
	3	VA		603	0603-099-127, M-501	4

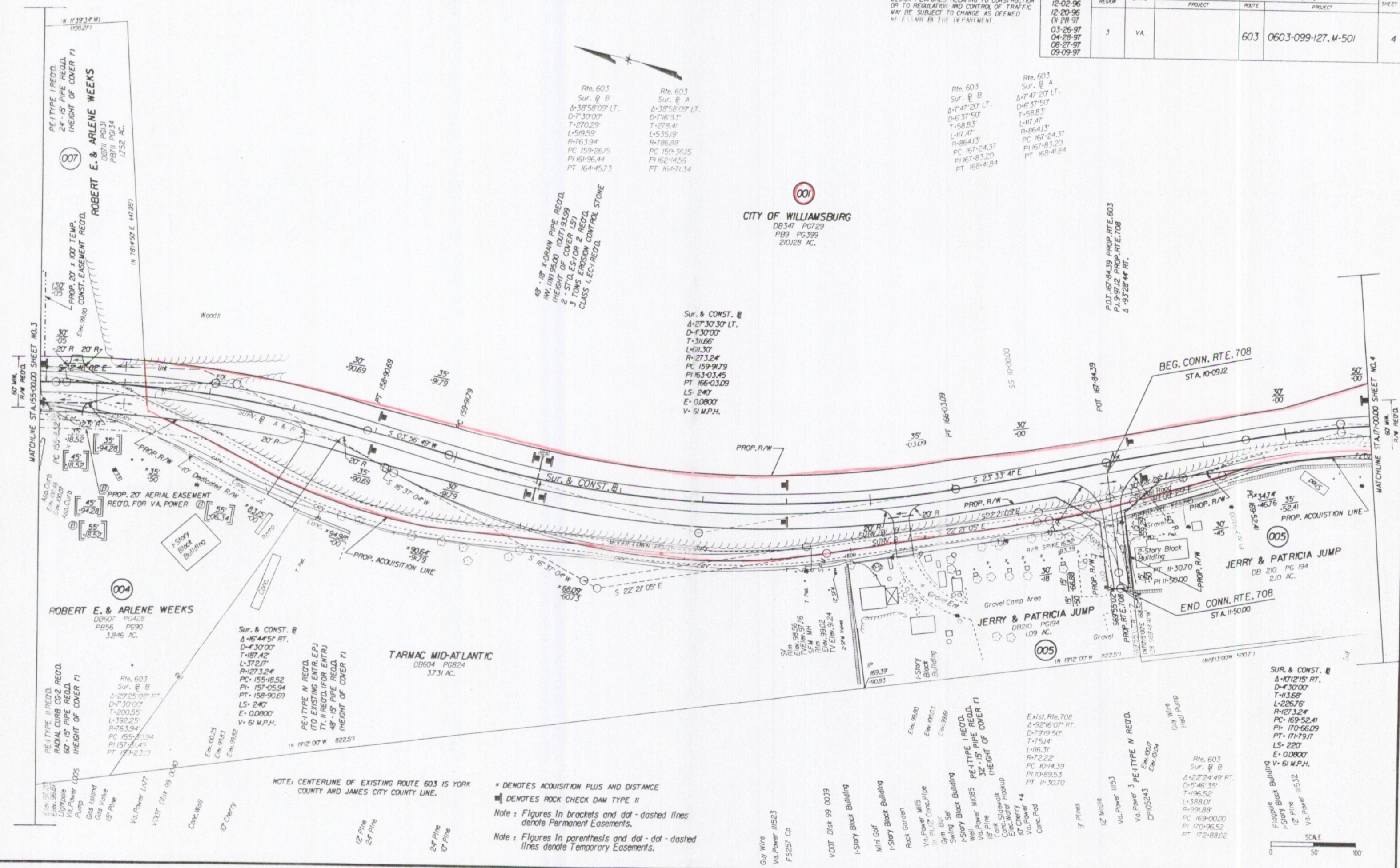

SUPERVISED BY: E. M. HOLLOWELL
DESIGNED BY: D. B. WINSLOW
CADD OPERATOR: J. H. WILSON
REVISED BY:

NO.	DATE	DESCRIPTION
1		
2		
3		
4		
5		
6		
7		
8		
9		
10		

NOTE: CENTERLINE OF EXISTING ROUTE 603 IS YORK COUNTY AND JAMES CITY COUNTY LINE.

* DENOTES ACQUISITION PLUS AND DISTANCE
 ■ DENOTES ROCK CHECK DAM TYPE II
 Note: Figures in brackets and dot-dashed lines denote Permanent Easements.
 Note: Figures in parenthesis and dot-dot-dashed lines denote Temporary Easements.

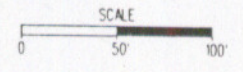

PLAN NO.	PROJECT	FILE NO.	SHEET NO.
A	0603-099-127		4