

REVISED	FINA REGION	STATE	FEDERAL AID PROJECT	ROUTE	STATE PROJECT	SHEET NO.
84/10/96 18/28/96	3	VA		64	0064-099-106, RW-201 C-501, B-620	9

90

Gannett Fleming
 ENGINEERS AND PLANNERS

POWER POLES PROPERTY OF VIRGINIA POWER
 P.D. BOX 329, NORFOLK, VA 23502

WATER LINES PROPERTY OF CITY OF NEWPORT NEWS,
 DEPARTMENT OF PUBLIC UTILITIES, 600 WARWICK BLVD.,
 NEWPORT NEWS, VA 23605

GAS LINES PROPERTY OF VIRGINIA NATURAL GAS COMPANY
 500 EAST VIRGINIA BEACH BLVD., NORFOLK, VA 23502

P.C. STA. 235+42.87 RAMP D
 P.T. STA. 1216+57.52
 ROUTE 64 W.B.L. 70' LT.

UNITED STATES NAVAL
 WINE DEPOT
 P.B. 1 Pg. 06
 137435 Ac.
 MEET EXISTING R/W
 & LIMITED ACCESS
 PROPOSED R/W
 & LIMITED ACCESS

BEGIN BRIDGE & BRGS
 Sta. 289+62.80
 RAMP D&E

END BRIDGE & BRGS
 Sta. 296+47.20 RAMP D&E

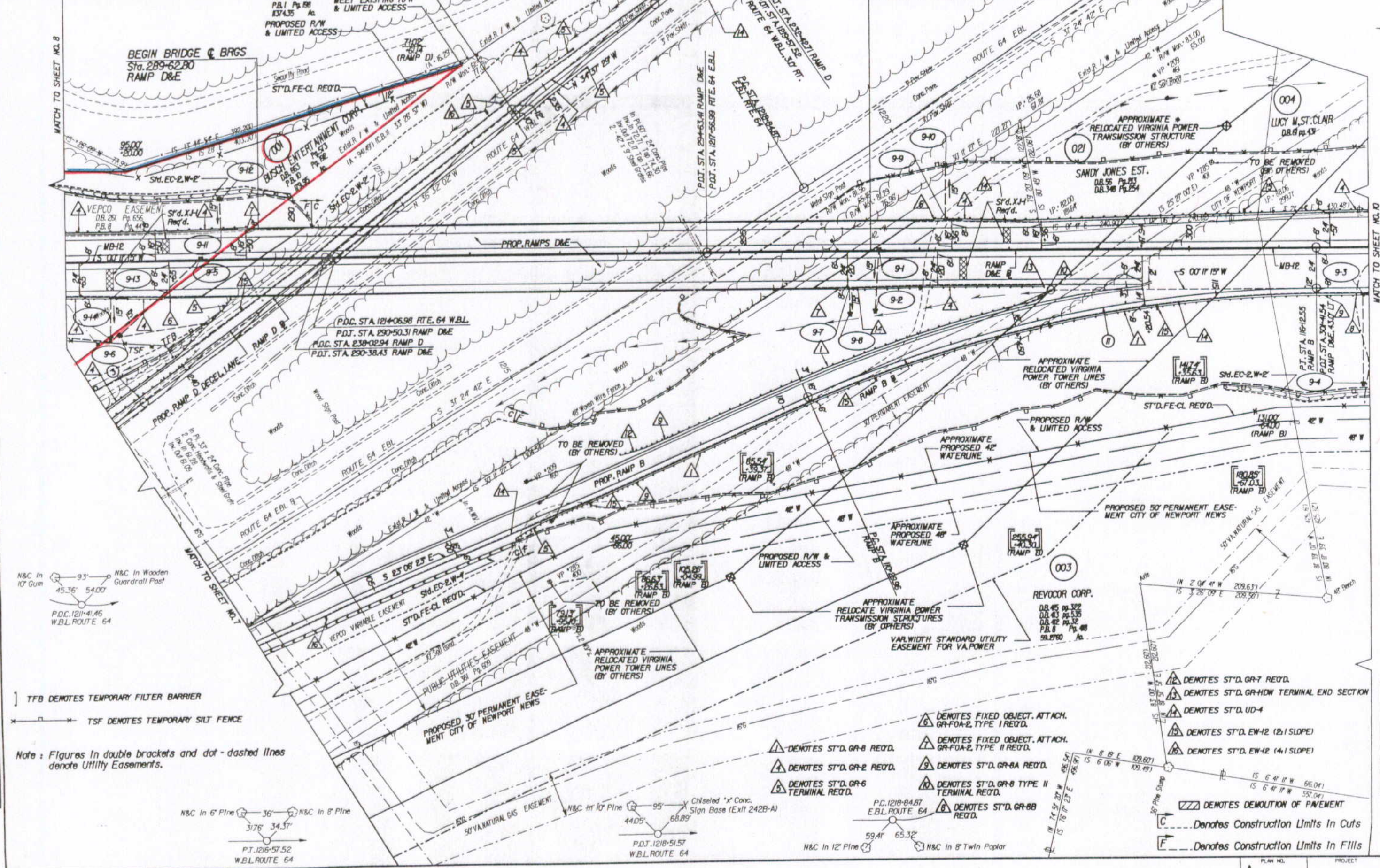

③ RAMP D
 Δ = 3° 15' 08.68" RT.
 D = 0' 15' 0"
 T = 649.98'
 L = 1299.60'
 R = 22,894.32'
 PC = 235+42.87
 PT = 248+92.85
 PI = 248+42.48
 E = 0.0208
 V = 70MPH

E.B.L. ROUTE 64
 Δ = 15° 00' 52" LT.
 D = 0' 29' 57"
 T = 1512.28'
 L = 3007.23'
 R = 11,476.16'
 PC = 1218+84.87
 PI = 1233+97.15
 PCC = 1248+92.10

W.B.L. ROUTE 64
 Δ = 5° 07' 20" LT.
 D = 0' 15' 0"
 T = 1024.37'
 L = 2047.37'
 R = 22,901.32'
 PC = 113+25.34
 PI = 1206+34.52
 PT = 1216+57.52

② RAMP B
 Δ = 2° 37' 38.82" RT.
 D = 3' 59' 5"
 T = 295.38'
 L = 582.59'
 R = 1433.00'
 PC = 180+29.96
 PI = 113+25.34
 PT = 1612.55
 E = 0.0468
 V = 40MPH

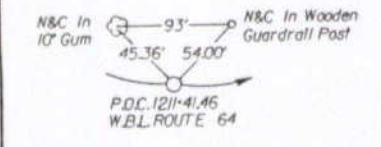

TFB DENOTES TEMPORARY FILTER BARRIER
 TSF DENOTES TEMPORARY SILT FENCE

Note: Figures in double brackets and dot-dashed lines denote Utility Easements.

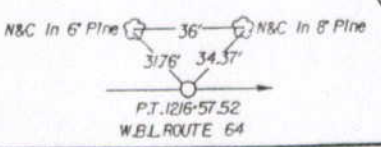

- △ DENOTES ST'D. GR-8 RECD.
- △ DENOTES ST'D. GR-2 RECD.
- △ DENOTES ST'D. GR-6 TERMINAL RECD.
- △ DENOTES FIXED OBJECT, ATTACH. GR-FOA-2, TYPE I RECD.
- △ DENOTES FIXED OBJECT, ATTACH. GR-FOA-2, TYPE II RECD.
- △ DENOTES ST'D. GR-8A RECD.
- △ DENOTES ST'D. GR-8 TYPE II TERMINAL RECD.
- △ DENOTES ST'D. GR-8B RECD.
- △ DENOTES ST'D. GR-8B RECD.

- △ DENOTES ST'D. GR-7 RECD.
- △ DENOTES ST'D. GR-HW TERMINAL END SECTION
- △ DENOTES ST'D. UD-4
- △ DENOTES ST'D. EW-12 (2:1 SLOPE)
- △ DENOTES ST'D. EW-12 (4:1 SLOPE)
- DENOTES DEMOLITION OF PAVEMENT
- C --- Denotes Construction Limits In Cuts
- F --- Denotes Construction Limits In Fills

INDEX

ALIGNMENT 1E-1F
PROFILES 1
RAMP D&E 8A, 9A
RAMP B 7B, 9B
RAMP D 7A
DRAINAGE DESCRIPTIONS 8B, 12G

