

REVISED	FHWA REGION	STATE	FEDERAL AID PROJECT	ROUTE	STATE PROJECT	SHEET NO.
11/18/96 10/28/96	3	VA.		64	0064-099-106, RW-201 C-501, B-620	9

POWER POLES PROPERTY OF VIRGINIA POWER
P.O. BOX 329, NORFOLK, VA. 23502

WATER LINES PROPERTY OF CITY OF NEWPORT NEWS,
DEPARTMENT OF PUBLIC UTILITIES, 600 WARWICK BLVD.,
NEWPORT NEWS, VA. 23605

GAS LINES PROPERTY OF VIRGINIA NATURAL GAS COMPANY
500 EAST VIRGINIA BEACH BLVD., NORFOLK, VA. 23502

P.C. STA. 235+42.81 RAMP D
P.T. STA. 1216+51.52
ROUTE 64 W.B.L. TO LT.

UNITED STATES NAVAL
MINE DEPOT
P.B.1 Pg. 88
E37435 Ac.
MEET EXISTING R/W
& LIMITED ACCESS
PROPOSED R/W
& LIMITED ACCESS

DESIGN FEATURES RELATING TO CONSTRUCTION
OR TO REGULATION AND CONTROL OF TRAFFIC
MAY BE SUBJECT TO CHANGE AS DEEMED
NECESSARY BY THE DEPARTMENT

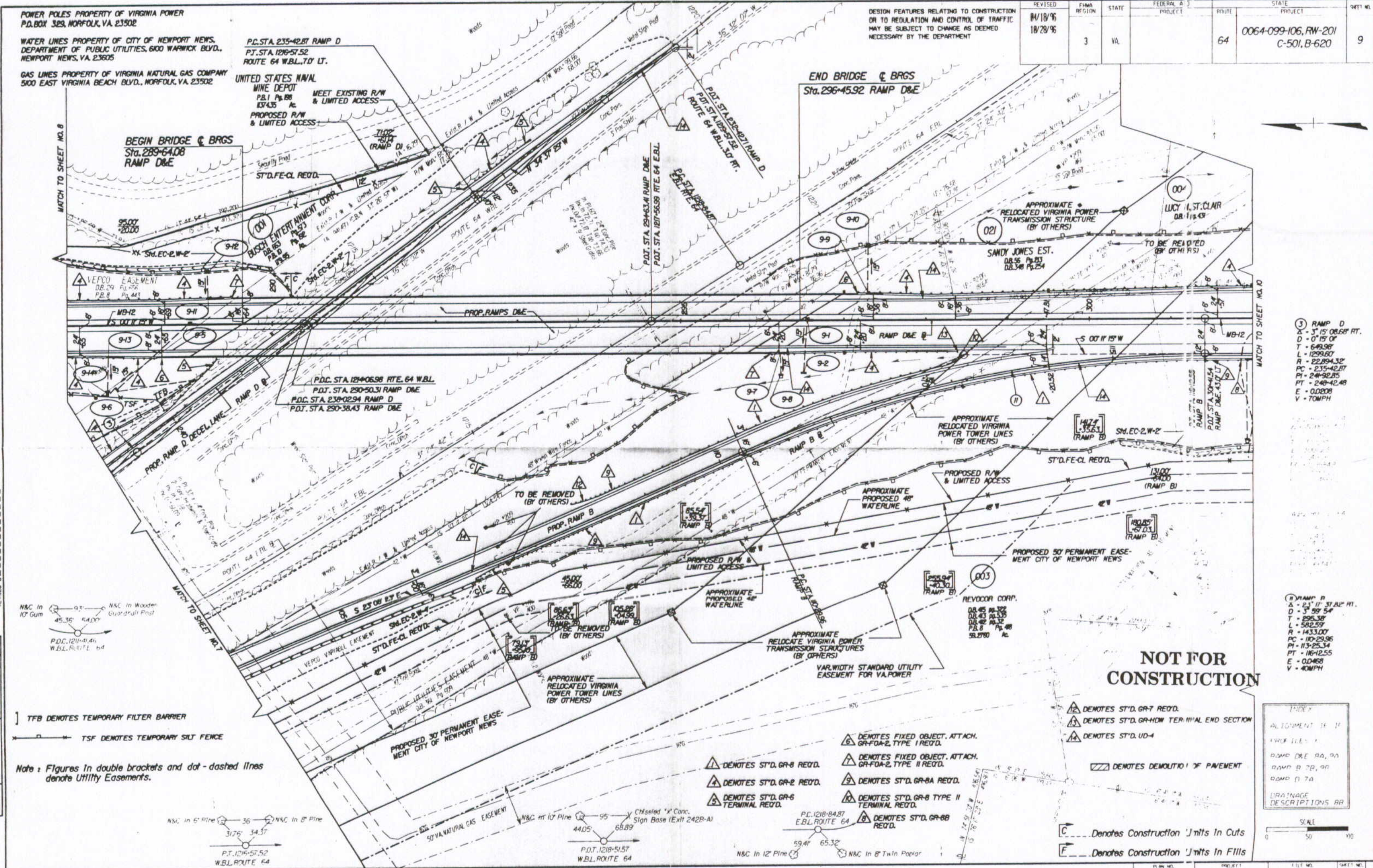

Gannett & Co. Inc. ENGINEERS AND ARCHITECTS



SUPERVISED BY: [Signature]
DESIGNED BY: [Signature]
CAD OPERATOR: [Signature]
REVISED BY: [Signature]

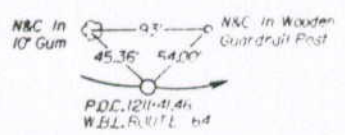

TFB DENOTES TEMPORARY FILTER BARRIER
TSF DENOTES TEMPORARY SILT FENCE

Note: Figures in double brackets and dot-dashed lines denote Utility Easements.

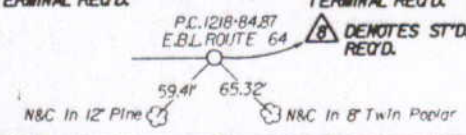
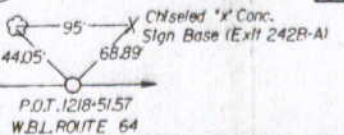
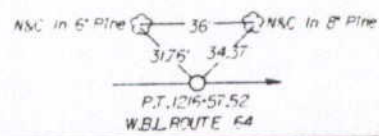

(3) RAMP D
A - 3' 15" 08.68' FT.
D - 0' 15" 01'
T - 649.98'
L - 1299.60'
R - 22,894.32'
PC - 235+42.81
PI - 240+92.85
PT - 240+42.48
E - 0.0208
V - 70MPH

(4) RAMP B
A - 2' 11" 31.82' FT.
D - 3' 59' 54"
T - 295.38'
L - 583.59'
R - 1433.00'
PC - 110+29.96
PI - 113+25.54
PT - 116+12.55
E - 0.0468
V - 40MPH

NOT FOR CONSTRUCTION

- ▲ DENOTES ST'D. GR-8 RECD.
- ▲ DENOTES ST'D. GR-2 RECD.
- ▲ DENOTES ST'D. GR-6 TERMINAL RECD.
- ▲ DENOTES ST'D. GR-8 TYPE II TERMINAL RECD.
- ▲ DENOTES ST'D. GR-88 RECD.
- ▲ DENOTES FIXED OBJECT, ATTACH. GR-FOA-2, TYPE I RECD.
- ▲ DENOTES FIXED OBJECT, ATTACH. GR-FOA-2, TYPE II RECD.
- ▲ DENOTES ST'D. GR-8A RECD.
- ▲ DENOTES ST'D. GR-8 TYPE II TERMINAL RECD.

- ▲ DENOTES ST'D. GR-7 RECD.
- ▲ DENOTES ST'D. GR-HDM TERMINAL END SECTION
- ▲ DENOTES ST'D. UD-4

▨ DENOTES DEMOLITION OF PAVEMENT

C --- Denotes Construction Limits In Cuts
F --- Denotes Construction Limits In Fills

INDEX
ALIGNMENT 1E 1F
PROFILES 1
RAMP D&E 9A, 9B
RAMP B 7B, 9B
RAMP D 7A
DRAINAGE DESCRIPTIONS 8A

